

2019

CATALOGUE

Vol.2



AUTOMOTIVE TOOLS



DAYTON TOOLS™
www.dayton.com.tw



INDEX

AUTOMOTIVE TOOLS

A01	Body tools
A02	Brake tools
A03	Chisel / Punch
A04	Engine tools
A05	General tools
A06	Hook / Picks / Scrapers
A07	Line stopper / Hose clips / Hose pliers
A08	Grease servicing tools
A09	Magnetic pick up / Inspection mirror
A10	Oil servicing tools
A11	Pry bars
A12	Puller / Separator
A13	Testing sets
A14	Trim & Door tools
A15	Windscreen tools

NEW UPDATE

QA-1910

PARKING SENSOR AND LENS HOLE MAKER



- Hole size... 17, 18, 18.2, 19, 20, 22.5, 24, 26, 26.7, 32 mm
- Cut hole thickness < 5mm
- Includes 5/16" H.S.S. drill bit

easy to take out the gaskets!!

QA-1909

SOLDERING AND ASSEMBLY



- Offers an extra pair of hands when soldering or assembling.
- Flexible design allows work to be held in a variety of positions.
- Magnetic base attaches to any ferrous surface.
- Hex shaped base allows use in a vise when required.

QA-1912

FLEXIBLE MAGNETIC PAINT CLAMP



- Flexible type.
- Powerful magnetic base-holds up to 2.3 Kg.
- Professional and fast method for securing parts for a controlled spray painting.
- Especially for smaller parts such as mirror covers, handles, fender flares, fog light bezels and moldings.

QA-1672

MAGNETIC PAINT CLAMP



- Powerful magnetic base-holds up to 5 lbs. Can be anchored to the walls of booths even if protected with plastic film and stable metal object.
- Professional, and fast method for securing parts for a controlled spray painting.
- Especially for smaller parts such as mirror covers, handles, fender flares, fog light bezels and moldings.

MWC-760

MICRO WELDING CLAMP



- Use for automotive applications and especially effective for positioning body panels prior to welding.
- Apply to a small spaces, such as...Truck edges, Door columns, Windows edges, Hatchback.
- Adjustable thickness clamp from 0 to 7mm
- Unique design generates huge clamping force.
- 4 pcs/pack

1010405-03

BUTT WELDING CLAMP

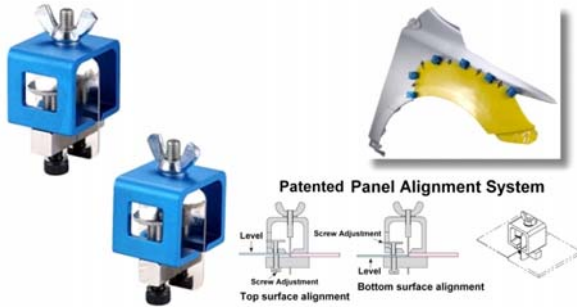

- Holds panels edge to edge with almost no gap - allowing full penetration of the weld.
- Patented level adjustment allows accurate joining of dissimilar thicknesses of materials.
- Level adjusts between 0 and 3 mm either side.
- 4 pcs/pack

QA-1061

MIGHTY MIDGET PANEL CLAMP SET



- Clamps panels in place for welding small profile allow door to be closed for alignment check before welding.
- 5 pcs/set

1010405-05

3 ANGLES WELDING CLAMP



- Securely fix panels at 60°, 90° and 120° angle.
- Secures panels with thickness up to 12.5 mm.
- Magnetic fixture allows panels to be positioned before being clamped in place.
- Unique self-centering design aids fast alignment of panels in clamp.

1010405-04

PRECISION WELDING CLAMP



- Precise alignment of work piece in " L ", " T " or " I " configuration.
- Integral bubble level ensures accuracy of alignment.
- Secures panels with thickness up to 20 mm.
- Wing bolts feature protective tips, preventing damage to surface of work piece.
- Effective, handy, easy to use.
- Material... Zinc alloy

QA-1544

ASSEMBLY GAUGE



- Each pc with 10 pcs gauge.
 - Each gauge thickness 1.0 mm.
 - Flexible suction cups & magnet for gauge fixed well, prevent to damage auto body.
 - 2 pcs per set
- Feature...
- For professional windshield installation.
 - Tool can be used as a welding gauge for car body repair.

QA-1688

GAP GAUGE TOOL



- A simple and perfect tool for correct body / interior (alignment the gaps on hoods, deck lids, doors...).
- Very useful tool, especially for bearing work and for gauging slots.
- Measuring capacity... 0.5 to 11.5mm, Graduation... 0.1mm

QA-2125

WHEEL ARCH CLAMP

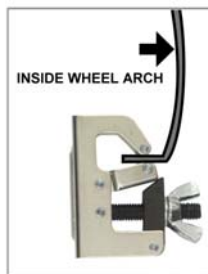

- Used to clamp hard to reach access points like a wheel arch.
- Great for use on wheel arches to apply correct pressure without damaging outer panel.
- Wing nut adjustment is easier to turn outside the wheel arch.
- The wheel arch clamp can be set up in seconds.
- 4pcs / set

950113-02

FENDER REFORMING TOOL



- Body material... Iron
- Wheel material... PU

QA-1684

FENDER FINISHER TOOL



- Fender finisher tool "rolls" the sharp inner edge of the fender to produce a rolled edge that will not interfere with the tire when suspension compresses.
- The easiest way to gently alter factory edges. Reduce wheel rub on a lowered front end.
- Great for large wheel / tire combos.
- No need to remove tire, Use in your garage or driveway.

991103-01A

STRAIGHT SEAMING PLIERS



- Made of die casted FCD-40 (ductile cast iron)
- Type...180 degree
- Total length... 275 mm
- Jaw width... 60 mm
- Suitable for metal sheet process

991103-01B SEAMING PLIERS, 45 DEGREE



- Made of die casted FCD-40 (ductile cast iron)
- Type... 45 degree
- Total length... 265 mm
- Jaw width... 60 mm
- Suitable for metal sheet process

991103-01C SEAMING PLIERS, 90 DEGREE



- Made of die casted FCD-40 (ductile cast iron)
- Type... 90 degree
- Total length... 260 mm
- Jaw width... 60 mm
- Suitable for metal sheet process

991103-01D FLANGER & PUNCH TOOL



- All steel construction with spring loaded handles.
- Crimp width... 22 mm
- Max sheet thickness up to 18 gauge (0.8 mm)
- Punch hole... 5 mm Dia.
- Crimp and punch sheet metal, aluminum, copper or ductile material.

991103-01E PUNCH TOOL



- All steel construction with spring loaded handles.
- Max sheet thickness up to 18 gauge (0.8 mm)
- Punch hole... 5 mm Dia.
- Punch sheet metal, aluminum, copper or ductile material.

991103-01F FLANGING TOOL



- All steel construction with spring loaded handles.
- Crimp width... 22 mm
- Max sheet thickness up to 18 gauge (0.8 mm)
- Crimp sheet metal, aluminum, copper or ductile material.

QA-2117

FLANGING TOOL

NEW



Item no.

Edge setting width

QA-2117

12 mm

QA-2118

17 mm

- Use for sheet metal thickness... 0.5 to 1.2mm
- For producing clean edges in sheet metal.
- Also suitable for internal and external radiuses, quick and smooth results.
- Ideal for custom-made automotive sheet metal.

QA-2119

DOOR SKIN CRIMPING TOOL

NEW



- Portable hand held crimping tool suitable for bending and crimping flanges when replacing door skins and body panels.
- Tough, replaceable nylon pads prevent damage to door skin when crimping flanges.
- Installation tool with 32mm wide pad and 50mm wide pad.

QA-2120

SHEET METAL FOLDER

NEW



- For folding of metal sheets up to 600mm width and 1.2mm thickness.
- Product is clamped to bench vice during operation.

QA-2121

SHEET METAL CUTTER

NEW



- Light weight roller type cutter suitable for straight, curved and angle cutting on mild steel metal up to 1.6mm thickness.
- Reversible ratchet action cuts sheet metal quickly and efficiently & makes angle cutting easier.
- Cutter wheels incorporate replaceable shear pins to prevent damage from overloading.
- Suitable for mounting in a bench vice.
- Replacement cutter wheels available.

QA-2122

HEAVY DUTY SHEET METAL CUTTER

NEW



- Heavy duty roller type cutter suitable for straight, curved and angle cutting mild steel sheet metal up to 3.2mm thickness.
- Suitable for mounting in a bench vice.
- Replacement cutter wheels available.

QA-1686

PDR LINE BOARD



- Great visual aid for PDR (Paintless Dent Repair), it allows you to locate your tool tip as well as see the distortion of dent on the panel.
- 240 × 200mm board with suction cup, can be positioned at any angle.
- White board with black lines for medium to dark coloured vehicles.

QA-2270

PDR LIGHT (LED)

NEW

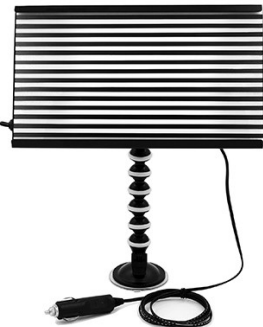

- Professional light for paintless dent removal (PDR).
- 3 lines of aluminum PCB 5050 SMD rigid LED strip (6200K)
- Black & White striped lens cover (270 × 155mm)
- Anodized aluminum shield.
- Adjustable stand with suction cup.
- 12V, 5M cord

QA-1282

AUTOMATIC WELDING SLIDE HAMMER



- Full length... 435mm
- Directly weld to denting auto body
- Connect the positive handle of welding machine into the connector.
- Pull with slide hammer without drilling a hole in the body.
- To weld and slide the hammer at the same time.

QA-1283

SLIDE HAMMER HOOK SET



- Full length... 435mm
- To pull out the washer which welding in the indentation.

QA-1284

BODY AND FENDER DENT PULLER



- Often, the biggest time- consuming part of dent removal is the removal and installation of interior panels and upholstery.
- This tool eliminates those steps. Simply drill a hole at the base of the dent and thread in the tool's self-tapping screw.
- A few sharp blows of the slide hammer will pull the dent out.

QA-1285

BODY DENT REMOVER



- Pulls dented sheet metal back into place.
- To use, drill a hole in the deepest part of the dent, insert the hook or self-threading screw tip and tap lightly with the 2 1/2lb slide hammer to remove the dent. 13" long shaft enables high pulling force.
- Slide hammer shaft has a 1/2" - 13 unc thread. Handle length... 3.75".

QA-1689

8 PCS PAINTLESS DENT REMOVAL TOOLS



- Ideal for removing small dents and damaging caused by hail, Without damaging the finish.
- Contents...
 - 2_ Half-round bars 21, 22 cm
 - 1_ Round bar 42 cm
 - 1_ Half-round pointed bar 60 cm
 - 2_ Angled ball-headed bars 46, 100 cm
 - 1_ Pointed bar 56 cm
 - 1_ Special-type hooked bar 107 cm

QA-1280

PAINTLESS DENT REPAIR KIT

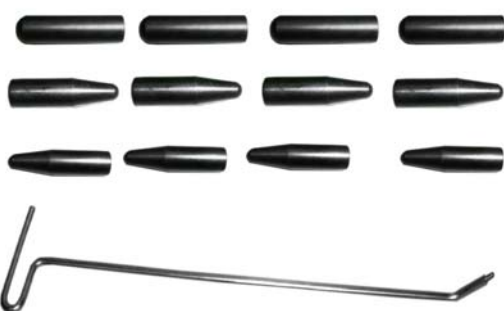

- Effectively smoothes out and repairs the dents caused by hail, stone or door dent and all sort of cosmetic damages.
- No more needing the re- painting of the car body, save Money and Time.

QA-1685

PAINTLESS DENT REMOVAL TOOLS



- The sets are universal tools for beginners as well as professional technicians.
- The large contact surface of the tips make the bars an ideal tool for easy, fast and clean repairs on open spaces.
- Three different sets are available with a combination of three different bars and and a wide selection of tips.

QA-1279

30 PCS PAINTLESS DENT REPAIR KIT

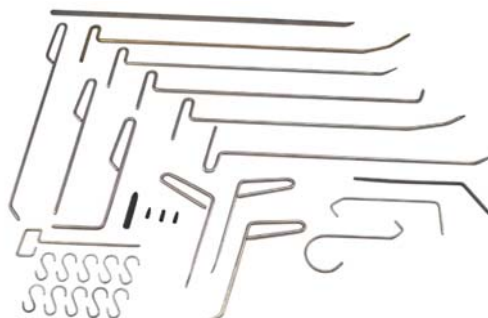

- Effectively smoothes out and repairs the dents caused by hail, stone or door dent and all sort of cosmetic damages.
- No more needing the re- painting of the car body, save Money and Time.

QA-1281

33 PCS PAINTLESS DENT REPAIR KIT

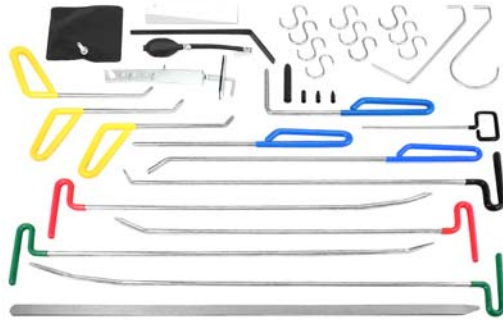

- Effectively smoothes out and repairs the dents caused by hail, stone or door dent and all sort of cosmetic damages.
- No more needing the re- painting of the car body, save Money and Time.

QA-1278

33 PCS PAINTLESS DENT REPAIR KIT

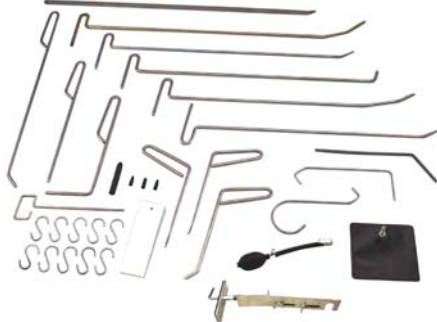

- Effectively smoothes out and repairs the dents caused by hail, stone or door dent and all sort of cosmetic damages.
- No more needing the re- painting of the car body, save Money and Time.

QA-1542

MINI LIFTER GLUE PULLER KIT



Features...

- Idea for repair the vehicle body small damage.
- Stainless steel with plastic protect for high quality & long life.
- Spring action center bolt allows for minor dent pulling operations.
- Swivel pads provide stability on nonlinear surfaces.
- With 10 pcs glue pads.

QA-1543

SLIDE HAMMER GLUE PULLER KIT

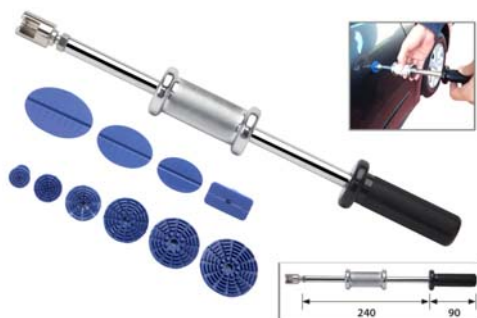

Features...

- Idea for repair the vehicle body small damage.
- Connector tip for glue pads.
- With 10 Pcs glue pads
- With 0.95lb(0.43kgs) sliding hammer.

QA-1541

PNEUMATIC DENT REMOVAL TOOL KIT



- Air inlet... 1/4"
- Operating pressure... 3 to10 bar(0.3 to 1MPa) (40 to 145Psi)
- Accessory... 10 pcs glue pads,1pc extension adapter.

Features...

- Idea for repair the vehicle body small damage.
- Designed with pressure and flow control valve for safety operation.
- Stainless steel with PVC protect.

QA-1091

2PCS INFLATABLE BAG DENT REMOVER SET



- Contents...
 - 1_ Inflatable bag... 205 × 205 mm, Hose length...1800 mm
 - 1_ Inflatable bag... 360 × 205 mm, Hose length...1800 mm
- Feature...
 - Removes dents easily by inserting the inside of door and fender panels.
 - Pushes dents out to normal shape avoiding excessive bonding and sanding work.

QA-1092

4PCS INFLATABLE BAG DENT REMOVER SET



- Contents...
 - 1_ Inflatable hand pumper
 - 3_ Inflatable bag... 180 × 38 mm, 190 × 60 mm, 160 × 160 mm
- Removes dents easily by inserting the inside of door and fender panels.
- Pushes dents out to normal shape avoiding excessive bonding and sanding work.

QA-1093

5PCS INFLATABLE BAG DENT REMOVER SET



- Contents...
 - 1_ Inflatable hand pumper
 - 4_ Inflatable bag...
 - 180 × 38 mm, 190 × 60 mm, 160 × 160 mm, 325 × 120 mm
- Removes dents easily by inserting the inside of door and fender panels.
- Pushes dents out to normal shape avoiding excessive bonding and sanding work.

QA-1094

6PCS INFLATABLE BAG DENT REMOVER SET



- Contents...
 - 1_ Inflatable hand pumper
 - 5_ Inflatable bag...
 - 180 × 38 mm, 190 × 60 mm, 160 × 160 mm, 325 × 120 mm, 420 × 140 mm
- Removes dents easily by inserting the inside of door and fender panels.
- Pushes dents out to normal shape avoiding excessive bonding and sanding work.

ATP-172

AIR DENT PULLER



- Air dent puller through sliding hammer arise the pulling force let indentation area out.
- With 3lb sliding hammer.
- With brass shut off valve.
- With 13" length inlet hose.
- With 2 pcs suction cups... Dia. 120 & 150 mm
- With air plug.
- Air exhaust from the handle.
- Air pressure... 90 psi

ASL-96017HP 7" PUMP VACUUM SUCTION CUPS



- Loading capacity... 40 kgs
- Diameter... 178 mm
- Brass Plunger
- Metal handle/pump assembly with flat pad for flat surfaces.
- Vacuum leakage indicator with suction quick release button.
- Suitable for all materials with smooth, flat, airtight surfaces such as glass, plastic, metal, coated wood and marble etc.

ASL-9601T SINGLE SUCTION CUP



- Loading capacity... 20 kgs
- Diameter... 165 mm
- Main body... Rubber
- With spherical rubber pad.
- It can also be used by car body repairer to raise small dents, and can be also of great use to glaziers.

ASL-125SL 5" PUMP VACUUM SUCTION CUPS



- Loading capacity... 20 kgs
- Diameter... 125 mm
- Brass and Plastic handle/pump assembly with concave pad for curved surfaces.
- Vacuum leakage indicator with suction quick release button.
- Suitable for all materials with smooth, flat, airtight surfaces such as glass, plastic, metal, coated wood and marble etc...

ASL-2075L 75 MM VACUUM CUP



- Loading capacity... 10 kgs
- Diameter... 75mm
- Main body... Plastic
- With spherical rubber pad
- For tile or backsplash handling
- Small diameter vacuum cup

ASL-9803 TRIPLE SUCTION CUPS (NICKEL PLATED)



- Loading capacity... 100 kgs
- Diameter... 123 mm
- Aluminum body.
- Triple pad.
- A triangular formation of three pads with a common handle.

ASL-9803P

TRIPLE SUCTION CUPS WITH FIX HEADS



- Loading capacity... 70 kgs
- Diameter... 117 mm
- Main body... ABS
- Triple pad
- A triangular formation of three pads with a common handle.

ASL-9602A

SUCTION LIFTER



- Loading capacity... 35 kgs
- Diameter... 117 mm
- Main body... Aluminum
- Adjustable dual grip
- Lightweight double cup lifter has a swivel action design enabling its use on curved glass, popular with the windscreens industry, dented panels or any other smooth surfaced materials.

ASL-9602

DOUBLE SUCTION CUPS



- Loading capacity... 50 kgs
- Diameter... 117 mm
- All aluminum body with center handle for easy lifter.
- Universal suction lifter for handling all kinds of loads.

ASL-9190CA

DOUBLE SUCTION CUPS



- Loading capacity... 40 kgs
- Diameter: 117 mm
- Main body... ABS
- Universal suction lifter for handling all kinds of loads.
- Makes working with unwieldy parts quicker and more effective.

ASL-2

2 PC SUCTION LIFTERS



- Loading capacity... 80 Kgs
- Weight... 2000 gs
- Diameter... 110 mm
- Main body... ABS
- For Auto & Construction

ASL-1

SUCTION DENT PULLER



- Loading capacity... 40 Kgs
- Diameter... 110 mm
- Main body... Nylon
- For Auto & Construction

QA-1690

CHANGEABLE TIP BLENDING HAMMER



- Material... aluminum & pom
- This aluminum blending hammer has 12" handle and it comes with 4 changeable tips.
- Use any of tips that have 5/16" threads.
- Tips can store in handle between uses.

QA-1680

13 PCS CHANGEABLE HAMMER KIT



- Contents...
 - 1_Body
 - 1_Wrench
 - 1_withdrawl of tool
 - 1_Screws(4pcs)
 - 9_Hammer head... Plastic, Aluminum, Copper alloy, Stainless steel, Lesser dentate, Larger dentate, Flat- bottom, Sharp-pointed, Oblique
- Easy to assemble, light and compact.

QA-1744

SOFT TIP AIR HAMMER SET



- Includes aluminum, brass, steel & nylon air tipped tools.
- Non sparking.
- Non marring for sensitive surfaces.
- Replaceable hammer heads.
- For aluminum body cars.
- 0.401" shank tools.

QA-1745

SOFT TIP AIR HAMMER SET



- Includes aluminum, brass, steel & nylon air tipped tools.
- Non sparking
- Non marring for sensitive surfaces
- Replaceable hammer heads
- For aluminum body cars
- 0.401" shank tools

QA-1001

DOUBLE END DOLLY



- POM material with one end having a 70mm diameter round convex head while the other has a 65mm wide curved wedge shaped head.
- Ideal for working on lighter sheet metal panels as the material provides a cushioning effect to match the weight of the hammer.

QA-1002

ROUND HEAD CHISEL DOLLY



- POM material with long handle and 95mm diameter half round head with chamfer on edge, can reach into narrow openings to reform damaged panels.
- Head... 3-1/2" (95 mm), Length... 11" (280 mm)

QA-1003

BOLSTER HEAD DOLLY



- POM material with long handle and 95mm straight blade chisel head with chamfer on edge, can reach into narrow openings to reform damaged panels.
- Head... 3-1/2" (95 mm), Length... 11" (280 mm)

QA-1004

CREASE ALIGNMENT TOOL

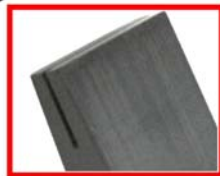

- POM material.
- By means of the groove crease and profiles can be laterally arranged.
- Furthermore an import fitting in assistance for hood an truck flap.

QA-1005

CREASE ALIGNMENT TOOL



- POM material.
- By means of the groove crease and profiles can be laterally arranged.
- Furthermore an import fitting in assistance for hood and truck flap.
- Size... 25 × 300(L) mm

QA-1006

PROFILE ARRANGING BLOCK



- POM material.
- This solid tools carry excellent services out when strong working on of strongly distorted sections just like with fine work.
- Full impact force, for curved outlines, pointedly approaching sheet metals, large surface.

QA-1007

HAND FIST FLAT AND CURVED DOLLY



- POM material.
- To holding against and bumping out at roundnesses, large surfaces, edges.

QA-1008

LARGE TOE DOLLY



- POM material.
- Particularly to treatment of bodies from steel, high and maximumfirm, specially-thin steel sheets as well as aluminum bodies.
- The sheet metal without it arranges to stretch or shrink.
- Optimal use e.g. at door sheet metals, trace widenings and for careful.

QA-1009

HEEL DOLLY



- POM material.
- Weighted to match body hammer weight.
- Works well on thinner sheet metal.
- Moves the metal rather than stretching it.

QA-1010

LEVEL SYSTEM THINGS AND BUMPING OUT TOOL



- POM material.
- Ideal for working on difficulty accessible places. E.G. doors, fender, truck lid.

QA-1011

WINDOW BARS-LIFT



- POM material.
- Suitable e.g. for Opel, Ford, DB, BMW etc.
- Length... 300mm, Height... 150mm, Strength... 20mm.

QA-1012

GENERAL PURPOSE DOLLY



- POM material.
- Comfortable hand hold during heaviest blows.
- Weight, balance and different crowned working faces.
- Two beading and flange lips give this dolly wide general use.

QA-1013

BLOCK DOLLY



- POM material.
- Double end dolly.

QA-1014

CURVED DOLLY



- POM material.
- Long type curved dolly.

QA-1015

WEDGE DOLLY



- POM material.
- Curved face.
- Also available in a thinner version.

QA-1016

7 PCS DOLLY SET



- POM material.
- Contents...
Double end dolly, Large toe dolly, Heel dolly, Block dolly, General purpose dolly, Curved dolly, Wedge dolly.
- Package... Blow case

QA-1017

12 PCS DOLLY SET



- POM material.
- Contents...
Double end dolly, Round head chisel dolly, Bolster head dolly, Crease alignment tool, Profile arranging block, Hand fist flat and Curved dolly, Large toe dolly, Heel dolly, General purpose dolly, Block dolly, Curved dolly, Wedge dolly.
- Package... Blow case

991103-01E1

MULTI HOLE PULL PLATE

- TO lock the screws with plate on the car, in order to pull straight-line.

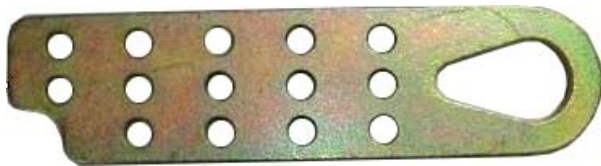

991103-01E2

DOOR POST PULLER



- Applicable chain: 5/16", 3/8"
- Fixed on the car to pull sidelong-line
- Capacity... 2 ton

991103-01E3

CHAIN HANDY HOOK

- Help to pull for body repair



991103-01F2

SMALL MOUTH PULL CLAMP(TWO-WAY)



- Capacity...
5 ton (Straight way)
2 ton (Cross way)
- Bolt size... Ø16mm × 70mm(L)
- Two-way pull operation.

991103-01F3

BIG MOUTH CLAMP



- Capacity... 3 ton
- Bolt size... Ø14 × 120mm (L)
- Single-way pull operation.

991103-01F5

BOX CLAMP (TWO-WAY)



- Capacity...
3 ton (Straight way)
2 ton (Cross way)
- Two-way pull operation
- Both side's jaws are different in order to fit the confined room.
- Bolt size... Ø14 × 110 mm (L)

991103-01F6

HEAVY DUTY CLAMP



- Capacity... 5 ton
- Single-way pull operation.
- Special design for operator when they need to powerful pull.
- Bolt size... Ø20 × 130mm (L)

991103-01F7

LONG NOSE CLAMP



- Capacity... 2 ton
- Bolt size... Ø14 × 73 mm (L)
- Single-way pull operation.
- The flat design is specialize for the confined room.

991103-01F8

MINI CLAMP (TWO-WAY)

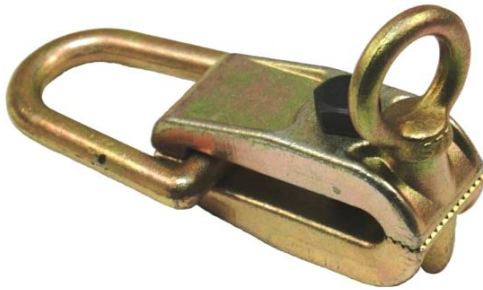

- Capacity...
3 ton (Straight way)
2 ton (Cross way)
- Bolt size... Ø14mm x 45 mm(L)
- Two-way pull operation.
- Special mini design is good to use in a narrow and small space.

991103-01F9

SCISSOR CLAMP



- Capacity... 3 ton
- Single-way pull operation
- Clipper design to make operators do not need fixed by screws.
- The tool's feature is when operator pull longer and it will tight more.

991103-01F10

"C" TYPE CLAMP (3")



- Capacity... 5 ton
- Multi-way pull operation
- Body opening... 3"

991103-01G3

FRAME RACK CLAMP (MULTI-WAY)



- Capacity...
5 ton (Straight way)
3 ton (Cross way)
3 ton (Multi-way)
- The special puller design used with steel makes it hard to be broken.
- Bolt size... Ø14 × 73 mm (L)

991103-01G4

FRAME RACK CLAMP BAR



- Capacity... 5 ton
- Bolt size... Ø14mm × 73 mm(L)
- Use the two hooks to pull and fix the car.
- This tool could be clipped to unibody or any other place of the body.
- The puller and hooks are adjustable; it could be change the range for fitting the place.

991103-01H1

CHAIN JOINT (DOUBLE GRAB HOOKS)



- Capacity... 6 ton
- For use as chain shortner or chain connector.
- Use with 5/16" or 3/8" chains.
- Contact of two chain is always on a same level, meaning no twisting of chain happens accordingly.

FH-158

FILE HOLDER



- Size... 352(L) x 35(W) x 4(T)mm
- Holder material... Aluminum
- Base material... S45C
- Adjust screw material... Alum.
- Holder only without blade

QA-1300

13PCS EXCHANGE NEEDLE FILE SET



- Contents...
 - 1_ Handle Assembly with Collet.
 - 12_ Files, blade dia. 5mm, type...
 - Crossing, Flat, Round, Half Round, Knife, Square, Three Square, Barrette, Joint, Slitting, Marking, Equaling.

QA-1304

COARSE NIB FILE



- Fix small marks and clean debris from finished surfaces -- without sanding !
- This handy little tool will save hours of labor and paint jobs.
- Overall dimensions... 1 3/8"(L) x 1 1/4"(W) x 3/4"(H)

QA-1305

FINE NIB FILE



- Fix small marks and clean debris from finished surfaces -- without sanding.
- This handy little tool will save hours of labor and paint jobs.
- Overall dimensions... 1 3/8"(L) x 1 1/4"(W) x 13/16"(H)

QA-1301

4PC BODY FILLER APPLICATOR SET



- Stainless steel blade comfortable bi-material grips for ergonomic design and comfort.
- Heavy-duty handles.
- For smooth application of fillers and putties.
- Blade width... 2" (50mm), 3" (75mm), 4" (100mm), 6" (150mm)

QA-1302

4PC BODY FILLER APPLICATOR SET



- Stainless steel blade comfortable bi-material grips for ergonomic design and comfort.
- Heavy-duty handles.
- For smooth application of fillers and putties.
- Blade width... 1" (25mm), 2" (50mm), 3" (75mm), 4" (100mm)

QA-1303

4PC BODY FILLER APPLICATOR SET



- Stainless steel blade comfortable bi-material grips for ergonomic design and comfort.
- Heavy-duty handles.
- Suitable for the application of auto body filler.
- Blade width... 1.5" (38mm), 2" (50mm), 2.5" (63mm), 3" (75mm)

PK-2545P

3 PCS PLASTIC SPREADER SET



- Material... PE (Polyethylene)
- Size... 2-1/2", 4", 5"
- Use for fillers, fiberglass resin, spot putty.

PK-4020P

20 PCS PLASTIC SPREADER SET



- Material... PE (Polyethylene)
- Size... 4"
- Use for fillers, fiberglass resin, spot putty.

VPB-1576

VACUUM PUMP AND BRAKE BLEEDING KIT



- Multi-function for vacuum-related tests and brake bleeding.
- The vacuum-operated systems includes intake manifold, exhaust gas recirculation (EGR), automatic transmission, fuel control, air conditioning and heating systems.
- Without needing another person depressing the brake pedal while bleeding the air.
- Suitable for ABS, conventional brake system and power brake system.
- Contents...
 - 1_ Vacuum pump with gauge, 1_ 200ml reservoir bottle
 - 1_ Storage lid, 1_ Fluid transfer lid, 2_ Connection hoses
 - 1_ Small kit with various adapters and tubes

BE-2526K

BASIC BRAKE OIL EXTRACTOR KIT



NEW

- Pneumatic extractor non-spark.
- A lightweight, easy carry & operation.
- One man in same step operate.
- 1 meter silicon hose with universal rubber bleed nipple adaptor.
- Fixing valve & safety cup for automatic cut-off extracting.
- Max. Capacity... 2000cc
- Working pressure(PSI)... 40 to 170
- Air consumption (CFM)... 2
- Temperature range... -3°F to 140°F
- Air inlet... 1/4"

QA-2262

ONE-MAN BRAKE BLEEDER



NEW

- Allows one person to bleed air from brake lines.
- Plastic bottle collects discharged fluid.
- Three separate adapters fit the common bleeder screws.

QA-2077

BOILING BRAKE FLUID TESTER



NEW

- CE Approval.
- This tester can measure the boil point of the brake fluid.
- It can obtain the wet boiling temperature of the brake fluid for technician as a reference for maintenance.
- It can be the reference when technician is going to change the brake fluid.
- Power... 12V automotive battery
- Working environment... 0 - 50°C
- Accessories... 1pc sucker, 1pc measuring cap
- Specifications...
 - _ Dry boiling point, DOT3 $\geq 205^{\circ}\text{C}$, DOT4 $\geq 230^{\circ}\text{C}$, DOT5.1 $\geq 260^{\circ}\text{C}$
 - _ Wet boiling point, DOT3 $\geq 140^{\circ}\text{C}$, DOT4 $\geq 155^{\circ}\text{C}$, DOT5.1 $\geq 180^{\circ}\text{C}$

990531-01A

BRAKE FLUID TESTER



- Green... Battery OK, i.e.: no water contained in the brake fluid.
- Yellow... Less than 1% of water content in brake fluid.
- Yellow / Yellow... Approximately 2% of water content in brake fluid.
- Yellow / Yellow / Red... Approximately 3% of water content in brake fluid. The brake fluid should be changed.
- Yellow / Yellow / Red / Red... At least 4% of water content in brake fluid. The brake fluid must be changed urgently, extreme danger.

QA-2078

RATCHET BRAKE CALIPER PRESS

NEW



- Works on various single, dual & quad piston calipers.
- Centrally distributes force to prevent misalignment of pistons.
- 360 degree ratchet swing allows access at any angle.
- Extended reversing lever allows for easy change from spreading to retracting.
- Clips between 40 and 68mm.

QA-2079

RATCHET BRAKE CALIPER PRESS

NEW



- Works on various single, dual & quad piston calipers.
- Centrally distributes force to prevent misalignment of pistons.
- 360 degree ratchet swing allows access at any angle.
- Extended reversing lever allows for easy change from spreading to retracting.
- Clips between 40 and 68mm.
- Plate size... 115(L) × 60(W) mm and 177(L) × 60(W) mm

QA-2080

7PCS BRAKE PISTON SPREADER SET

NEW



- Brake piston spreader kit with three pairs of spreader pads.
- Suitable for 1, 2, 4, 6, and 8 multi piston calipers.
- Centrally distributes force to prevent misalignment of pistons.
- 360 degree ratchet swing allows access at any angle.
- Extended reversing lever allows for easy change from spreading to retracting.
- 3 pairs of spreader pads size...
115(L) × 60(W) mm, for 1 and 2 pistons
148(L) × 60(W) mm, for 4 pistons
177(L) × 60(W) mm, for 6 and 8 pistons

QA-1669

2 & 3 PIN BRAKE PISTON REWIND BACK TOOL



3 PIN Range : 20-35mm



2 PIN Range : 20-35mm

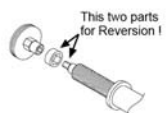

This two parts for Reversion !



- For clockwise/counter clockwise
- Range... 20 to 35 mm
- This tool kit allows to rewind the pistons into brake calipers.
- Able to push piston back into caliper simultaneously.
- Spindle spanner and sleeve for anti-tooth screw according to the factory operation.
- Fits most of cars including Alfa Romeo, Audi, Citroen, Ford, Honda, Jaguar, Land Rover, Mazda, Mercedes, Mini, Mitsubishi, Nissan, Lancer, Toyota, VW, Volvo, Vauxhall and others.

QA-1670

2 & 3 PIN BRAKE REWIND FIT 3/8"DR. ADAPTOR



- With 3/8" Square driver
- 2 pcs/set
- All range is 20 to 35 mm
- This tool kit allows to rewind the pistons into brake calipers.
- Able to push piston back into caliper simultaneously.
- Fits most of cars including Alfa Romeo, Audi, Citroen, Ford, Honda, Jaguar, Land Rover, Mazda, Mercedes, Mini, Mitsubishi, Nissan, Lancer, Toyota, VW, Volvo, Vauxhall and others.

QA-1671

2 & 3 PIN BRAKE REWIND FIT REGULAR ADAPTOR



- Fit regular adaptor.
- 2 pcs/set
- All range... 20 to 35 mm
- This tool kit allows to rewind the pistons into brake calipers.
- Able to push piston back into caliper simultaneously.
- Fits most of cars including Alfa Romeo, Audi, Citroen, Ford, Honda, Jaguar, Land Rover, Mazda, Mercedes, Mini, Mitsubishi, Nissan, Lancer, Toyota, VW, Volvo, Vauxhall and others.

QA-1679

BRAKE CYLINDER GROOVE CLEANER



- T shape dicephalous cutterhead is applied for cleaning all kind sizes and angles of brake cylinder.
- The handle has 120(L) × 6mm and made from 2" wire wheel, to clear surface dirt.

QA-2264

SMALL FASTENER REMOVER



- Useful for removing brake rotor screws, Works faster than hand impact tools.
- A 3/4" open end wrench can be used to turn the socket while impacting the fastener.
- A locking pin in the driver keeps the bit holder in place on the square drive for safe operation.
- The bit holder can be removed from the driver by depressing the pin.
- Contents...
 - 1_ Impact driver
 - 5_ 5/16" Hex impact bits, Size... PH1, PH2, PH3, PH4, Straight slot.

QA-2267

TRUCK BRAKE CAGE BOLT SOCKET



Item no.	Driver	Size
QA-2267	1/2"	3/4"
QA-2268	1/2"	15/16"
QA-2269	1/2"	1-1/16"

- Can be used with impact wrenches.
- Extra deep socket loosens the cage bolt to unlock air brakes on trucks.
- Can removes the air brake booster for replacement.

QA-2164

BRAKE PAD THICKNESS GAUGE



- Measure range... 1.5 to 13mm
- A clever time saving tool to measure the brake pad lining of the vehicle without taking off the wheel.
- Apply to both internal and external brake pads.
- Slender design to easily locate on the rear of the pad backing plate and to measure the distance between the underside of the backing plate and brake disc.
- Scale calibrated for normal 6 mm thick backing plate.

QA-1310

GAUGE FOR BRAKE DISC & TYRE DEPTH

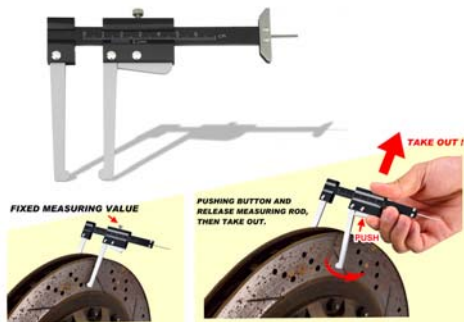

- Body material... Aluminum
- Measure range... 0 to 60mm, Accuracy 0.1mm
- Suitable for measuring the thickness of brake disc and tyre depth.
- Special device to fix the value you obtain while you measuring the thickness of brake disc.

BLG-540

BRAKE LINING GAUGE

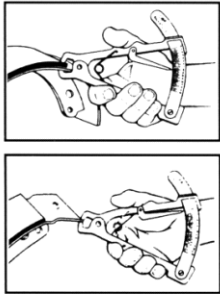

- Measuring brake lining from 0 to 1/2" in 1/64" graduations.
- Apply jaws to brake shoe only as shown, keeping jaws on shoe, move the indicator arrow to "0". This will automatically subtract the shoe thickness from the total measurement.
- Apply jaws to shoe and lining as shown. The arrow will indicate the amount of lining remaining.

QA-2260

BRAKE LINING THICKNESS GAUGE



- Color coded brake gauge identifies thickness levels for lining inspection.
- Material... Steel
- Size...
Red color 2, 3mm(0.0787", 0.1181")
Yellow color 4, 5, 6mm(0.1575", 0.1969", 0.2362")
Green color 8, 10, 12mm(0.3150", 0.3937", 0.4724")

QA-2261

BRAKE LINING THICKNESS GAUGE



- Color coded brake gauge identifies thickness levels for lining inspection.
- Material... Plastic(ABS)
- Size...
Red color 2, 3mm(0.0787", 0.1181")
Yellow color 4, 5, 6mm(0.1575", 0.1969", 0.2362")
Green color 8, 10, 12mm(0.3150", 0.3937", 0.4724")

QA-2236

BRAKE SPRING PLIERS



- For glued and riveted brake linings.
- With movable claw.
- Surface chrome-plated.

QA-2233

BRAKE SPRING PLIERS

- For installing and removing the brake shoe recuperating spring on riveted brake linings.
- Surface chrome-plated.



QA-2234

BRAKE SPRING PLIERS

- Tool easily removes and installs shoe return springs on most drum brakes.
- Socket end removes spring from anchor stud and notched end installs spring on anchor.
- Tool is chrome plated to resist rust and provide easy clear-up.



QA-2237

BRAKE SPRING PLIERS

- Easy for assemble and disassemble the springs of the brake shoes in a drum brake.
- Caused Zero damage to the components.
- Handle with a socket end for removing spring from anchor stud.
- Handle with a grooved end for installing spring on anchor.
- Jaw with an unique sunflower-shaped and swivel design allows the operator to grab the surface of the drum brake shoes firmly, and the other jaw hooks the hooking portion of the return spring.
- And then holding close two handles to assembly or disassemble the spring of the brake shoes.



QA-2235

BRAKE SPRING PLIERS

- Tool easily removes and installs shoe return springs on most drum brakes.
- Socket end removes spring from anchor stud and notched end installs spring on anchor.
- Tool is chrome plated to resist rust and provide easy clear-up.



QA-2241

BRAKE ADJUSTMENT TOOL

- Speeds starwheel adjusting.
- Insert tool through slot in backing plate.
- Different angle at each end adapts makes and models.



QA-2242

DRUM BRAKE ADJUSTING TOOL

- Blade width... 17/32" × 3/8"
- Length... 7" (177.8mm)



QA-2243

DRUM BRAKE ADJUSTING TOOL

- Adjusts clearance between brake drum and brake shoe.
- Offset heads fit most drum brakes.



QA-2244

DRUM BRAKE ADJUSTING TOOL

- Tool adjusts clearance between drum brake and brake shoe.
- It fits through a slot in the backing plate and turns the star wheel in many drum brakes.



QA-2245

BRAKE ADJUSTING TOOL

- One end has a wind tang set at a 29° angle for rear brakes.
- The other end is set at a 45° angle for front brakes.
- Length 8-1/4".



QA-2246

BRAKE ADJUSTING TOOL

- Fix Bendix brakes with star adjusting nut and other self-adjusting brakes (except Chevy).
- 7/32" wide blade, 1/32" tip thickness, 8-3/16" long.



QA-2247

DRUM BRAKE ADJUSTING TOOL

- Tool adjusts clearance between drum brake and brake shoe.
- It fits through a slot in the backing plate and turns the star wheel.
- Offset tool end for hard-to-reach areas on small cars.



QA-2232

CLEARANCE ADJUSTING TOOL

- First, take off a dust-proof cover of the clearance-adjusting hole disposed in the back of the drum brake system.
- Secondly, insert the clearance-adjusting tool into the clearance-adjusting hole and move the clearance-adjusting brake ratchet until a proper brake clearance is achieved.



QA-2259

UNIVERSAL DRUM BRAKE SPRING WASHER PLIERS

NEW



- Provides universal application for nearly all drum brakes.
- Work on drum brake hold-down retaining spring washers.

QA-2248

BRAKE SPRING WASHER TOOL

- Fits both large and small washers.
- Troublesome brake shoe retaining spring washers can now be easily removed and then reinstalled.
- Wide "window" allows better visibility to align the nail and washer slot.



QA-2249

BRAKE SHOE RETAINING SPRING COMPRESSORS

- Removes brake shoe retaining spring washers 5/8" to 11/16" (16-17mm) diameter.
- Use on late model compact cars and light trucks.
- Place tapered end over brake spring retaining washer.
- Push tool in and rotate 1/4" turn to release pressure and remove spring.
- Reverse to install.



QA-2250

BRAKE SPRING WASHER TOOL

- Remove and install brake spring washers 5/8" to 7/8" in diameter.
- Fits both large and small brake spring washers.



QA-2251

BRAKE SPRING TOOL

- Removes and installs brake return springs.
- Works on brakes that don't use an anchor pin.
- Engage brake spring in tool head, turn handle to lock on spring, and expand spring to install or remove.



QA-2240

DISC BRAKE PISTON TOOL

- This cube tool rotates pistons back into brake calipers when replacing brake pads on vehicles with rear wheel disc brakes.
- Tool has 3/8" square drive, provides six drive pin configurations to fit most cars and light trucks.
- This updated version fits more applications than many competitors.



QA-2253

EMERGENCY BRAKE CABLE REMOVAL TOOL

NEW

- Used on domestic and import vehicles that utilize an emergency brake cable at the rear wheels with cable connector under the vehicle, including drum brake applications and most rear disc brake vehicles.
- Place brake cable in slot of pliers and use blade of pliers to push the cable out of the cable connector.
- Hardened steel construction for durability.
- Soft touch handle grips.



QA-2254

UNIVERSAL EMERGENCY BRAKE TOOL

NEW

- Compresses spring on emergency brake cable to replace brake shoe arm.
- Fit vehicles using cable/spring emergency brake assembly.
- Eliminates pinched fingers.
- Frees one hand for replacing brake shoe lever.



QA-2256

MANUAL SLACK ADJUSTER PULLER



- Designed to service all S-cam air brake slack adjusters on the market.
- This tool eliminate costly S-cam damage caused by "heat and beat" method.
- Replacement is accomplished in a fraction of the usual time.
- This puller have a rugged forcing screw and cast steel body.

QA-2257

AUTOMATIC SLACK ADJUSTER PULLER



- Designed to service all S-cam air brake slack adjusters on the market.
- Works on Rockwell, Haldex, Gunite, and Bendix automatic adjusters.
- This tool eliminate costly S-cam damage caused by "heat and beat" method.
- Replacement is accomplished in a fraction of the usual time.
- This puller have a rugged forcing screw and cast steel body.

QA-2255

AIR BRAKE SERVICE KIT



- This kit includes the tool needed to remove the air brake push rod clevis pins, and both manual and automatic slack adjusters found on class 7 & 8 tractor and trailer brake systems.

QA-2252

DISC BRAKE PAD SPREADER



- Spreader fits between two new pads being installed, then expands to retract the piston.
- Leaves hands free to start caliper over rotor.
- Slides off easily.
- For all standard and four-piston caliper disc brakes.

QA-2238

13PCS DISC BRAKE REPAIR KIT



- Contents...
 - 1_ Brake adjustment tool
 - 1_ Heavy-duty brake pad separator
 - 1_ Disc brake piston tool
 - 1_ 3/8" Dr. bit driver adapter
 - 3_ Star bits, Size... T40, T45, T50
 - 6_ Hex bits, Size... 1/4", 5/16", 3/8", 7, 8, 10mm

QA-2239

15PCS DISC BRAKE REPAIR KIT



- Contents...
- 1_ Brake adjustment tool
- 1_ Heavy-duty brake pad separator
- 1_ Disc brake piston tool
- 1_ Brake shoe retaining spring compressors
- 1_ Brake spring pliers
- 1_ 3/8" Dr. bit driver adapter
- 3_ Star bits, Size...T40, T45, T50
- 6_ Hex bits, Size...1/4", 5/16", 3/8", 7, 8, 10mm

QA-1733

HYDRAULIC FLARING TOOL KIT



- Set for flaring GM fuel lines, brake lines, manual transmission lines and A/C lines.
- Hydraulic flaring tool helps save energy and increase precision.
- Includes several adapters and dies for...
Metric bubble flaring... 4mm(5/32"), 6, 8, 10 mm
45 degree double flaring... 3/16, 1/4, 5/16, 3/8, 1/2"
GM fuel line forming 5/16, 3/8"
Push connect forming 1/4, 5/16, 3/8"



QA-2265 **NEW** 12PCS FLARING TOOL SET



- The tool works on cupro-nickel and steel pipes as well as coated steel piping. Can be used in-situ.
- The set incorporates the tools to flare 4.75mm, 5mm and 6mm pipes by using the correctly sized die and punches.
- Contenes...
- 2_ SAE convex flare punch, Size... 4.75(3/16") & 5mm, 6mm(1/4")
- 1_ SAE double flare punch, Size... 4.75(3/16") & 5mm & 6mm(1/4")
- 2_ DIN convex flare punch, Size... 4.75(3/16") & 5mm, 6mm(1/4")
- 3_ Die, Size... 4.75, 5, 6mm, 1_ Force screw, 1_ Main part
- 1_ Handle, 1_ 5mm Hex key wrench

QA-2266 **NEW** 13PCS FLARING TOOL SET



- The tool works on Cupro-Nickel and Steel pipes as well as coated steel piping. Can be used in-situ.
- The set incorporates the tools to flare 4.75mm, 5mm and 6mm pipes by using the correctly sized die and punches.
- Contenes...
- 1_ Ratchet wrench
- 2_ SAE convex flare punch, Size... 4.75(3/16") & 5mm, 6mm(1/4")
- 1_ SAE double flare punch, Size... 4.75(3/16") & 5mm & 6mm(1/4")
- 2_ DIN convex flare punch, Size... 4.75(3/16") & 5mm, 6mm(1/4")
- 3_ Die, Size... 4.75, 5, 6mm, 1_ Force screw, 1_ Main part
- 1_ Handle, 1_ 5mm Hex key wrench

QA-2082

BRAKE LINE CLAMP



- Brake line capacity... Max. Ø5mm
- Made of S45C
- The brake line clamp tool allow you to bend the new tube compare with old tube.
- Make sure the angle same with OEM.
- Do not need check every move in bending work.
- Save time and have the tube angle accuracy.
- 4pcs / set

QA-2263

TUBING BENDER PLIERS



- Bends both 3/16" and 1/4" brake lines without kinking or flattening, especially in tight spots.
- Bends most other types of 3/16" and 1/4" O.D. tubing.
- Unique head design bends tubing without collapsing the tube.
- Won't mark tube surface.
- The handles are more than 3-1/4" apart for proper leverage when handling even steel tubing.
- Overall length... 230mm

QA-1399

BRAKE LINE BENDING PLIERS



- Suitable for Dia.3/16" and 1/4" brake and fuel lines.
- Align, bend and adjust brake and fuel lines without distortion.
- Forged steel construction, cushioned grip handles.

QA-2123

ROLLING TUBE BENDER



Item no.	Capacity
QA-2123	3/16", 1/4"
QA-2124	3/8" , 5/16"

- Use this tool to form tight bends in brake and fuel lines without kinking or flattening, or harming protective coatings.
- Minimizes stretching and distortion.

QA-2114

ADJUSTABLE PIPE BENDER



- A unique, fully adjustable tool for forming perfect bends on pipe sizes from 3/16"(4.75mm) to 3/8"(10mm).
- Hand held operation for in-situ work, and fitted with vice mounting lug for greater control when forming bends.

QA-2115

TUBE STRAIGHTENER



- Straighten 3/16" to 3/8"(4.75 to 10mm) annealed tubing, including stainless steel.
- U-shaped rollers straighten both tubing sizes-no need to change rollers.
- Hard polymer rollers leave a smooth finish on tubing.
- Ball-bearings provide smooth action.
- Table mount ready, with optional vise-mounting base.

QA-2116

TUBE STRAIGHTENER



NEW



- Fully adjustable from 3/16" to 1/2" (4.75 to 12.7mm) tubing.
- Vise or bench mount double brackets.
- Heavy duty construction.

TC-130D.

MINI TUBE CUTTER



- Capacity... 3 - 16mm
- With 1pc SUJ2 blade

TC-128B-1H.

TUBING CUTTER



- Capacity... 3 - 32 mm (1/8 to 1 1/4")
- With 1pc H.S.S. blade (3.0 × 18 mm)

QA-1391.

DEBURRING TOOL



- Internal / External deburring tool.
- Size range internal 3-12mm, external 4-14mm.

QA-1025

EXTRA HEAVY-DUTY LONG TAPER PUNCH

- Blade material... SCM440 steel, HRC 40° - 44°
- Grip material... PP
- Size...
Stock... 11/16"(17mm), Tip... 3/16"(5mm), Length... 16" (405mm)



QA-1026

EXTRA HEAVY-DUTY DIAMOND POINT CHISEL

- Blade material... SCM440 steel, HRC 40° - 44°
- Grip material... PP
- Size...
Stock... 11/16"(17mm), Tip... 3/32"(2.5mm), Length... 16" (405mm)



QA-1027

EXTRA HEAVY-DUTY LONG COLD CHISEL

- Blade material... SCM440 steel, HRC 40° - 44°
- Grip material... PP
- Size...
Stock... 11/16"(17mm), Blade width... 3/8"(9.8mm),
Length... 16" (405mm)



QA-1028

EXTRA HEAVY-DUTY LONG COLD CHISEL

- Blade material... SCM440 steel, HRC 40° - 44°
- Grip material... PP
- Size...
Stock... 11/16"(17mm), Blade width... 1-3/16"(30mm),
Length... 16" (405mm)



QA-1029

EXTRA HEAVY-DUTY LONG COLD CHISEL

- Blade material... SCM440 steel, HRC 40° - 44°
- Grip material... PP
- Size...
Stock... 11/16"(17mm), Blade width... 2"(50mm),
Length... 16" (405mm)



QA-1030

EXTRA HEAVY-DUTY LONG COLD CHISEL

- Blade material... SCM440 steel, HRC 40° - 44°
- Grip material... PP
- Size...
Stock... 11/16"(17mm), Blade width... 3-1/16"(78mm),
Length... 16" (405mm)



QA-1032

SHEATHED AUTOMATIC CENTER PUNCH

- Tip material... SUJ2, HRC 57° - 60°
- PP + TPR grip
- Simply press the end to release spring impact.
- Impact adjustable from 15 to 25 kg by rotating the end.



QA-1038

4PCS HEAVY DUTY PIN PUNCH SET

- Blade material... SCM440 steel, HRC 50° - 52°
- Grip material... PP + TPR
- Size... 10, 12, 14, 16 mm



QA-1039

4PCS HEAVY DUTY CHISEL SET

- Blade material... SCM440 steel, HRC 50° - 52°
- Grip material... PP + TPR
- Contents...
3_ Flat Chisel, Size... 15, 20, 25 mm
1_ Cape Chisel, Size... 10 mm



QA-1042

5PCS HEAVY DUTY PIN PUNCH SET

- Blade material... S45C, HRC 38° - 42°
- Grip material... PP + TPR
- Size... 3, 4, 5, 6, 8 mm



DP-100.

8 PC PIN PUNCH SET



- Chrome vanadium steel.
- Content...
 - 120 mm(L).. 1.6, 2.3, 3.2 mm
 - 150 mm(L).. 4, 4.8, 5.5, 6.4, 8mm

QA-1033

BRASS TAPER PUNCH



- Size... Length 8" (203mm), 5/8" Hex- tapered to 3/8"
- Ideal for use where sparks from ferrous metal could b hazardous or where precision metal parts could be damaged by using steel punches.

QA-1034

BRASS BAR PUNCH



- Size... Length 10" (254mm), Diameter 3/4"
- Chamfered both ends.
- Ideal for use where sparks from ferrous metal could b hazardous or where precision metal parts could be damaged by using steel punches.

QA-1035

NON-SPARKING BRASS PUNCHE SET



- Ideal for use where sparks from ferrous metal could b hazardous or where precision metal parts could be damaged by using steel punches.
- Contents...
 - 1_ Taper punch, Length 8" (203mm), 5/8" Hex- tapered to 3/8".
 - 1_ Bar punch, Length 10" (254mm), Dia. 3/4".

QA-1036

3PC SOLID BRASS DRIFT PUNCH SET



- Heavy duty punches for rough jobs.
- Non-sparking solid brass won't damage object being struck.
- Contents...
 - 2_ Drift punches, 5/8" × 8" , 3/4" × 14"
 - 1_ Starter punch 3/4" × 10"

QA-1037

3PC SOLID BRASS PIN & DRIFT PUNCH SET

- Non-sparking solid brass won't damage object being struck.
- Contents...
 - 2_ Pin punch, 1/4" x 4" , 3/8" x 6"
 - 1_ Drift punch 1/2" x 8"



QA-2273

5 PCS DRIFT PUNCH SET

- Contents...
 - 1_ Sheathed anti-vibration handle.
 - 2_ Brass tips Ø25 and 30mm, Effective length 40mm.
 - 2_ Polyamide tips Ø25 and 30mm, Effective length 40mm.



NEW

PC-6405

6PCS EXTRA HEAVY DUTY PUNCH & CHISEL SET

- Blade material... SCM440 steel, HRC 40° to 44°
- Grip material... PP
- Size... Stock 11/16"(17mm), Length 16" (405mm)
- Contents...
 - 1_ Taper punch, Tip 3/16"(5mm)
 - 1_ Diamond point chisel, Tip 3/32"(2.5mm)
 - 4_ Cold chisel, Blade width...
 - 3/8"(9.8mm), 1-3/16"(30mm), 2"(50mm), 3-1/16"(78mm)



QA-1746

6 PCS EXTRA LONG AIR HAMMER DRIFT SET

- Ideal for removing corroded bolts or long pins.
- 7" (177mm) long parallel shaft design will not get stuck in holes standard.
- 0.401" shank fits most air hammers.
- Manufactured from forged and heat treated CR-MO steel.
- Sizes included...
 - 3/16" (5.2mm), 1/4" (6.5mm), 9/32" (6.9mm), 5/16" (7.7mm), 3/8" (9.3mm), 1/2" (12.7mm)



QA-2272

15 PCS DRIFT PUNCH SET

- Capacity... Ø3 to 8mm.
- Contents...
 - 1_ Sheathed anti-vibration handle.
 - 4_ Brass tips Ø4 to 8mm, Effective length 20mm.
 - 5_ Steel nail set tips Ø 3 to 8mm, Effective length 40 to 65 mm.
 - 5_ Steel drift punch tips Ø3 to 8mm, Effective length 40 to 65mm.



NEW

QA-2271

19 PCS BRASS, POLYAMIDE & ALUMINUM DRIFT PUNCH SET



- Capacity... Ø10 to 20mm.
- Contents...

NEW

- 1_ Sheathed anti-vibration handle.
- 3_ Brass tips for extension Ø12, 16, 18mm, Effective length 20mm.
- 3_ Brass tips Ø12, 16, 20mm, Effective length 40mm.
- 3_ Polyamide tips for extension Ø12, 16, 18mm, Effective length 20mm.
- 3_ Polyamide tips Ø12, 16, 20mm, Effective length 40mm.
- 5_ Steel tips Ø10, 12, 14, 16, 18mm, Effective length 60mm.
- 1_ Extension 217.R12, Effective length 100mm.

PC-270

27PCS INTERCHANGEABLE PUNCH & CHISEL SET



- One-piece, Cr-Mo steel handle, quick-change and multi-functionality.
- Two-color, ergonomic grip (PP + TPR)
- Punch & chisel material... T61, HRC 55° - 58°
- Contents...

- 6_ Pin Punch, Size... 2×10×80mm, 3×10×90mm, 4×10×90mm, 5×10×90mm, 6×10×90mm, 8×10×90mm
- 6_ Long Pin Punch, Size... 3×10×115mm, 4×10×130mm, 5×10×130mm, 6×10×130mm, 8×10×130mm, 10×10×130mm
- 6_ Taper punch, Size... 1×10×80mm, 2×10×80mm, 3×10×80mm, 4×10×80mm, 5×10×80mm, 6×10×80mm
- 1_ Center Punch, Size... 4×10×80mm
- 1_ Cape Chisel, Size... 5×10× 80mm
- 1_ Point Chisel, Size... 10×80mm
- 6_ Chisel, Size... 10×10×80mm, 12×10×80mm, 15×10×80mm, 19×12×130mm, 22×16×130mm, 25×18×130mm

PRC-10A

PISTON RING COMPRESSOR



Item no.	Height	Capacity
• PRC-10A	76 mm (3")	53 to 125 mm
• PRC-10B	76 mm (3")	90 to 175 mm
• PRC-11A	89 mm (3-1/2")	53 to 125 mm
• PRC-8B	102 mm (4")	90 to 175 mm
• PRC-9B	153 mm (6")	90 to 175 mm
• PRC-12B	165 mm (6-1/2")	90 to 175 mm
• With adjustable safety screw		

PRC-8AS

PISTON RING COMPRESSOR



Item no.	Height	Capacity
• PRC-8AS	4" (100mm)	2-1/4 to 5" (57-125 mm)
• PRC-8BS	4" (100mm)	3-1/2 to 7" (90-175 mm)
• PRC-11AS	3-1/4" (80mm)	2-1/4 to 5" (57-125 mm)
• With safety valve.		

PRT-20

PISTON RING TOOLS



Item no.	Size
• PRT-20	80 to 120 mm
• PRT-19	50 to 100 mm
• Special steel. Nickel-plated.	
• For removing and mounting piston rings.	

PRST-01

PISTON RING SERVICE TOOLS SET



- Contents...
- 3_ Piston ring compressor...
 - Height 3", Capacity 53 to 125 mm
 - Height 3-1/2", Capacity 90 to 175 mm
 - Height 4", Capacity 90 to 175 mm
- 1_ Piston ring tool, Capacity 50 to 100 mm
- 1_ Piston ring groove cleaning, Fits 2 to 5", Capacity 51 to 127 mm,
- 1_ Blade1... 1/16, 5/64, 3/32, 1/8, 5/32, 3/16"
- 1_ Blade2... 2, 2.5, 3, 4, 4.5 mm, 1/4"
- 1_ Blade3... 1.2, 1.5, 1.8, 2.8, 5, 5.5 mm
- 1_ Offset screwdriver Phillips, Slotted

QA-2297

PISTON RING INSTALLER



- For piston rings size(width)... 1.2 - 6.3mm (3/64" to 1/4")
- Length... 175mm
- Save by reducing ring breakage.
- Tapered jaws to remove and install most passenger car and light truck rings.

QA-2298

PISTON RING PLIERS

- Length... 210mm
- With prism gripper for safe piston ring spreading.
- Special steel, Hardened prism gripper, Gunmetal finished tips.



QA-2299

PISTON RING INSTALLER

- Capacity... 3-1/4" to 5-5/16" (83 - 135mm)
- Length... 245mm
- Save by reducing ring breakage.
- Tapered jaws to remove and install most passenger car and light truck rings.



QA-1737

16PCS SPARK PLUG THREAD REPAIR TOOL SET



- Sleeve type.
- Special designed for repairing the damaged spark plug thread.
- Protecting sleeve special designed for interior and external thread.
- Contents...
- 5 _ M14×1.25 (11.2L) Replacement thread sleeve
- 10 _ M14×1.25 (17.5L) Replacement thread sleeve
- 1 _ Tap reamer, M16×1.25

QA-1736

17PCS SPARK PLUG THREAD REPAIR TOOL SET



- Sleeve type.
- Special designed for repairing the damaged spark plug thread.
- Protecting sleeve special designed for interior and external thread.
- Contents...
- 8 _ M12×1.25 (12.7L) Replacement thread sleeve
- 8 _ M12×1.25 (19L) Replacement thread sleeve
- 1 _ Tap reamer, M14×1.25

QA-2304

ROUND "KEY CHAIN" SPARK PLUG GAUGE



- This popular solid steel spark plug gauge is designed with a tapered edge for gauging sparkplugs and with a flanged hole to adjust the side wire of plugs without pressuring center electrode.
- Marked in standard and metric sizes.
- Used to gap all plugs from 0.020" to 0.100" (0.5 to 2.53mm).

991025-01C

SPARK PLUG WIRE REMOVE PLIER

- High carbon steel. Specially designed for removing high voltage lead wire in deep work areas.

Item no.	Size
• 991025-01C	8"
• 991025-01D	12"



QA-2301

SPARK PLUG WIRE PLIERS

- Overall length... 180mm(7")
- Removes spark plug wires safely with insulated handles and jaws.
- Small indentations in the jaws allow gripping even a bare terminal with engine running.



QA-2302

SPARK PLUG TERMINAL PLIERS

- Safely remove spark plug cables and prevent cable damage.
- Pliers handles and jaws are coated with a heavy-duty plastic for a sure grip.



QA-2303

HEAVY DUTY SPARK PLUG BOOT PLIERS

NEW



- This 10" (250mm) long reach spark boot pliers is designed to remove hard-to-reach spark plug boots.
- Double insulated to give complete protection against shock.
- Handle and jaws are double dipped to assure complete coverage of all contact areas.
- Also for light bulb removal.

QA-2300

SPARK PLUG BOOT PULLER

- Nylon stops the shocks and beats the heat and burns.
- Helps you pull spark plug wires quickly, easily and without damage to the wire or rubber boots.



SK-40B-16

SWIVEL SPARK PLUG WRENCH

- Removes all spark plugs.
- CR-V socket, Chrome plated, Insulated handle.

Item no. Size

SK-40B-16	16 mm (5/8")
SK-40B-21	21 mm (13/16")



VSC-756

VALVE SPRING COMPRESSOR

- Used for Car & Motorcycle. For fitting the valve spring correctly and easier to compress the valve spring.
- Contents...
 - 5_ Pusher, Size... 16, 19, 23, 25, 30 mm
 - 3_ Pressure screw, Length... 70, 110, 120mm
 - 1_ C Clamp



VSC-789

VALVE SPRING COMPRESSOR KIT

- Completes service tool kit for installation and removal of the valve spring without removal of cylinder head from the engine.
- Applicable for OHV & OHC petrol / diesel engine on Audi, Nissan, Toyota, Honda, Mazda, Chrysler, Mitsubishi, VW, Volvo, Porsche.



QA-2310

VALVE SPRING COMPRESSOR FOR OVERHEAD AND L-HEAD

NEW

- Compresses valve springs on overhead valve and L-head engines on cars, trucks and tractors.
- Throat depth 9-3/4" and jaw opening 2-3/4" to 7-3/4" fits larger engine sizes.
- Jaws and plunger bar are easily adjusted.
- Plunger bar seats on both flat and cup shaped valve heads.
- Includes offset and straight jaws.



QA-2309

VALVE DISC REMOVING TOOL

- Length... 275 mm



QA-2311

VALVE RETAINER RING PLIERS

- For removing valve stem seals on multi-valve-engines.
- Jaws hardened, longitudinally toothed.
- Working area dip-insulated avoiding damages of the timing gear.
- Straight design.
- Length... 250 mm



QA-2312

VALVE RETAINER RING PLIERS

- For removing valve stem seals on multi-valve-engines.
- Jaws hardened, longitudinally toothed.
- Working area dip-insulated avoiding damages of the timing gear.
- Bent 25°.
- Length... 241 mm



VSC-01

VALVE SPRING COMPRESSOR

- Compressor easily removes valve springs on most cars and light trucks.
- Works with cylinder head on or off the engine.



991025-01Q

VALVE SPRING COMPRESSOR

- Conveniently allows for removal of valve springs on most automotive and light trucks without removing cylinder head.
- Offset jaws easily grip and compress valve springs.
- Requires flexible air valve holders and air hold fittings to keep valves from dropping into cylinders when keepers are removed.



VG-2232

VALVE GRINDER

- Suction pads... DIA. 22, 32mm
- Length... 255mm



ATG-1097.

AIR OPERATED VALVE LAPPER



- Blows per minute(BPM)... 5600
- Exhaust... Bottom
- Air consumption(SCFM)... 10
- Length(MM)... 171
- Weight(KG)... 1.46
- Air pressure(PSI)... 90
- Air inlet... 1/4"
- Sucker heads(MM)... 20, 30, 35, 45
- Design for operating in tough environments.
- Adjustable speed regulator for precise control during operation.

QA-2305

VALVE GUIDE CLEANER



- Valve guides cleaned with this tool are really cleaned with no gum, no carbon and no scale left.
- Use manually or with 1/4" electric drill.
- Blades of flat spring stock are extremely flexible and give a fine cutting action.
- Correct tension for various guide hole sizes is regulated by the adjusting nut.
- Capacity... 5/16" to 5/8" (8 to 16mm)

QA-2328.

STRAIGHT TIP LOCK RING PLIERS



- Spread... 3/4" (19mm)
- Length... 8-1/4" (210mm)
- Tip... Flat, straight, serrated.
- Used to spread snap rings found on brakes, pedal shafts, transmissions, clutch shafts, machine tools, and some piston ring.
- Jaws are scored on outside for secure gripping.
- Drop forged alloy steel.

QA-2327.

ANGLE TIP LOCK RING PLIERS



- Spread... 3/4" (19mm)
- Length... 8-1/4" (210mm)
- Tip... Flat, angled, serrated.
- Used to spread snap rings found on brakes, pedal shafts, transmissions, clutch shafts, machine tools, and some piston ring.
- Jaws are scored on outside for secure gripping.
- Drop forged alloy steel.

QA-2140.

LOCK RING PLIERS



- Overall length... 220mm
- For removing and installing all types of lock rings.
- Specially designed jaws are knurled on the end to prevent slipping.
- Spreads lock rings commonly found on transmissions, brakes, master cylinders and other applications.

QA-2329.

SPECIAL SAFETY RINGS PLIER

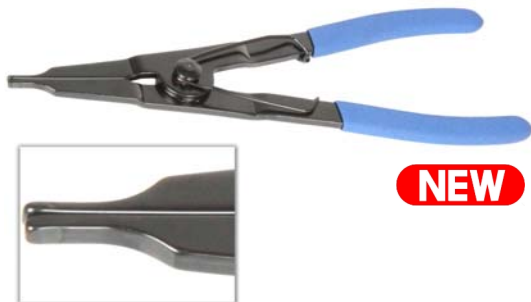

NEW

- Spreading... 5 - 40mm
- Length... 240mm
- Tip size... 2.4 × 4.2mm
- Tip... Straight, centerin g-rand, long, slim
- Deep, large rings on drive shafts and steering shafts.

P-2126.

14" HEAVY-DUTY LOCK RING PLIERS



Serrated Angled Tips Serrated Flat Tips



NEW

- Length: 14" (355mm). Spread: 3" (75mm)
- Serrated angled flat tips with retaining screws.
- Replaceable tips.
- Extra leverage from long spring loaded handles.
- Designed for heavy-duty service on external lock rings used in truck and tractor transmissions.

QA-2284

METRIC CLUTCH ALIGNMENT TOOL

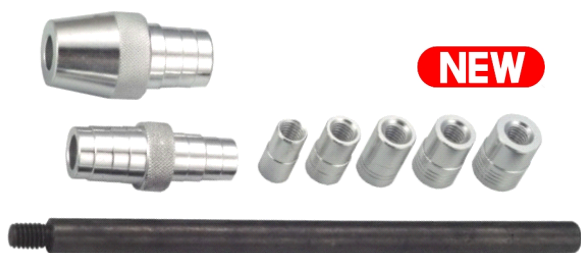

NEW

- For faster, easier replacement or repair of metric clutches.
- Tool consists of the shaft, ten pilot bushings and two plate alignment cones with graduated turned diameters for automatic fit of most metric clutch plates.
- A tapered cone to fit all other is provided.
- Size... 11.85, 13.85, 15.8, 16.7, 18.98mm.

QA-2285

CLUTCH ALIGNMENT TOOL



NEW

- Faster, easier replacement of clutches.
- Align clutch plates and pilot bearing accurately.
- Two turned size (1" and 1-1/8") fit 90% of the clutch plates and cone handles the rest.
- Shaft and bushings to fit 8 pilot bearing sizes... 0.587", 0.650", 0.673", 0.748", 0.787", 0.807", 0.981".

QA-2286

HEAVY DUTY CLUTCH ADJUSTING WRENCH



NEW

- For Spicer-built heavy-duty clutches.
- Used for the internal adjustment of Spicer angle-spring and multiple-lever clutches.

QA-2287

TRUCK CLUTCH SERVICE SET



- An ideal companion set to the clutch handler, this set lets you perform a variety of clutch and fly wheel service jobs on Spicer-Built heavy-duty cast and angle-spring clutches.
- Nine different tools help with everything from clutch installation and removal, to installing new drive pins in the flywheel, to proper adjustment of manual and self-adjusting clutches.
- Carrying/storage case included.

QA-2288

TRUCK CLUTCH ALIGNMENT TOOL



Item no.

Size

- | Item no. | Size |
|----------|--------------------------------------|
| QA-2288 | 1-1/2" O.D. 30mm pilot. Wt. 10 oz. |
| QA-2289 | 1-1/2" O.D. 1" pilot. Wt. 10 oz. |
| QA-2290 | 1-3/4" O.D. 1-1/4" pilot. Wt. 11 oz. |
| QA-2291 | 2" O.D. 1-1/4" pilot. Wt. 13 oz. |
| QA-2292 | 1-3/4" O.D. 1" pilot. Wt. 7 oz. |

- 10-spline shafts.
- Constructed of a lightweight fiberglass-reinforced nylon body that won't hang up in the clutch disc spines.
- Designed to provide a perfect fit to the spine of the clutch disc.
- Easily supports heavy pressure plates.

QA-2293

SELF-ADJUST CLUTCH ROTATING TOOL



- Replaces self-adjuster mechanism on Spicer self-adjust clutches.
- Allowing you to manually adjust them with a wrench or socket.

QA-2296

CLUTCH ALIGNER



- For clutch-hub Ø15 - 28 mm.
- As a result of parallel expansion technique it is possible to align the clutch plate to the pilot bearing in the crankshaft flywheel.
- Clutch assemblies no longer equipped with a pilot bearing in the crankshaft can be aligned with the cover plate using the new parallel expansion technique.
- The expanding segments expand in the same axis of both the tool body and the crankshaft, so that alignment of the clutch plate is possible relative to either flywheel or cover plate.

QA-2295

UNIVERSAL CLUTCH ALIGNMENT SET



- Clutch alignment and assembly.
- The vehicles equipped with late-model front wheel drives without pilot bear in flywheel.
- Size...
Small cone... Range 14.4 to 21 mm.
Large cone... Range 20.9 to 29 mm.

QA-2294

FLYWHEEL LOCKING TOOL

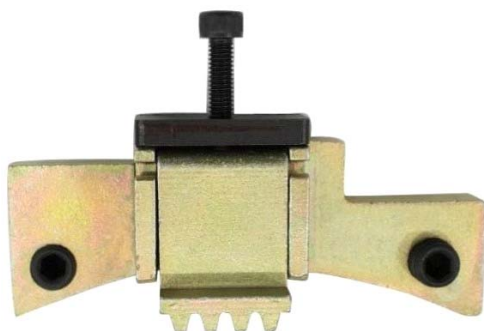

- To lock the flywheel when the gearbox is dismantled.
- Universal application.
- The tool can be adjusted axially and radially and can be used almost universally by screwing in different stud bolts.
- Bolt size... Ø10 × 35mm

QA-1662

REPLACEABLE OIL PAN SEPARATOR AND CLEANING SET



- Breaks gasket seals on engine sumps, transmissions or any difficult to separate gasket joints.
- The copper blade could avoid damage on gasket or oil pan connection joint surface.
- Clean cup wheel tool helps use to clean all small spaces on cylinder head.
- Contents...
 - 1_ Replaceable SK5 separator
 - 1_ Replace cooper blade
 - 1_ 2.5 mm allen key
 - 1_ Clean cup wheel tool
 - 15_ Additional cup wheels (3/4")

RCW-01

RADIATOR CAP WRENCH



- Removes all standard radiator caps.
- Allows extra torque required to free tight caps and applied easily & safety.

QA-2306

TDC TIMING DEGREE WHEEL (STEEL)

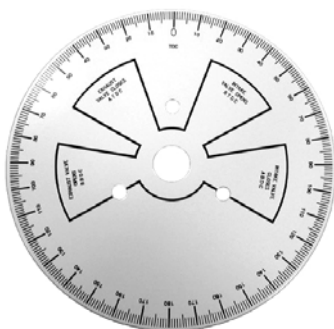

- 360° Timing degree wheel is designed for finding top dead center and checking camshaft timing.
- Three holes allow the wheel to securely fasten to the engine crankshaft.
- Use in conjunction with a dial gauge for correct intake and exhaust valve timing settings.
- Diameter... 9-1/16" (230mm)

QA-2307

TDC TIMING DEGREE WHEEL



Item no.	Diameter	Material
QA-2307	6-4/3" (171mm)	Steel
QA-2308	6-4/3" (171mm)	Aluminum

- 360° Timing degree wheel is designed for finding top dead center and checking camshaft timing.
- Use in conjunction with a dial gauge for correct intake and exhaust valve timing settings.

SKA-130

13PC COMBINED SOCKET SET FOR ALTERNATOR



- Contents...
- 2_ Combined socket for alternator... T50× 110mm (L), M10× 110mm (L)
- 2_ 15mm Hex × 33 teeth, 22mm Hex × 33 Teeth
- 1_ Special tool for Bosch System alternator... Dia.34.5× H15mm× 30 (L)
- 1_ Special tool for Renault system alternators... H22 × H22mm × 30 (L)
- 1_ 1/2"Dr. Bit adaptor
- 6_ 10×75(L)mm Bit, Size...Star T40,T50, Spline M8, M10, Hex H8,H10

SKA-220

22PCS COMPLETE KIT FOR ALTERNATOR PULLEYS



- Contents...
- 3_ Combined Socket for Alternator, 113mm(L), Size...T50, M10
- 3/8"Dr. × M10 × 80mm(L) with Dia.14 × 33T for Fiat.
- 1_ Bit socket M10 × 140mm(L)
- 3_ Teeth Socket... 15 × 19mm Hex × 33 teeth, 22mm Hex × 33 teeth, 15 × 17.5mm Hex × 33 teeth
- 2_ Hex socket ... 17, 22mm
- 3_ Hex socket ... 22 × 28mm, 19 × 28 mm, 21 × 28mm
- 1_ 35mm Round socket W/4 pins
- 1_ 38mm Hex socket W/3 Pins
- 1_ 1/2"Dr. Sq. (F) × 10mm Hex. (F) Bits adaptor
- 1_ M10 × H12 × 64(L) Bit
- 6_ Bit, 10(Hex Shank) × 75mm(L), Size...T40, T50, M8, M10, H8, H10

SPW-401-06

STUD PULLER WRENCH



Item No.	Driver	Size
----------	--------	------

- SPW-401-06 1/2" 6mm
- SPW-401-08 1/2" 8mm
- SPW-401-10 1/2" 10mm
- SPW-401-12 1/2" 12mm
- Made of chrome vanadium
- Special designed for using on screw damaged or without head to screw up and pull up.

SPW-401

4 PCS STUD PULLER WRENCH



- 1/2" Dr., Size... 6, 8, 10, 12 mm
- Made of chrome vanadium.
- Special designed for using on screw damaged or without head to screw up and pull up.
- 1 set / blow case.

QA-2138

8PCS STUD REMOVER AND INSTALLER SET (METRICS)



- Contents...
- 4_ Installer, Size... M6×P1.00, M8×P1.25, M10×P1.25, M10×P1.5
- 4_ Remover, Size... M6×P1.00, M8×P1.25, M10×P1.25, M10×P1.5
- Removes and installs studs without damaging threads.
- Includes the most common stud sizes in metrics.
- Special steel ball design provides energy-saving way of installing new studs.

QA-2139

11PCS STUD REMOVER AND INSTALLER SET (SAE)



- Contents...
 - 5_ Installer, Size... 5/16"×18, 5/16"×24, 3/8"×16, 3/8"×24, 7/16"×14
 - 5_ Remover, Size... 5/16"×18, 5/16"×24, 3/8"×16, 3/8"×24, 7/16"×14
 - 1_ 6mm Allen key
- Removes and installs studs without damaging threads.
- Includes the most common stud sizes in standard sizes.
- Special steel ball design provides energy-saving way of installing new studs.

QA-1661

TWIST AXLE SPINDLE RETHREADING SET

1/2" DR. Ratchet driver



OR 27mm Spanner



- Contents...
 - 8_ Die, SCM440 HRC 45°-48°, Size...
 - M20 × P1.25, M20 × P1.5,
 - M22 × P1.00, M22 × P1.5,
 - M24 × P1.50, M24 × P2.00,
 - 13/16"×20 UNEF, 3/4"×20 UNEF
 - 1_ Wrench, S45C HRC 38°-43°, with 27mm hex for dies
- This tool set for rethreading damaged or rusted threads on axle spindles.
- Twist shape on inner rings of the dies offers better rethreading results.
- Eight dies cover the most commonly used sizes for axle spindles on market.

QA-2349

MULTI-PURPOSE INNER TIE ROD TOOL

NEW



- | Item no. | Capacity |
|----------|-------------|
| QA-2349 | 33 to 42 mm |
| QA-2350 | 41 to 49 mm |
- 1/2" square driver.
 - Designed specifically for removal the inner tie rods.
 - Replace inner tie rod ends, without removing the rack.

QA-2314

TIE ROD ADJUSTING TOOL



- Permits 360° rotation of sleeve for required adjustment.
- Four-position feature fits you locate tool to grip sleeve properly, even when access is limited.
- Universal services most models of impact and standard-size passenger cars and light truck.

QA-2343

AXLE POPPER KIT

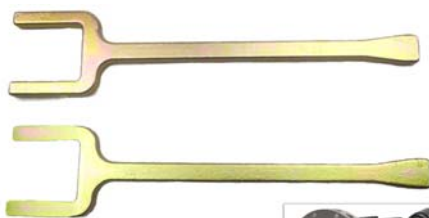

- Safer than a pry bar - forked end applies even pressure to both sides of the shaft for release of the shaft.
- Strike the wedge or use it as a pry bar to release the half shaft with tapered ends.
- Shim included to fill the gap between the half shaft and transaxle.

QA-2137

9PCS SCREW NUT EXTRACTOR SET

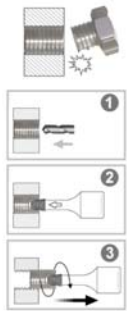

NEW

- Material... #8660 steel, HRC 49° - 52°
- Contents...
 - 6_ 3/8"Dr. Size... 2, 3, 4, 5, 6, 7 mm
 - 3_ 1/2"Dr. Size... 8, 10, 12 mm
- Set for removing worn or rusty inner hex bolt by drilling a hole.
- Tool with square drive to work with a ratchet wrench for additional torque.
- ▲ Product NOT designed for air/impact wrench operation.

TD-40H

40PCS TAP AND DIE SET



- High Carbon Steel, Metric size .
- Contents...
 - 34_ Tap and Die, size... M3×0.5, M3×0.6, M4×0.7, M4×0.75, M5×0.8, M5×0.9, M6×0.75, M6×1.0, M7×0.75, M7×1.0, M8×1.0, M8×1.25, M10×1.25, M10×1.5, M12×1.5, M12×1.75, 1/8NPT27.
 - 1_ Tap wrench... M3 to M12
 - 1_ T-Type tap wrench
 - 1_ Die stock 25mm
 - 1_ Screw driver
 - 1_ Screw pitch gauge

QA-1734

BOLT PITCH GAUGE



- Material... ABS
- Dimension... 195(L) × 70(W) × 6(T)mm
- For fast checking a bolt, stud or screw's pitch, length and diameter.
- Includes most common sizes in metrics and SAE.
- For male parallel bolts, studs and screws.
- Convenient tools avoids incorrect bolt, stud or screw installation.

P-152RT

REVERSIBLE SAFETY WIRE TWISTING PLIERS

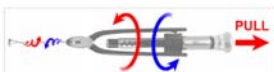

Item no. Size

- P-152RT 6"
- P-228RT 9"
- Reversible switch from right-handed(clockwise) t left-handed (counterclockwise).
- CR-V steel body, tapered nose with side cutter.

P-152T

SAFETY WIRE TWISTING PLIERS



NEW



Item no. Size

- P-152T 6"
- P-228T 9"
- CR-V steel body, tapered nose with side cutter.

WH-110

11PCS ADJUSTABLE HOOK AND PIN SPANNER WRENCH SET

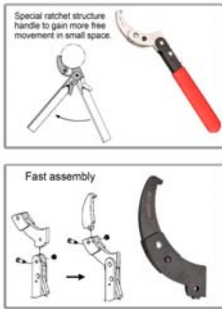

- Special ratchet structure handle to gain more free movement in small space.
- Specially designed for use with slotted retaining rings.
- Material... Carbon steel
- The range from 3/4" to 6-1/2"
- Two type... Pin and Hook for operating.
- Available in 4 size...
19-51mm (3/4" to 2"), 51-77mm (2" to 3"),
51-121mm (2" to 4-3/4"), 115-166mm (4-1/2" to 6-1/2")

QA-1911

UNIVERSAL EXTENDER ADAPTER



- The universal extender adapter can loosen tight connection of Hex, Star.
- Can use Socket or 3/4" Dr. ratchet be a handle.

QA-1732

1/4" - 3/8" EXTENSION RATCHET DRIVER

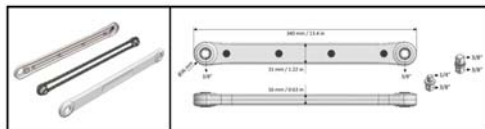

- Provided with two square drive adapters in 1/4" and 3/8".
- 340mm(13.4") length extension drive bar enables work in confined spaces easier.
- Chain-driven mechanism enhances working durability and smoothness.
- Max torque allowed... 71.87 Nm(53 ft- lb)
- Body material... Aluminum
- Adapter... SCM440 steel, HRC 42° - 45°

QA-1683

UNIVERSAL BELT TENSIONER WRENCH SET



- A comprehensive set of 13 wrench adapters and extension handle with locking system.
- Specially designed for use in very confined spaces.
- For releasing the bolts used on Tensioner, Timing, and Auxiliary Pulleys.
- 13 pcs wrench, Size...
Double ended... 12, 13, 14, 15, 16, 17, 18, 19 mm
Single ended... E10, E12, E14, E16, E18

QA-2315

POWERBAR HAND IMPACT WRENCH



- Remove and replace Harmonic Balancer Pulleys.
- Up to 600 ft/lb of torque.
- Applications include pulleys, flywheels, couplings, flanges, lawn mower base plate, etc.



QA-2360

3PCS LIGHT DUTY PRY BAR SET

NEW

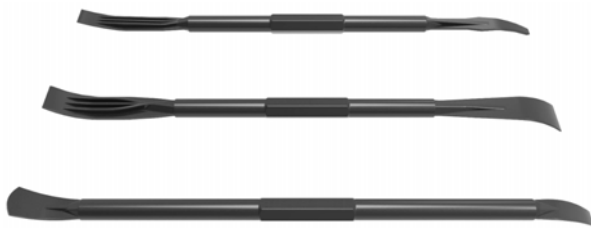

- Material... Composite
- Suitable for a variety of uses on phones, tablets and other electronic devices.
- Can also be used to help remove trim clips, oil seals, grommets etc on motor vehicles.
- Length... 185mm, Double ended pry bar, Width... 7.5 × 3.6mm, 10.2 × 12.5mm, 10.1 × 7.3mm

CSC-270

DROP FORGED COIL SPRING COMPRESSOR



- Max. jaw opening... 270mm
- Body... S45C, HRC 38° to 42°, Black finish
- Jaws... S45C, HRC 38° to 42°
- Drop forged carbon steel jaws & lead screws, both heat treated ensure you obtain professional job performance.
- The tool is designed for use in limited space under wheel arch.
- Jaws design is fitting to wrap coil claws for safety.

CSC-600

PROFESSIONAL STRUT COIL SPRING COMPRESSOR (CASTING)



- Size... 300mm(L)
- Works with springs up to 6" outside diameter & wire diameter of a max. of 5/8" UNC
- Safely & easily compress coil springs not accessible from the center of the coil.

QA-1735

3 PCS COIL SPRING CLAMP SET



- Size... 5/8"-11 UNC x 300 mm(L)
- Suitable for most passenger vehicles.
- Overall length 300 mm
- Contents...
3_ Coil spring clamp
1_ Oil bottle

QA-1771

14PCS SHOCK ABSORBER TOOL KIT



- Specifically designed for repairing and replacing shock absorbers.
- CR-V steel, Chrome plated, Contents...
1_ 21mm Hex Go-through ratchet handle
1_ Sliding T-bar
2_ Slot bit socket, Size... 5×8, 6×8mm
3_ Hex bit sockets, Size... 6, 7, 8mm
7_ Go-through deep sockets, Size... 16, 17, 18, 19, 21, 22, 24mm
- ▲ Examples of use include...
• 6mm Hex and 8mm Hex used on MercedesBenz with 19mm socket.
• 8mm Hex for BMW combined with appropriate socket.
• 7mm for GM/Vauxhall combined with appropriate socket.
• Slot bit socket combined with 17mm socket used on VW,Audi models.

QA-1741

UNIVERSAL SEAL INSTALLER

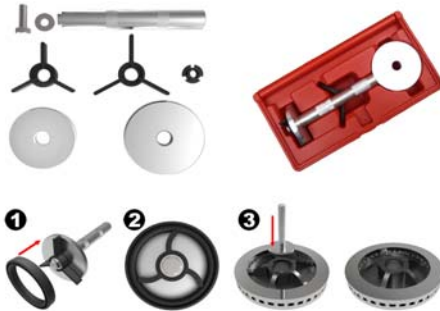

- Applicable... 32 - 60mm(1 1/4 - 2 3/8")
- The arms of the spider keep the seal centered during installation.
- Another benefit to this tool is the spider can be trimmed to fit seals.
- Long handle provides good flexibility when installing the pinion seals.
- Contents...
 - 2_ Driver, Size... 76mm(3"), 63mm(2.5")
 - 1_ Spider insert
 - 2_ Spider, Size... Large, Small
 - 1_ Handle
 - 1_ Hex cap screw
 - 1_ Washer

QA-1742

UNIVERSAL SEAL INSTALLER

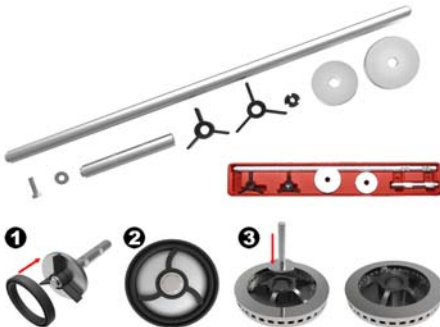

- Applicable... 32 - 60mm(1 1/4 - 2 3/8")
- The arms of the spider keep the seal centered during installation.
- Another benefit to this tool is the spider can be trimmed to fit seals.
- Long handle provides good flexibility when installing the pinion seals.
- Contents...
 - 2_ Driver, Size... 76mm(3"), 63mm(2.5")
 - 1_ Spider insert
 - 2_ Spider, Size... Large, Small
 - 2_ Handle, Size... Short, Long
 - 1_ Hex cap screw
 - 1_ Washer

QA-1743

UNIVERSAL SEAL INSTALLER



- Applicable... 27-60mm(1 1/8 - 2 3/8")
- The arms of the spider keep the seal centered during installation.
- Another benefit to this tool is the spider can be trimmed to fit seals.
- Long handle provides good flexibility when installing the pinion seals.
- Contents...
 - 1_ 76mm(3") Driver
 - 1_ 63mm(2.5") Driver
 - 1_ 45mm(1.7") Driver
 - 1_ Handle

QA-1676

ADJUSTABLE BELT INSTALLING TOOL SET

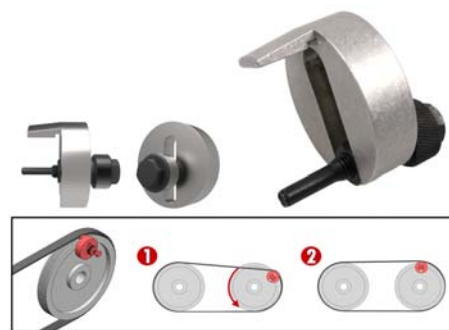

- Special designed set of tools for installing the new belt onto the pulley.
- Applicable... FORD, MAZDA, VOLVO, BMW, CHRYSLER, CITROEN, FIAT, LANCIA, ETC...

QA-1677

STRETCH BELT REMOVER /INSTALLER

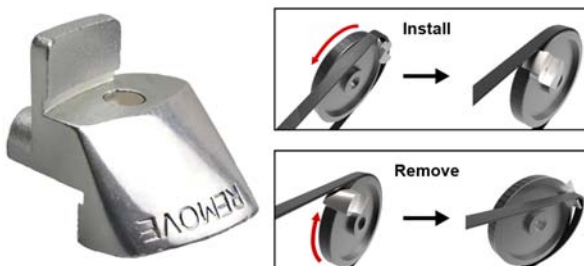

- Combination removal and installation tool for most stretch belt applications found on many accessory drive systems.
- Unique magnetic faces hold the tool in place on the pulley.
- Helps prevent damage to belt or pulley during removal or installation.
- One-piece tool can be used on the front or back side of the pulley.

QA-2347

THIN WALL OXYGEN SENSOR SOCKET



NEW



- Removes and installs 7/8" (22mm) oxygen sensors.
- 1/2" square drive and 1" hex drive, Tapered end OD... 28.60mm
- Overall length... 89.6mm, Oxygen sensor opening length... 71mm

QA-2348

THIN WALL OXYGEN SENSOR SOCKET



NEW



- Removes and installs 7/8" (22mm) oxygen sensors.
- 3/8" square drive and 1" hex drive, Tapered end OD... 29.8mm
- Overall length... 80mm, Oxygen sensor opening length... 63mm

QA-2143

8PCS SLOTTED SOCKET SET



NEW



- Contents...
 - 3_ 3/8"Dr. × 6PT × 46mm(L), Size...10, 11, 12mm
 - 2_ 3/8"Dr. × 6PT × 64mm(L), Size...13, 14mm
 - 3_ 1/2"Dr. × 6PT × 78mm(L), Size...17, 19, 21mm
- For the assembly of top and side wired temperature sensors, thermo switches and other components.
- Also suitable for nuts and bolts of bent pipes.
- The slot width is...
 - 7.4 mm(10), 8.8 mm(11), 9.1mm(12), 10.5 mm(13), 10.8 mm(14), 13.3 mm(17), 14.4mm(19), 15.5 mm(21)
- With socket rail.

QA-2144

5PCS STRUT NUT SOCKET SET



NEW



- 1/2"Dr., CR-V steel, Size... 18, 19, 21, 22, 24 mm
- Allows 90° hex key to hold the strut whilst tightened to correct torque with a torque wrench (Hex key not supplied).
- Covers most popular sizes for European vehicles.
- With socket rail.

QA-2145

6PCS EGT SENSOR SOCKET SET



NEW



- Contents...
 - 3_ 3/8"Dr. Deep socket, Size...13, 14, 17mm
 - 3_ 3/8"Dr. Shallow socket, Size...13, 14, 17mm
- The 3 different sizes and two different style will remove most exhaust temperature sensors in the market.
- This set of sockets is designed to drive all 6 sides of the hex equally to reduce the chance of damage.

QA-2319

EXHAUST PIPE FLARING TOOL

NEW



- For easy installation of mufflers and pipes.
- Conical exhaust pipe flaring tool facilitates easy flaring of exhaust tailpipes.
- Professional adjustment of inaccuracies of fit due to pipe deformation or tolerances of pipe diameters due to production.
- Easy installation of all exhaust pipe elements by plug connections.
- Reforming Range... DIA. 30~80mm
- Total Length... 240mm
- Material... S45C, HRC 44°~46°

QA-2320

EXHAUST PIPE FLARING TOOL

NEW



- For easy installation of mufflers and pipes.
- Conical exhaust pipe flaring tool facilitates easy flaring of exhaust tailpipes.
- Professional adjustment of inaccuracies of fit due to pipe deformation or tolerances of pipe diameters due to production.
- Easy installation of all exhaust pipe elements by plug connections.
- Reforming Range... DIA. 41~57mm
- Total Length... 240mm
- Material... S45C, HRC 44°~46°

QA-2135

EXHAUST HANGER REMOVAL PLIERS

NEW



- Tool for removing exhaust pipe hangers.
- Adjustable head pin provides a wide application.
- Large body length 367mm(14 1/2") offers extra leverage for an energy-saving operation.



QA-2142

EXHAUST HANGER REMOVAL PLIERS

NEW



- Overall length... 300mm
- Tool for removing exhaust pipe hangers.
- Simply squeeze the plier handles to force the bracket from the rubber support.



QA-2316

DOUGHNUT STRETCHER



- One end features an offset hook.
- For easy removal, use to grab onto the rubber mounting rings or "doughnuts" used in many exhaust systems.

QA-2317

EXHAUST AND TAILPIPE CUTTER



Item no.	Length	Capacity(Diameter)
QA-2317	270 mm	3/4" to 3" (19 - 76 mm)
QA-2318	340 mm	3/4" to 6" (19-152 mm)

- Only 1/4 turn is needed for a complete cut.
- Serviceable tool works in hard-to-reach areas.
- It will not cut double-wall pipes. Keep well oiled. Not for use on stainless steel.

QA-2336

UNIVERSAL HUB PULLERS



- For all cars and commercial vehicles.
- Fits hub circles up to Ø250mm.
- Revolving end parts of legs ensure that no damage can be done to studs, axle or inner parts of the wheel.

QA-2331

WHEEL STUD REMOVER / INSTALLER MASTER KIT



- Determine which removing adapter fits the wheel stud.
- Insert the adapter into C-frame.
- Position the C-frame and adapter on a wheel stud.
- Tighten the forcing screw until it meets the stud and check the alignment of all tooling and components.
- Continue tightening the forcing screw (using an impact wrench if necessary) until the wheel stud is removed from the hub.
- Contents...
 - C-frame / Forcing screw assembly.
 - Removing adapter, Size... 33.9mm, 40.8mm
 - Receiving cup, Removing pin, Installing adapter.

QA-1739

VEHICLE WHEEL STUD INSTALLER



- Use with a ratchet or impact wrench to pull the new stud securely in place.
- Position the tool over the stud shaft.
- Tighten the lug nut against the tool to pull the stud in place.
- Works on most all automotive and light-duty truck wheel studs, import and domestic.
- Note...
 - The bearing will wear with use and is not warranted.

QA-1740

TRUCK WHEEL STUD INSTALLER



- Use with a ratchet or impact wrench.
- The tool body is equipped with a thrust bearing to easily pull the new wheel stud into place.
- Fits truck wheel studs up to 22mm (7/8") in diameter.
- Use the lug nut to tighten against the tool body to pull the stud in position.
- Note...
 - The bearing will wear with use and is not warranted.

QA-2433

STUD CLEANING TOOL

NEW



- Faster and easier to clean studs.
- Only need one tool to fit different sizes of brush.
- Quick change brushes.
- Come with a 1/2" drive adapter and six brushes.
- Brush size... 12mm (7/16"), 13mm (1/2"), 14mm (9/16"), 16mm (5/8"), 22mm (7/8"), 28mm (1-1/8")

QA-2434

STUD CLEANING & HUB GRINDING TOOLS

NEW



- Faster and easier to clean wheel studs and wheel hub.
- Quick change brushes and grinding pads.
- Only need one tool to fit different sizes of brush and grinding pad.
- Can be operated by cordless drill or impact wrench.
- Brush size... 13mm, 18mm (Do not exceed 1,800 rpm)
- Hub grinding pad... Ø23mm × 3pcs, Ø15mm × 2pcs (Do not exceed 8,000 rpm)

QA-2435

STUD CLEANING & HUB GRINDING TOOLS

NEW



- Faster and easier to clean wheel studs and wheel hub.
- Quick change brushes and grinding pads.
- Only need one tool to fit different sizes of brush and grinding pad.
- Can be operated by cordless drill or impact wrench.
- Brush size... 14mm, 22mm (Do not exceed 1,800 rpm)
- Hub grinding pad... Ø23mm × 3pcs, Ø15mm × 2pcs (Do not exceed 8,000 rpm)

QA-2334

WHEEL HUB RESURFACING KIT



- Size... Ø38mm
- The tool fits you power drill.
- Usable on most vehicles with either front or rear disc brakes.
- Rust build-up on brake rotors can cause warping, and that causes pulsation and diminished braking.
- This kit attacks the rust on lug studs and rotors on the hub assembly faster and easier than anything you've used before.

QA-2335

WHEEL HUB/STUD RESURFACING KIT



- Use with your power drill to easily and quickly remove rust from hub face, wheel lug studs and rotors. Helps prevent rotors from warping.
- 3000 RPM
- Contents...
 - 1_ 1/4" shank drill adapter,
 - 3_ Hook and loop backing pads.
 - 5_ Coarse sanding discs, Size...Ø 1-1/2"(38mm) x 5/8"(T)
 - 5_ Fine sanding discs, Size...Ø 1-1/2"(38mm) x 5/8"(T)

QA-2358

WHEEL HUB HOLDING TOOL



NEW

- Designed for use on vehicles with 4 stud, 5 stud, 6 stud and 8 stud patterns flanges and hubs where access permits.
- Applications include... Wheel Hubs, Drive flanges, Gear box output drive flanges, Differential input and output flanges.
- Non-slip plastic dipped handle.
- Can also be used to hold rear differential yokes on solid axle vehicles during bearing service.
- Can also be used with a 1/2" drive power bar or Torque wrench. Remember to make allowance for the additional length of the tool.

QA-2359

WHEEL LOCKING NUT REMOVAL KIT



- Description...
- 8_ Conical dismantling sockets, Length 60mm (consumable), CR-MO steel, Inner diameters...
18.5 - 15.6mm, 19.5 - 17.6mm, 20.4 - 18.5mm, 21.6 - 19.7mm, 22.5 - 20.6mm, 23.6 - 21.7mm, 24.5 - 22.6mm, 25.5 - 23.6mm.
- 1_ Air hammer adaptor allows use air hammer if required.
- 1_ Manual fitting tool
- 1_ Removal punch

NEW

QA-2332

GREASE CAP PLIERS



- Grease and hub cap tool.
- Tapered jaws of the tool fit behind the crimped edge of the grease cap preventing damage while removing it from the hub.
- Opposite end handle hook removes wheel hub caps.

QA-2333

GREASE DUST CAP PLIERS



- Grease and dust cap tool.
- Tapered jaws of tool fit behind the crimped edge of dust cap.
- One handle is designed for prying hub cap loose.

QA-2432

STICK-ON WHEEL WEIGHT TOOL



NEW

- Easy and quick to remove stick-on wheel balancing weights.
- The plastic cover on the jaws and hammer can protect the alloy rims from damaging or scratching.
- Adjustable jaws for different types of wheel weight.

QA-1098

MAGNETIC CAMBER GAUGE



- Straight type.
- It has a simple leveling adjustment of $\pm 3^\circ$.
- Vials housed in a durable non-magnetic casing with a magnetic head that attaches firmly to rotors or spindles.
- Accurate camber measuring tool for use after repairs or replacement of struts, wheel assemblies etc. for cars and trucks.

QA-1099

MAGNETIC CAMBER GAUGE



- Swivel type. Gauge can be preset at angle 0° to 90° .
- It has a simple leveling adjustment of $\pm 3^\circ$.
- Vials housed in a durable non-magnetic casing with a magnetic head that attaches firmly to rotors or spindles.
- Accurate camber measuring tool for use after repairs or replacement of struts, wheel assemblies etc. for cars and trucks.

QA-2330

SNAP IN TIRE VALVE INSTALLER



- Steel constructed tool with deep threaded head for positive sealing of all snap-in type passenger car tire valve stems.

970103-01A

TIRE VALVE TUBE SCREWDRIVER

Item No. Blade Length

- 970103-01A 125 mm
- 970103-01B 160 mm
- Blade material... CR-V, Handle material... NYLON
- Torque... 0.45Nm



QA-1687

TIRE TREAD DEPTH GAUGE



- Glare-free reading.
- Measuring depth 30 mm.
- Graduation in 0.1 mm steps for an exact determination of the tread depth.
- Light weight and easy handling.
- Very robust - made of hard brass.

QA-1678

3 JAWS ADJUSTABLE FUEL TANK LID WRENCH



- Operation range... Ø100 - 170mm
- An innovative tool for the removal and fitting of fuel gauge sender collars.
- Adjustable to suit for most collars from 89 to 170mm.
- Lock in place and then turn with a 16mm wrench or socket.
- A damage free method of removing & re-fitting collars.

QA-1738

FUEL TANK SENDER WRENCH SET

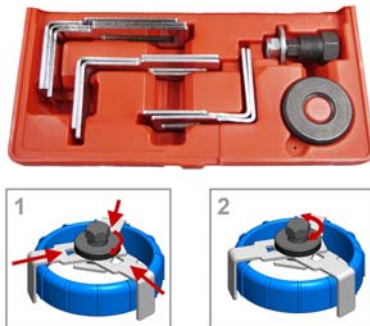

- Drive... 24 mm
- Size range... 75 - 160 mm, 80-122 mm, 110-170 mm
- Select two or three jaw.
- Contents...
 - 3_ Claws 75-160mm
 - 2_ Claws 80-122mm
 - 2_ Claws 110-170mm
 - 2_ Screw, Fixed and Adjust screw

QA-1761

7PCS AUTO REPAIR TOOL KIT



- Contents...
 - 6_ Bits, CR-V #6150, Size...
 - PH #2 screwdriver bit, SL 6mm screwdriver bit
 - Valve core remover, Door upholstery remover
 - Gasket scraper, Battery screwdriver
 - 1_ Dual color handle

PWP-01

PLUG WELD PLIERS



- Clamp and supports weld area to assure professional results.
- Copper swivel pad eliminates the problem of burn through.
- U shaped moveable jaw provides even clamping pressure.

QA-2190

BULB PLIERS



- Works on a vast array of miniature style bulbs commonly used in automobiles, boats, airplanes, pinballs, arcade / video games, vending machines, coin-op equipment and a multitude of electronic devices.
- Great tool for those hard to reach bulb locations.
- Safely removes bulbs, fits where fingers can't.
- Cup-type ends create circular gripping area.
- Rubber coated gripping area for secure and safe use.

QA-1428

RELAY PLIERS



- For safe installing and removing of relays, even small ones.
- Jaws made of special steel.
- Pliers with solid plastic body.
- Suitable for OPEL, FORD, MAZDA, CHRYSLER, NISSAN, VW passenger cars, MERCEDES-BENZ, MAN, IVECO commercial vehicles.

QA-1429

BENT RELAY PLIERS



- For installing and removing staggered relays.
- 60° Jaws made of special steel.
- Pliers with solid plastic body.
- Suitable for OPEL, RENAULT and NISSAN.

FS-583

FIN STRAIGHTENER



- For 8", 9", 10", 12", 14", 15" spacings per inch.

BPT-01

BATTERY TERMINAL PULLER

One touch push open jaw

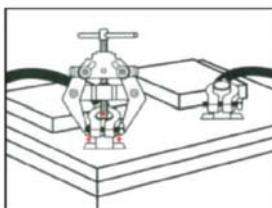

- With one-touch push open jaw
- The tightest terminals will be lifted off without damage to the battery case or posts.
- The centre screw swivel also makes this puller very effective on alternator bearings.

BBC-150

150 AMP BATTERY BOOSTER CABLE



- Size... 0.2mm × 81S × 9mm × 2.5M

BBC-200

200 AMP BATTERY BOOSTER CABLE

- Size... 0.25mm × 81S × 10mm × 2.5M



BBC-300

300 AMP BATTERY BOOSTER CABLE

- Size... 0.3mm × 120S × 10mm × 2.5M



BBC-400

400 AMP BATTERY BOOSTER CABLE

- Size... 0.3mm × 112S × 10mm × 2.5M



QA-2355

WINDSCREEN WIPER ARM REMOVAL TOOL

- Size... A: 15.5mm, B: 26mm
- Suitable for spline taper and tapered spigots.
- The special design offers easy access in confined space and eliminates the risk of damage to the wiper arms.
- A simple, effective tool allowing easy removal the stubborn wiper arms.



QA-2356

WIPER ARM PULLER

- Size... A: 26mm, B: 39mm
- The special design offers easy access in confined space and eliminates the risk of damage to the wiper arms.
- A simple, effective tool allowing easy removal the stubborn wiper arms.

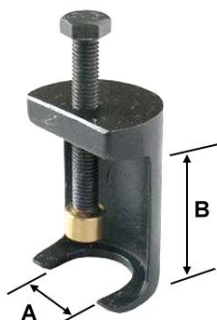

QA-2357

UNIVERSAL WIPER ARM PULLER



NEW

- The universal wiper arm puller is a simple tool with adjustable arms which makes a tricky task easier without risk of damage to the wiper arm.

QA-2136

WIPER ARM PULLER SET



NEW

- Universal application and for both front and rear wiper arms Include 4 cup remover and 1 puller.
- Stud on cup removers is adjustable, widening the application range.
- Puller is suitable for limited spaces as the legs can be adjusted according to different widths.
- Contents...
 - 1_ Puller
 - 4_ Cup remover, Size... Ø30, Ø35, Ø40, Ø46 mm



QA-2361 **NEW** 3PCS NON -MARRING PICK SET

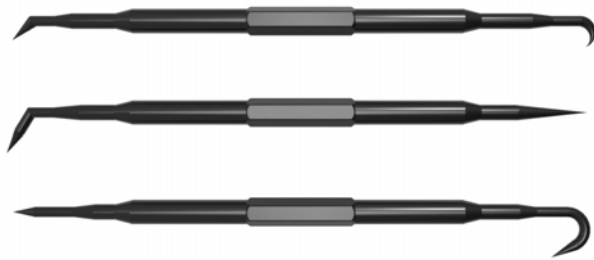

- Overall Length... 165mm
- Strong glass reinforced nylon offers great blend of flex ibility and strength.
- Won't be rust or oxidize like metal picks and probes.
- Composite tips provide unique geometries to access difficult to reach access panels, removing/manipulating O-rings, small seals/gaskets, clips, cleaning air vent assemblies, cleaning tight gaps in interior components, handling delicate wiring, composite electrical connectors, etc.
- This non-marring composite material will not scratch soft metals, paint or composites.
- Perfect tools for interior/exterior automotive detailing.

QA-1421 12PCS MINI PICK AND HOOK SET (WITH MAGNET)



- Blade material... Stainless steel
- Set contains 12 different type picks and hooks and packaged in storage pouch.
- The long grip handles provide comfort and control while using, the top magnets increase its multi-purpose.
- Used in many ways around the vehicle from seals to cotter pin removal, cleaning nocks and crannies, bushing, O-ring removal, alignment, scribing, piercing holes in leather or fabric, etc.

QA-1423 6PC RADIATOR HOSE PICK SET



- Carbon steel blade, PP+TPR handle.
- Hose pick contents... 2pcs 5", 1pc 6", 2pcs 11", 1pc 12"
- Removes radiator hose from clamps and fittings.
- 6 Unique shapes for pulling clips, rings, wires, gaskets, washers & other small parts.
- Unique blade shapes are good for getting around obstacles such as firewall applications with tight access.
- Extra long blade length makes access to lower radiator hoses safer and easier.

QA-1424 3PC EXTRA LONG PICK AND HOOK SET

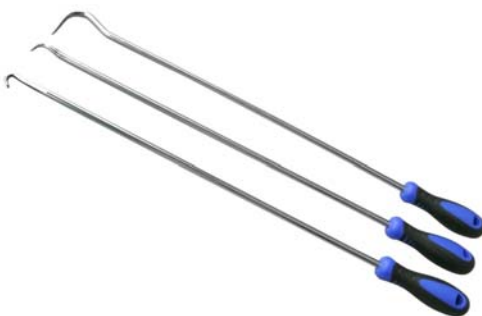

- Large 5/16" (8mm) shaft diameter for added strength, CR-V steel blade, high-polished chrome plated finish.
- Total length... 575 mm, PP+TPR handle.
- Contents... Pulling hook, picking hook, grabbing hook
- Suitable for long cotter key puller, cotter pin extractor, brake spring puller, hook pick.
- Ergonomic design handle increases torque and provides comfort while reducing fatigue.

QA-1422 6PC PICK AND HOOK SET



- Large 5/16" (8mm) blade diameter for added strength, CR-V steel, high-polished chrome plated finish.
- Total length... 230 mm, PP+TPR handle.
- Contents... Straight, Hook, Combination, Dual Angle, 45°, 90°
- Ergonomic design handle increases torque and provides comfort while reducing fatigue.

QA-1420

4PC EXCHANGE HOOK AND PICK SET

- CR-V steel blade, 176 mm(L), PP+TPR handle.
- Contents...
Hook pick, 90° hook pick, Straight pick, Complex pick.



QA-1419

5PC EXTRA LONG HOOK AND PICK SET

- 193mm long knurled steel non-slip handle with removable end-cap holds picks inside when not in use.
- Contents...
4_ 165mm(L), Tips... Straight, 90°, Hook, Combination
1_ 400mm(L) Telescopic magnetic pick up tool, Capacity 3 lb.



QA-1418

5PC HOOK AND PICK SET

- 126mm long knurled steel non-slip handle with removable end-cap holds picks inside when not in use.
- Contents...
4_ 83mm(L), Tips... Straight, 90°, Hook, Combination
1_ 400mm(L) Telescopic magnetic pick up tool, Capacity 3 lb.

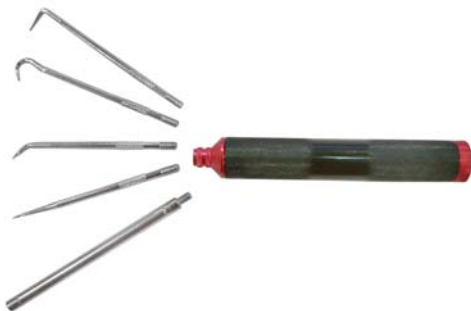

QA-1426

MASTER SEAL REMOVER & SOFT HOSE PICK SET

- Blade material... SCM 440 steel
- Easily remove seals or O-rings or pick soft hoses on vehicle.
- Provided with different length and angle fits wide applications.
- Angled blade is ideal for removing seals in limited space.



QA-1425

3PCS SEAL PULLER

- Length... 165, 117, 150mm
- Quickly and easily remove O-Ring or grease and oil seal.
- Special angle on the tool head provides a better work than traditional seal pullers.
- 3 different lengths and tips fit nearly all seal applications.
- Simple insert the tool tips, press and pull.





QA-2313

ADJUSTABLE SEAL PULLER



- Head Adjusts to 5 Positions.
- Two hook sizes easily remove most oil and grease seals.
- Where clearance is a problem, remove the pin to reposition the head.
- The adjustable head works great on front wheel drive transaxles.
- Also works on front crankshaft seals without removing the radiator.

QA-1298

5PC UTILITY TOOL SET



- Blade material... Carbon steel, HRC 40° to 45°
- Handle material... PP+TPR
- Contents...
- 1_ Short-Blade scraper, 7/8"(W) × 8" (203mm)(L)
- 1_ Carbon scraper, 1/2"(W) × 12" (305mm)(L)
- 1_ Long-Blade scraper, 7/8"(W) × 12" (305mm)(L)
- 1_ Cotter key puller 9" (229mm)
- 1_ 90° Large pick & Hook, 8-1/2" (216mm)(L)

QA-1297

5 PC BLADE SCRAPERS



- Blade material... Carbon steel, HRC 40° to 45°
- Handle material... PP+TPR
- Contents...
- 1_ Long-Blade scraper, 7/8"(W) × 12" (305mm)(L)
- 1_ Carbon scraper, 1/2"(W) × 12" (305mm)(L)
- 1_ Blade scraper, 3/4"(W) × 12" (305mm)(L)
- 1_ Short-blade scraper, 7/8"(W) × 8" (203mm)(L)
- 1_ Scraper, 1/4"(W) × 12" (305mm)(L)

KS-1027

27 PCS KNIFE & SCRAPER SET



- Contents...
- 1_ Interchangable handle, Alum. cap, T.P.R.+ PP grip
- 1_ Utility knife.
- 5_ Knife blade
- 20_ Scraper blade, SK-5 steel, HRC 60° - 64°

HRK-121

WINDOW SCRAPER



- Blade material... SK5
- For removing paint, sealant, and decals, etc.

QA-1299

ERGONOMIC HANDLES STICKER SCRAPER

- Ideal for removing stickers, decals and paint from glass surfaces.
- Blade material... K7
- Ergonomic handle design.
- With 5 pcs spare blades.



HRK-101

STAINLESS STEEL SCRAPER

- Stainless steel blade, wooden handle.
- Size... 10mm



HRK-102

STAINLESS STEEL SCRAPER

- Stainless steel blade, wooden handle.
- Size... 15mm



HRK-103

STAINLESS STEEL SCRAPER

- Stainless steel blade, wooden handle.
- Size... 23mm



HRK-3030

3 PCS STAINLESS STEEL SCRAPER SET

- Stainless steel blade, wooden handle.
- Size... 10, 15, 23 mm



QA-2083 **NEW** AUTO-FLEXING LINE SOCKET SET



- Made of S50C, Max. torque... 30Nm
- 3/8"Dr., Size... 11, 13, 14, 15, 17mm
- The auto-flexing fuel line sockets can be reach outward fuel line nut in narrow space.
- These sockets have 45° of freedom to reach onto the direct fuel line nut quickly and easily.
- In addition to be auto-flexing function, the socket can tight the nut without losing torque.

QA-2341 **FUEL AND AC DISCONNECT PLIERS**

NEW



- The pliers' forks have different sized openings so the tool can be turned around to fit single or two step collar designed connector lines.
- The pliers can also be used to reconnect stubborn lines or connections that are in hard-to-reach areas.

QA-2133 **HOSE REMOVAL PLIERS, LEVER TYPE**

NEW



- Overall length... 202 mm, Width... 94 mm
- Easily disconnects hoses by gripping firmly the tubes/lines.
- Especially suitable for hoses connected to tubes or lines with smooth surface, where exercising pushing force is not possible.
- Jaw for 3/16", 1/4" and 3/8" tubes and lines.
- Pointed jaw tip allows access to confined spaces.
- Special locking design enhances secure gripping.

QA-2134 **HOSE REMOVAL PLIERS, SCREW LOCK TYPE**

NEW

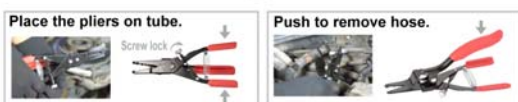

- Overall length... 202 mm, Width... 94 mm
- Easily disconnects hoses by gripping firmly the tubes/lines.
- Especially suitable for hoses connected to tubes or lines with smooth surface, where exercising pushing force is not possible.
- Jaw for 3/16", 1/4" and 3/8" tubes and lines.
- Pointed jaw tip allows access to confined spaces.
- Special locking design enhances secure gripping.

QA-1430 **FUEL FEED PIPE PLIERS**



- Jaws made of special steel.
- Pliers with solid plastic body.
- For undoing quick release connections on fuel feed pipe lines.

QA-1415

8PCS STEEL LINE STOPPER SET

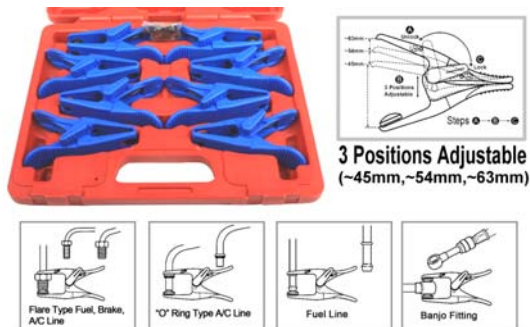

- Prevents fluid leaks and contamination during service.
- Suitable for... Fuel rails and lines. Flare type steel brake, fuel, AC lines. Banjo fittings on brake, power steering & transmission cooler lines.
- Contents...
 - 2_ 5/16"
 - 2_ 3/8"
 - 2_ 1/2"
 - 1_ Banjo (small)
 - 1_ Banjo (big)

QA-1416

QUICK FLUID STOPPER SET



- Suitable for variety of pipes and hoses including fuel lines, transmission fluid lines, coolant lines, vacuum lines, etc.
- Quickly stop fluid from the separated fuel hoses.
- Contents...
 - 1_ Extension hose clamp, Length 310mm, application size 25.4mm. Used for clamping off rubber fuel hoses and reaching hoses where access is limited.
 - 6_ Stoppers, Length 40mm, two of each size... 3/16", 1/4", 5/16". Used to close off hoses, vacuum pipes, etc.
 - 2_ Clamp (Metal Fuel Pipe), Stop ball size Ø10.4mm, Concave size L...13.6mm, W...8.3mm
 - 2_ Clamp (Banjo fitting), Stop ball size Ø18mm

QA-1417

QUICK FLUID STOPPER SET

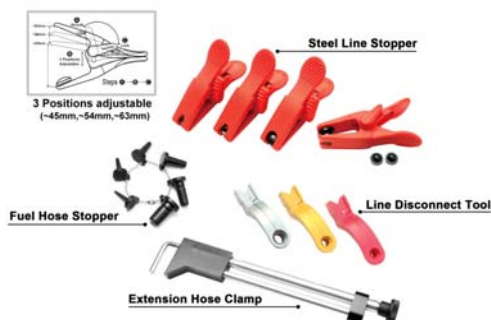

- Prevents fluid leaks and contamination during service.
- Quickly stop fluid from the separated fuel hoses.
- Available for injection hose or fuel supply hose adaptors.
- Contents...
 - 4_ Steel line stopper, 3 positions adjustable, description... 3/8", 5/16", 1/2", Banjo(10.4mm & 18mm).
 - 6_ Plugs fit 1/8", 3/16", 1/4", 5/16", 3/8", 1/2" hoses
 - 1_ Extension hose clamp
 - 3_ Deluxe line disconnect tool, for 5/16", 3/8", 1/2" lines.

QA-1412

STEEL LINE STOPPER KIT



- Specifications... Banjo, 3/8", 5/16", 1/2"
- Use to plug steel lines once disconnected.
- Prevents fluid leaks and contamination during service.
- Use with any automotive fluid.
- Spring loaded design installs in seconds.

QA-1414

UNIVERSAL STEEL LINE STOPPER



- Suitable for clamping and sealing steel line on braking system, cooling system, fuel line, A/C Line, etc.
- Provides an effective seal to steel lines when disconnected.
- Prevents fluid loss and contamination of the work area.
- Description... 5/16", 3/8", 1/2" and Banjo(10.4mm&18mm)

QA-2081

MICRO HOSE CLAMP TENSIONER



NEW



- Capacity... 5 to 55mm
- Able to operate in small engine room with one clip to keep tension and then take the hose off easily.
- Apply on many kinds of hose clamp.

QA-1674

3 WAY HOSE CLAMP TOOL

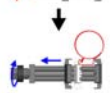
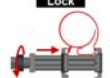

- Max capacity... 65mm; Length... 106mm
- Use with 14mm wrench or 1/4" drive bar.
- Special 3-way clamps design for any type hose clamp.
- Allow for removal of hose clips, and for them to be held in an open position.
- Precision clamping at the end of a bent line allows access to clips in hard-to-reach areas.
- Pinchers possess a lock which facilitates work.

QA-1673

3 WAY HOSE CLAMP PLIERS



Press the handle



- Allow for removal of plastic and metal self-clamping clips, Max. capacity... 65mm
- Hose clamp with flexible 600mm wire.
- Special 3-way clamps design for any type hose clamp.
- Allow for removal of hose clips, and for them to be held in an open position.
- Precision clamping at the end of a bent line allows access to clips in hard-to-reach areas.
- Pinchers possess a lock which facilitates work.

QA-1604

HOSE CLAMP PLIERS



- 45° Bent nose.
- Material... Carbon steel body, Steel handle.
- Use for spring type hose clip, Capacity... Dia. 12 - 47mm.
- For grasping from vertical, horizontal, and other various angles.
- Locking ratchet action holds clip open for easy removal and installation.

QA-1675

UNIVERSAL HOSE CLAMP PLIERS

NEW

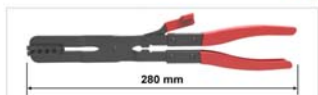

- Total length... 280mm
- Max. capacity... 65mm
- Special angle jaws designed for most kinds of hose clamp.
- Finger tip "position lock" to keep hose clamp spread open.

QA-2198

UNIVERSAL HOSE CLAMP PLIERS, 35° BENT NOSE



- 35° Bent nose, Total length... 265mm
- Max. capacity... 65mm
- Special angle jaws designed for most kinds of hose clamp.
- Finger tip "position lock" to keep hose clamp spread open.

QA-2199

UNIVERSAL HOSE CLAMP PLIERS

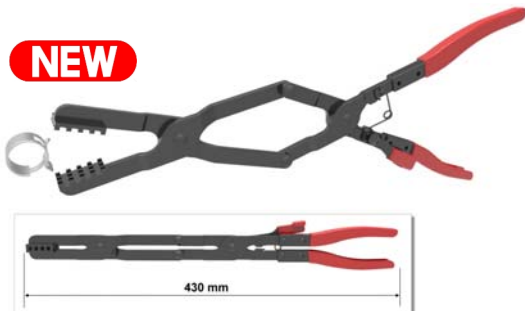

- Total length... 430mm
- Max. capacity... 50mm
- Special angle jaws designed for most kinds of hose clamp.
- Finger tip "position lock" to keep hose clamp spread open.

QA-2200

UNIVERSAL HOSE CLAMP PLIERS, 35° BENT NOSE

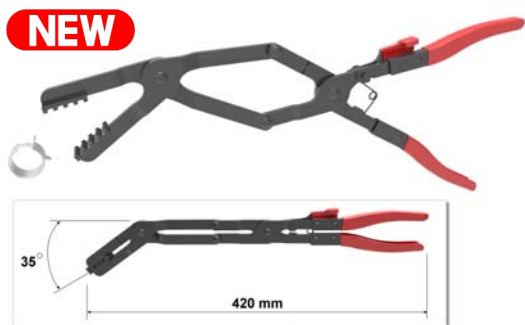

- 35° Bent nose, Total length... 420mm
- Max. capacity... 50mm
- Special angle jaws designed for most kinds of hose clamp.
- Finger tip "position lock" to keep hose clamp spread open.

QA-2362

SPRING-CLIP PLIERS



- Standard-reach model with lock and pivoting jaws.
- For hose clips on cooling, heating, fuel or screen-washer systems.

QA-2363

SPRING-CLIP PLIERS



- Long-reach model with lock and pivoting jaws.
- For hose clips on cooling, heating, fuel or screen-washer systems.



QA-2364

SPRING-CLIP PLIERS



NEW

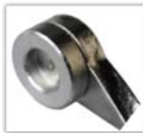

- Slip-joint model.
- For hose clips on cooling, heating, fuel or screen-washer systems.

HCP-248

HOSE CLAMP PLIERS



- Works on most flat-band hose clamps.
- Ratchet lock mechanism holds jaws open.

QA-1665

MULTI-DIRECTION HOSE CLAMP PLIER



- Total length... 205 mm
- Material... CR-V 6140, HRC 42°-45°, Chrome plated
- Wide application plier, available to work on radiator clamp, fuel line clamp and tank ventilation line clamp, and wheel bearing clip.
- Cross-shaped jaws design solves limited space problem.
- 16mm-wide head more effectively grips hose clamp than general pliers with 9mm head.
- Slip resistant grip.

QA-2141

OFFSET BOOT CLAMP PLIERS



NEW



- Overall length... 235mm
- A special boot clamp crimping pliers that is designed to work in confined spaces.
- The pliers work from the side (turned 90°) unlike traditional tools that work from the end.

QA-1774

HEAVY-DUTY CV BOOT CLAMP PLIERS



- Body material... CR-V 6140 steel
- With 3/8" Sq. Dr.
- For easy installation of ear-type clamps on fuel filters, water pumps, other cooling system hose, and CV joint clamps.



991020-02

HEAVY-DUTY HOSE CLIP PLIERS

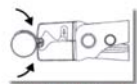

To install high tension clamp.



To remove high tension clamp.



- For 4.5 mm Tension clamp.
- For install and removing tension clamp.
- Special jaws allow the change from install to remove (and back again) simply by turning the pliers over in your hand.

941229-04

TWO WAY HOSE CLAMP PLIERS

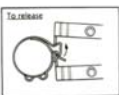
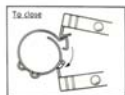

- Blade material... K5, Thickness... 1 mm
- Body material... Carbon steel, Thickness... 3 mm
- Handle material... PVC
- Total length... 160 mm
- Clamp capacity... 1/2" to 3-1/2"

QA-1431

HOSE CLAMP PLIERS



- Jaws made of special steel.
- Pliers with solid plastic body.
- For progressively adjustable clamps without lug holding-down device.
- Suitable for axle boots on VW-AUDI, MERCEDES-BENZ and TOYOTA.

QA-2178

MINI HOSE PINCH-OFF PLIERS



NEW

- Length... 5"(122mm), Max. jaw clamping width... 20mm
- Clamping mechanism provides positive clamping without springs or adjustments.
- High carbon steel, Heat treatment construction.
- For pinching off flexible fuel lines, brake lines, and vacuum hoses in cars, motorcycles, and engines.

QA-2179

HOSE PINCH-OFF PLIERS



NEW

- Length... 9"(228mm), Max. jaw clamping width... 35mm
- Clamping mechanism provides positive clamping without springs or adjustments.
- High carbon steel, Heat treatment construction.
- For pinching off flexible fuel lines, brake lines, and vacuum hoses in cars, motorcycles, and engines.



QA-2180

HEAVY-DUTY HOSE PINCH-OFF PLIERS



- Length... 13"(330mm), Max. jaw clamping width... 74mm
- Clamping mechanism provides positive clamping without springs or adjustments.
- High carbon steel, Heat treatment construction.
- For pinching off flexible fuel lines, brake lines, and vacuum hoses in cars, motorcycles, and engines.

991025-01P

LOCKING HOSE PINCH-OFF PLIERS



- Max. jaw opening... 2-1/4"
- Overall length... 10-1/2"
- Jaws swivel for parallel and level clamping.
- Long handles add extra leverage.
- Positive clamping for tight seals on larger hoses.
- Great for use on heater and radiator hoses, water, vacuum, fuels and air lines.

QA-1406

3 PCS HOSE PINCH-OFF PLIERS SET



- Size... 8", 10", 12"
- The pinch-off pliers act as a third hand to help you keep hose changed tightly when you are servicing various engine components.
- No need to drain system when changing thermostats – save coolant – save time.
- Jaws swivel for parallel clamping.
- Locking ratchet provides tight grip in just about any position.

QA-1407

HOSE CLAMP



- Maximum application... 25.4mm
- Length 310mm, extension hose clamp helps repair work
- Stop the oil flow and avoid damaging hoses.
- Adjustable for most kinds of flexible hoses, particularly for brake, fuel or cooling system hoses.
- Adjust the movable ball and fit the width of hose, then screw the adjustable head.

QA-1411

HOSE PINCHERS SET



- Shut off flow through vacuum lines, fuel lines, small coolant lines, etc.
- Design of tool enables use in tight areas.
- Not designed for crimping copper, aluminum, steel, or hard plastic lines.

QA-1401

FLUID HOSE CLAMP



- Completely or partially closes flexible brake, fuel, and vacuum, fluid line.
- All steel construction with adjustable locking collar.

QA-1402

HOSE PINCH-OFF TOOL (BAR TYPE)



- Suited for both brake and fuel lines.
- Effective pinch action with rounded clamp section to prevent damage to hose lining.

QA-1403

FLUID LINE CLAMPER SET



- This tool can be used to stop the liquid flow without damaging the hose.
- Applicable hose size...
Ø10mm (3/8"), Ø15mm (1/2"), Ø25mm (1"), Ø45mm (1 3/4")

QA-1404

SCREW-TYPE HOSE CLAMP



- Suited for cooling systems, fuel lines, vacuum hoses.
- Applicable hose size... Ø 27mm

QA-1405

SCREW-TYPE HOSE CLAMP



- Suited for cooling systems, fuel lines, vacuum hoses.
- Applicable hose size... Ø 45mm

QA-1539 TRANSPARENT AIR GREASE GUN



- Transparent window... Easy to check grease and working condition.
- Continuous flow
- Loading way... 14 oz.Cartridge, 400c.c. Bulk, Dispenser.
- 360° angle-free rotating
- With 1pc 170mm bent nozzle (with chuck)
- Pressure Range... Air supplied
Input 60 ~ 150 psi
Output 2,400 ~ 6,000 psi.
- Working air pressure(PSI)... 90

AG-401 AIR GREASE GUN



- Continuous flow
- Loading way... 14 oz.Cartridge, 400c.c. Bulk, Dispenser.
- 360° angle-free rotating
- With 1pc 170mm bent nozzle (with chuck)
- Pressure Range... Air supplied
Input 60 ~ 150 psi,
Output 2,400 ~ 6,000 psi.
- Working air pressure(PSI)... 90

AG-402 AIR GREASE GUN



- Continuous operation
- Loading way... 14 oz.Cartridge, 400c.c. Bulk, Dispenser.
- Heavy-duty spring for prime retention.
- With 1pc 170mm bent nozzle (with chuck)
- Pressure Range... Air supplied
Input 60 ~ 150 psi,
Output 2,400 ~ 6,000 psi.
- Working air pressure(PSI)... 90

AG-403 AIR GREASE GUN



- Single shot operation
- Loading way... 14 oz.Cartridge, 400c.c. Bulk, Dispenser.
- With 1pc 170mm bent nozzle (with chuck).
- Working Pressure...
Input 90 psi,
Output 3,600 psi.
- Working air pressure... 90psi.

QA-1540 4PCS TRANSPARENT GREASE GUN KIT



- Contents...
 - 1_ Transparent air grease gun Pressure Range...
 - Air supplied Input 60 ~ 150 psi,
 - Output 2,400 ~ 6,000 psi.
 - Working air pressure(Psi)... 90
 - 1_ Hand grease gun head assembly
 - Working pressure... 4500 PSI
 - Burst pressure... 10000 PSI
 - 1_ 18" Nylon hose with wire
 - 1_ Metallic bent spout
- Loading way... 14 oz.Cartridge, 400c.c. Bulk, Dispenser.

QA-2428 TWO-WAY PROFESSIONAL GREASE GUN



Item no.	Cartridge loading	Bulk loading
QA-2428	14 oz.	400 c.c.
QA-2429	16 oz.	500 c.c.

- Grip type, handle with buckle.
- With 1pc flexible nylon hose 18", attached with wire and chuck
- Working pressure... 4500 PSI
- One-hand operation max. pressure... 8000 PSI
- Two-hand operation max. pressure... 10000 PSI
- Loading ways... Cartridge, Dispenser, Bulk
- Delivers minimum... 1 oz. / 40 strokes
- It is ideal for combining one-hand operation and two-hand operation in one gun.

GG1-400A HEAVY-DUTY MANUAL OPERATED GREASE GUN



- Lever type
- With 1pc Bent nozzle 170mm (with chuck)
- Cartridge loading... 14 OZ.
- Bulk loading... 400 C.C.
- Working pressure... 4500 PSI
- Burst pressure... 10000 PSI
- Loading ways... Cartridge, Dispenser, Bulk

981228-03A EXTRA HEAVY-DUTY GREASE GUN



- Lever type, with heavy duty follow rod handle.
- Iron-cast gun head design.
- With 1pc Bent nozzle 170mm (with chuck)
- Cartridge loading... 14 oz.
- Bulk loading... 400 c.c.
- Working pressure... 4500 PSI
- Max. pressure... 10000 PSI
- Delivers minimum... 1 oz. / 40 strokes
- Loading ways... Cartridge, Dispenser, Bulk
- Ideal for machine, automobile farm and garden equipments, recreation vehicles etc.

QA-1538 TRANSPARENT HAND GREASE GUN



Air pocket released valve

- Transparent window.
- With 1pc Bent nozzle 170mm (with chuck)
- Cartridge loading... 14 OZ.
- Bulk loading... 400 C.C.
- Working pressure... 4500 PSI
- Burst pressure... 10000 PSI
- Loading ways... Cartridge, Dispenser, Bulk
- Loading way... 14 oz.Cartridge, 400c.c. Bulk, Dispenser.

981228-03B LIGHTWEIGHT GREASE GUN



- Lever type, with aluminum tube.
- With 1pc Bent nozzle 170mm (with chuck)
- Cartridge loading... 14 oz.
- Bulk loading... 400 c.c.
- Working pressure... 4500 PSI
- Max. pressure... 10000 PSI
- Delivers minimum... 1 oz. / 40 strokes
- Loading ways... Cartridge, Dispenser, Bulk
- Lighten weight, it's make convenient for operation, fit durable time working demand and labor-saving.

QA-2426 PISTOL GRIP GREASE GUN



Item no.	Cartridge loading	Bulk loading
QA-2426	14 oz.	400 c.c.
QA-2427	16 oz.	500 c.c.

- Grip type, handle with buckle.
- With 1pc Straight nozzle 170mm with chuck
- Working pressure... 4500 PSI
- Max. pressure... 8000 PSI
- Loading ways... Cartridge, Dispenser, Bulk
- Delivers minimum... 1 oz. / 40 strokes

GG1-400GT HEAVY-DUTY MANUAL OPERATED GREASE GUN



- Grip type
- With 1pc Straight nozzle 170mm with chuck
- Cartridge loading... 14 O.Z.
- Bulk loading... 400 C.C.
- Working pressure... 4500 PSI
- Burst pressure... 7300 PSI
- Loading ways... Cartridge, Dispenser, Bulk

QA-1473

TELESCOPIC MAGNETIC PICK UP TOOL



Flexible telescoping bar



- 3 LED, Aluminum body, Battery... LR44 × 4
- 1 Section flexible telescoping bar,
5 Section stiff telescoping bar.
- Length... 171 to 552 mm
- Magnetic capacity...
Top magnet 5 lbs, Bottom magnet 5 lbs.

MPT-2005

TELESCOPING MAGNETIC PICK-UP TOOL



- 5 Section stainless steel bar.
- Length... 168 to 650mm (6-1/2" to 25-5/8")
- Magnetic capacity... 9 lbs(4.0kg)

QA-1328

TELESCOPIC MAGNETIC PICK UP TOOL



- 1 LED, Aluminum body, Battery... LR44×3
- 1 Section flexible telescoping bar,
3 Section stiff telescoping bar.
- Length... 147 to 370 mm
- Magnetic capacity
Top magnet 3 lbs, Bottom magnet 2 lbs.

MPT-3003

MIRROR MAGNETIC PICK UP TOOL



- 5 Section telescoping bar.
- Length... 212 to 527mm
- Circular mirror Dia. 32mm

MPT-18

TELESCOPING MAGNETIC PICK-UP TOOLS



- 7 Section telescoping bar.
- Length... 135 to 645mm (5-1/4" to 25-3/8")
- Magnetic capacity... 5.5 lbs(2.5kg)

MPT-3040

MULTI-FUNCTION MAGNETIC PICK-UP TOOL



- 7 Section telescoping bar.
- Length... 220 to 710mm (8- 5/8" to 28")
- Circular mirror Dia. 40mm
- Magnetic capacity... 1.1lbs (0.5kg)
- With needle Dia 1.2mm & Pocket clip.

941229-01

BENDED AND ADJUSTED INSPECTION MIRROR



- Glass mirror size... 50 × 70 mm (2" × 2-3/8")
- Heavy-duty plated flexible shank Dia.11 × 205(L) mm
- Total length... 510 mm (20")

MT-150C

MAGNETIC BOWL



- Magnetic plate material... Stainless steel
- Diameter... 15 cm
- ABS cover

990809-02

TELESCOPE SECURITY MIRROR



- Telescope aluminum rod... 660-1280 mm. Mirror... Ø 8 "
- Mateial of mirror... Acrylic, Handle grip material... TPR
- Adjustable, Convex, Mirror has a 180 degree view angle.
- Checking under vehicles or equipments at security checkpoints.
- Security mirror helps to estimate blind spots.

MT-110

ROUND MAGNETIC TRAY



Item no.	Dia.
MT-110	110 mm
MT-150	150 mm
Material...	Stainless steel

990809-01

ROUND MAGNETIC STRAINER



- Size... Ø280 × 100 mm
- Stainless steel strainer.
- Great for collecting small items- No more missing screws or fasteners.
- Perfect for washing dirty tools - Tools can be attracted firmly during flushing.

MT-242

RECTANGULAR MAGNETIC TRAY



- Length 242mm, Wide 142mm
- Material... Stainless steel

970625-01P

MAGNETIC TOOL HOLDER



- Size... 305(L) × 50(W) × 7(H) mm
- Super strong magnet holds and organizes wrenches, sockets, and fasteners.
- Tools and fasteners can be secured when taken to the job site.
- Low profile holder fits in tool box, tool storage drawer, or can be hung on any metal surface.
- With firm grip can take off holder easily from metal surface.

970625-01Q

MAGNETIC HOLDER



- Size... 455(L) × 51(W) × 17(H) mm
- The holder can be mounted on the wall with screws included.
- Metal items are attracted easily.

970625-01L

MAGNETIC HOLDER FOR IMPACT WRENCH

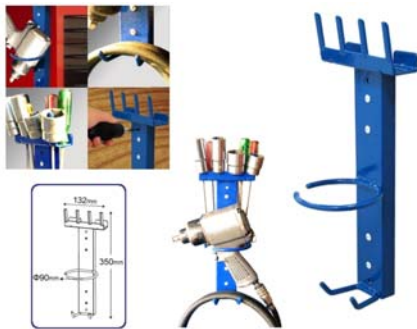

- Size... 132(L) × 350(H) × Ø 90mm
- This magnetic holder is designed for holding most pistol type impact wrenches and impact sockets.
- Special magnetic structure can firmly attach to ferric surface up to 15 kgs.
- The magnetic holder can easily hold one impact wrench, four impact sockets, and other tools, like screwdrivers.
- With PE coating finishing, this holder is environmental compliance.
- Screw-holes design, you can screw the holder on nonferrous surface (two screws included).
- Wire hook for organize air hoses or electric wire.

970625-01M

MAGNETIC TOOL BOX



- Hold up to 33 LBS.
- Powder coating finish makes it durable.
- Makes tools & hardware handy and organized.
- Perfect for using in garages, workshops, manufacturing sites, and wherever users need it.
- Easy to take off or attach to wherever users like with magnetic design.
- Enhance the load capacity with screws.
- Removable and portable design can carry tools to anywhere you want at the same time.
- Our special magnets allow this patented design to carry up to 15 lbs by testing on 1mm thickness iron plate.

970625-01N

MAGNETIC TABLE



- Hold up to 33 lbs
- Can use as an extra table anywhere you want.
- Magnetic seats can attract small items (sockets, bits, screws...etc.)
- Hooks for holding wrenches, hammers...etc.
- Perfect for using in garages, workshops, manufacturing sites and wherever you need it.
- Removable and portable design can carry tools to anywhere you want at the same time.
- Easy to take down notes, testing reports with table design.
- Our special magnets allow this patented design to carry up to 33 lbs by testing on 3mm thickness iron plate.

970625-01G

POWER CLEAN UP MAGNET



- Total length... 410 mm
- Quickly and safely to clean up sharp cuts like iron & steel chips and waste.
- Release small parts after pulling the bar.
- Easy to clean up the work zone, factory, house or workshop.
- Easy to pick and release scrap and ferrous debris.
- Permanent magnet, never need to be re-magnetized.
- Light, non-rusting shaft.

970625-01H

MINI EZ-RELEASE MAGNETIC PICK-UP TOOL



- Size... 110(L) × 110(W) × 190(H) mm
- Easy to pick up various kinds of hand tools and small iron or steel parts for office, house and factory.
- Pull the trigger to drop attracted items easily.
- Permanent magnet.
- Light and handy design fitting ergonomics.
- Impact-proof plastic materials.

970625-01J

EZ-RELEASE MAGNETIC PICK-UP TOOL



- Total length... 680 mm
- Magnetic capacity around... 4 kgs
- Pick up ferrous metal items such as tools, bolts, paper clips, nails, etc.
- Release attracted items by pulling the trigger on the handle.
- Easy to use, safe, practical and time saving
- Permanent magnet.

970625-01K

EZ-RELEASE MAGNETIC PICK-UP TOOL



- Total length... 960 mm
- Pick up ferrous metal items such as tools, bolts, paper clips, nails, etc.
- Release attracted items by pulling the trigger on the handle.
- Easy to use, safe, practical and time saving
- Permanent magnet.

970625-01D

PORTABLE MAGNETIC FINDER



- Telescoping aluminum handle
- Total length... 640 - 1080 mm
- Powerful magnetic tool is ideal for picking up ferrous metal items such as iron chips, shavings, nails, nuts, ... etc.
- Quick, convenient, safe, and time saving to clean floors, driveways, construction areas.
- Adjustable angle design easily reaches under machinery or cars.
- Ergonomic handle for comfortable use.

970625-01C

MAGNETIC FINDER



- Telescoping handle
- Total length... 660 - 1080 mm
- Pick up ferrous metal items such as tools, bolts, paper clips, nails, etc.
- Ergonomic handle for comfort.
- Easy to use, safe, practical and time saving.
- Permanent magnet

970625-01E

RECTANGULAR MAGNETIC FINDER



- Telescoping aluminum handle
- Total length... 680 - 1100 mm
- Powerful magnetic tool is ideal for picking up ferrous metal items such as iron chips, shavings, nails, nuts, etc.
- Quick, convenient, safe, and time saving to clean floors, driveways, construction areas.
- Adjustable angle design easily reaches under machinery or cars.
- Ergonomic handle for comfortable use.

970625-01B

RECTANGULAR MAGNETIC FINDER WITH WHEELS



- Telescoping aluminum handle
- Total length... 680 - 1100 mm
- Wheel diameter... 95 mm
- Powerful magnetic tool is ideal for picking up ferrous metal items such as iron chips, shavings, nails, nuts, etc.
- Quick, convenient, safe, and time saving to clean floors, driveways, construction areas.
- Adjustable angle design easily reaches under machinery or cars.
- Ergonomic handle for comfortable use.
- Smart and convenient wheels design save time and energy while cleaning up and removing stuffs.

970625-01A

MAGNETIC SWEEPER-15" (377MM)



- Telescoping aluminum handle
- Total length... 28-5/8" to 41" (730 - 1040 mm)
- Wheel diameter... 95 mm
- Release magnetic pick up tool has a magnetic device which enable to attract any metal items and spare parts laying on the floor without the trouble to pick them up one by one.
- Pull the trigger to release magnetic force.
- Easy to use, safe and practical time saving device.
- Permanent magnet.

970625-01F

MAGNETIC RAKE WITH RELEASE FUNCTION



- Telescoping handle.
- Total length... 675 to 1100 mm
- Magnetic rake design is perfect for picking up metal items from sand, grass and wood chips.
- Turn the knob to release magnetic force.

FW-1500

15 PCS CUP TYPE OIL FILTER WRENCH SET



- Capacity... Dia. 66 to 100 mm (2 9/16" to 4")
- These cup-type filters are made of 7 and 16 gauge construction and are able to withstand up to 85 ft.-lbs. of torque.
- Cup-type design grips like a socket minimizing the possibility of crushing filters.
- Use 3/8" or 1/2" square drive tool.
- Coated with electro-black oxide finish for protection against rust.

Contents :

PART NO.	DESCRIPTION
FW-65/14	65mm (2-9/16") – 14 flutes – 1 step. ♦ Fits Nissan, Fiat Champ, Hastings. GM/AC, Wix, NAPA, Purolator, Daihatsu, Toyota filters.
FW-68/14	68mm (2-11/16") – 14 flutes – 1 step. ♦ Fits Hastings, Mazda, Ford Escort, Capri, Subaru, Fran PH6607 (those Fram filters made in Korea), Motorcraft FL816 filters.
FW-73/14	73mm (2-7/8") – 14 flutes – 1 step. ♦ Fits Toyota/Lexus filters.
FW-74/76	74 to 76mm (2-29/32 to 3") – 15 flutes – 2 step. ♦ Fits Ford, Opel, VW, Audi, Mercedes, Fram, AC, Saturn filters.
FW-76/14	76mm (3") – 14 flutes – 1 step. ♦ Fits Audi, Opel, Champion, Champ Lee, Purolator, Mopar, VW, Porsche, Mercedes, BMW filters.
FW-80/15	80mm (3-9/64") – 15 flutes – 1 step. ♦ Fits Opel, Hastings. Fram, Purolator, Nissan, Honda, Motorcraft, Mazda, Isuzu, Subaru filters.
FW-93/15	93mm (3-21/32") – 15 flutes – 1 step. ♦ Fits Mazda, Volvo, Mitsubishi, Honda, Casite, Champ, Champion, GM, Fram, Hastings. Purolator, Wix, Nissan, VW, Porsche, Renault filters.
FW-93/36	93mm (3-21/32") – 36 flutes – 1 step. ♦ Fits Ford, Motorcraft only – FL1A, FLA1B, FL300, FL820 filters.
FW-65/67	65-67mm (2-9/16" to 1-21/32") – 14 flutes – 2 step. ♦ Fits Daihatsu, Toyota, same filters as No. 785. plus also fits those Fram filters made in Canada including PH4386, PH4967, PH6017. PH6018.
FW-80/82	80-82mm (3-9/64" to 3-7/32") – 15 flutes – 2 step. ♦ Fits Wix filters. Branded for : Maxda. Subaru. Toyota. Honda. Acura. Nissan. NAPA
FW-90/15	90mm (3-17/32") – 15 flutes – 1 step. ♦ Fits Honda Accord. Mitsubishi. Mopar. Isuzu filters.
FW-75/77	75-77mm (2-15/16" to 3-1/32") – 15 flutes – 2 step. ♦ Fits VW, Audi, Mercedes, Opel, Casite. GM/AC, Hastings, Wix. NAPA Ford. Isuzu filters.
FW-76/30	76mm (3") – 30 flutes 1 step. ♦ Fits Motorcraft only – FL400A.
FW-100/15	100mm (4") – 15 flutes – 1 step. ♦ Fits Fram, Motorcraft, Wix, Isuzu and Mitsubishi filters.

FW-1600

16 PCS CUP TYPE OIL FILTER WRENCH SET



- Capacity... Dia. 66 to 108 mm (2 9/16" to 4 8/32")
- These cup-type filters are made of 7 and 16 gauge construction and are able to withstand up to 85 ft.-lbs. of torque.
- Cup-type design grips like a socket minimizing the possibility of crushing filters.
- Use 3/8" or 1/2" square drive tool.
- Coated with electro-black oxide finish for protection against rust.

Contents :

PART NO.	DESCRIPTION
FW-66/6	66mm (2-19/32") - 6 flutes-1 step. ♦ Fits Fiat (punto,1.2) Renault (clio 1.2 express, Kangoo.Rapid.Twingo) etc...
FW-76/8	76mm (3") - 8 flutes - 1 step. ♦ Fits Fiat (z.B. Marea), Lancia (z.B.Delta) etc....
FW-76/12	76mm (3") -12 flutes- 1 step. ♦ Fits Fiat (z.B. Ducato, Scudo, Ulysee), Renault, (Megane.Laguna.Espace III.) etc...
FW-86/16	86mm (3-3/8") - 16 flutes - 1 step. ♦ Fits Volvo (S40, S60, S70, S80.) etc..
FW-86/18	86mm (3-3/8") - 18 flutes - 1 step. ♦ Fits VW. Golf. (MKIII. TDI, passat TDI,) Audi A6 TDI, Renault (clio. Rapid 1.9D Laguna. Safrane. Espace 2.1D), Citroen, Peugeot, Renault, etc...
FW-92/10	92mm (3-40/64") - 10 flutes - 1 step. ♦ Fits Fiat, Cinquecento.Coupe. Croma, Fiat, Panda. Regata. Ritmo, Fiat, Seicento. Tempra. Tipo, Lancia (Beta. Dedra. Kappa. Monte. Carlo. Prisma. Thema. Trevi) etc...
FW-93/45	93mm (3-21/32") - 45 flutes - 1 step. ♦ Fits VW-Audi. (TDI 2.4,2.6,2.8L) etc..
FW-96/18	96mm (3-3/4") - 18 flutes -1 step. ♦ Fits Audi (A4 TDI, VW Passat 97 TDI) Renault (Laguna 2.2d. Safrane 2.2D Espace 2.2D. R19 2.2D. Rapid. Megane. 1.9/2.1D. TDI) etc...
FW-106/15	106mm (4-11/64") - 15 flutes -1 step. ♦ Fits Fiat (Ducato 2.5D. Td) etc...
FW-108/15	108 MM (4-8/32") -15 flutes - 1 step. ♦ Fits Volvo (C70. S70. V70. TDI. TD) (850 TDI. TD) etc....
FW-108/18	108mm (4-8/32") -18 flutes - 1 step. ♦ Fits Renault (Espace, Laguna, Master, Safrane, Traffic 2.4,2.5,2.8D. TD) etc..
FW-74/76	74 to 76mm (2-29/32 to 3") - 15 flutes - 2 step. ♦ Fits Fram, AC, Saturn , Opel, VW, Audi, Mercedes,etc..
FW-76/14	76mm (3") - 14 flutes - 1 step. ♦ Fits Champion, Champ Lee, Purolator, Mopar, VW, Porsche, Mercedes, BMW, Audi, Toyota, Opel, etc..
FW-93/15	93mm (3-21/32") - 15 flutes - 1 step. ♦ Fits Casite, Champ, Champion, GM , Fram, Hastings. Purolator , Wix, Nissan, Volvo, Mazda, Audi , VW , Porsche , Renault etc...
FW-15103	3 Legged oil Filter Tool 65 ~ 120 mm (2-1/2" to 4-3/4")
FW-9.5mm	Adaptor 3/8" or 1/2" Square Drive Tool.

FW-3000

30 PCS CUP TYPE OIL FILTER WRENCH SET



- Capacity... Dia. 66 to 108 mm (2 9/16" to 4 8/32")
- These cup-type filters are made of 7 and 16 gauge construction and are able to withstand up to 85 ft.-lbs. of torque.
- Cup-type design grips like a socket minimizing the possibility of crushing filters.
- Use 3/8" or 1/2" square drive tool.
- Coated with electro-black oxide finish for protection against rust.

Contents :

PART NO.	DESCRIPTION	PART NO.	DESCRIPTION
FW-66/6	66mm (2-19/32") - 6 flutes - 1 step Fiat (Punto, 1.2) Renault (Clio 1.2 Express, Kangoo, Rapid, Twingo) etc...	FW-80/82	80 to 82mm (3-9/64" to 3-7/32") - 15 flutes - 2 step Fits Wix Filters branded for : Mazda, Subaru, Toyota, Honda, Acura, Nissan, Napa, etc...
FW-65/14	65mm (2-9/16") - 14 flutes - 1 step. Fits Fiat, Champ, Hastings, GM/Ac, Wix, NAPA, Purolator, Daihatsu, Toyota, Nissan, etc...	FW-86/16	86 mm (3-3/8") - 16 flutes 1 step Volvo (S40, S60, S70, S80) etc...
FW-65/67	65 to 67mm (2-9/16" to 2-21/32") - 14 flutes - 2 step Fits same filters as made in Canada including PH4386, PH4967, PH6017, PH6018, Daihatsu, Toyota, etc...	FW-86/18	86mm (3-3/8") - 18 flutes - 1 step VW Golf (MKIII, Tdi, passat Tdi), Audi A6 Tdi, Renault (Clio, Rapid 1.9 D Laguna, Safrane, Espace 2.1D), Citroen, Peugeot, Renault, etc
FW-68/14	68mm (2-11/16") - 14 flutes - 1 step. Fits Hastings, Mazda, Ford Escort, Capri, Subaru, Fran PH607 (those Fram filters made in Korea), Motorcraft FL816 etc...	FW-90/15	90mm (3-17/32") - 15 flutes - 1 step Fits, Honda, Accord, Mitsubishi, Mopar, Isuzu, etc...
FW-73/14	73mm (2-7/8") - 14 flutes - 1 step. Fits Toyota/Lexus filters.	FW-92/10	92mm (3-5/8") - 10 flutes - 1 step Fits, Cinquecento, Coupe, Croma, Fiat, Panda, Regata, Ritmo Fiat, Seicento, Tempra, Tipo, Lancia (Beta, Dedra, Kappa, Monte, Carlo, Prisma, Thema, Trevi) etc...
FW-74/15	74mm (2-29/32") 15 flutes - 1 step MF, Audi, # 056-115-561g, GM, Rover, Chrysler, etc...	FW-93/15	93mm (3-21/32") - 15 flutes - 1 step Fits Casite, Champ, Champion, GM, Fram, Hastings, Opel, Mazda, Volvo, Mitsubishi, Purolator, Wix, Nissan, VW, Porsche, Renault, Ford, Honda, Audi, etc...
FW-74/76	74 to 76mm (2-29/32 to 3") - 15 flutes - 2 step. Fits Ford, Opel, VW, Audi, Mercedes, Fram, AC, Saturn.	FW-93/36	93mm (3-21/32") - 36 flutes - 1 step Fit Motorcraft only-FL1A, FLA1B, FL300, FL820, Ford, etc...
FW-75/77	75 to 77mm (2-15/16" to 3-1/32") - 15 flutes - 2 step Fits VW, Audi, Casite, GM/AC, Hastings, Wix, NAPA Ford, Isuzu, Mercedes, Opel, etc...	FW-93/45	93mm (3-21/32") - 45 flutes - 1 step VW-Audi, (Tdi 2.4, 2.6, 2.8L) etc...
FW-76/12	76mm (3") - 12 flutes - 1 step Fiat (z.B. Ducato, Scudo, Ulysee), Renault, (Megane, Laguna, Espace III.) Mercedes, etc...	FW-95/15	95mm (3-3/4") - 15 flutes - 1 step Toyota # 15600-41010, Alfa, GM, Ford, Alfa, Chrysler, etc...
FW-76/14	76mm (3") - 14 flutes - 1 step. Fits Champion, Champ Lee, Purolator, Mopar, VW, Porsche, Mercedes, Benz, BMW, Audi, (I.B.A3TD) Opel, Etc...	FW-96/18	96mm (3-3/4") - 18 flutes - 1 step Audi (A6, Tdi), VW (Passat 97 Tdi) Renault (Laguna 2.2d, Safrane 2.2D, Espace 2.2D, R19, Rapid, Megane, 1.9/2.1D, Tdi) etc...
FW-76/30	76mm (3") - 30 flutes - 1 step Fits Motorcraft only- FL400A, Ford, etc...	FW-100/15	100mm (4") - 15 flutes - 1 step Fits Fram, Motorcraft, Wix, Isuzu and Mitsubishi, etc...
FW-76/8	76mm (3") - 8 flutes - 1 step Fiat (z.B. Marea), Lancia (z.B. Delta) etc...	FW-106/15	106mm (4-11/64") - 15 flutes - 1 step Fiat (Ducato 2.5D, Td) etc...
FW-78/15	78mm (3-2/32") - 15 flutes - 1 step Nissan # 15205H8991, Ford, Toyota, Accord, etc...	FW-108/15	108mm (4-8/32") - 15 flutes - 1 step Volvo (C70, S70, V70, Tdi, TD) (Turbo, Diesel) (850 Tdi, Diesel) etc...
FW-80/15	80mm (3-9/64") - 15 flutes - 1 step. Fits Hastings, Fram, Purolator, Nissan, Honda, Motorcraft, Mazda, Isuzu, Subaru, Opel, Toyota, etc...	FW-108/18	108mm (4-8/32") - 18 flutes - 1 step Renault (Espace, Laguna, Master, Safrane, Traffic 2.4, 2.5, 2.8D, TD) etc...
		FW-15103	TWO WAY OIL FILTER WRENCH 65-120MM
		FW-9.5mm	Adapter 1/2" (F) or 3/8" (M) Square drive Tool.

**QA-2321****SWIVEL JAW FILTER WRENCH PLIER**

Item no.	Length	Capacity
QA-2321	325 mm	2-1/4" to 4-3/4" (57 - 120 mm)
QA-2322	405 mm	3-1/8" to 7-1/2" (80 - 190 mm)

- Jaws swivel 90° in either direction to access most oil and fuel filters.
- Works where other oil and fuel filter pliers and wrenches don't.
- Jaws adjust to 4 positions, (30° increments) to fit most applications.
- Slip-joint handle offers a big range.
- Sure grip teeth prevent slipping.
- Cushioned handles provide comfort.

QA-2323**SWIVEL JAW FILTER WRENCH PLIER**

Item no.	Length	Capacity
QA-2323	325 mm	2-1/4" to 4-3/4" (57 - 120 mm)
QA-2324	405 mm	3-1/8" to 7-1/2" (80 - 190 mm)

- Jaws swivel 90° in either direction to access most oil and fuel filters.
- Works where other oil and fuel filter pliers and wrenches don't.
- Jaws adjust to 4 positions, (30° increments) to fit most applications.
- Slip-joint handle offers a big range.
- Sure grip teeth prevent slipping.
- Cushioned handles provide comfort.

FP-254**OIL FILTER PLIERS**

Item no.	Size (Capacity)
----------	-----------------

- FP-254 10" (45 to 89mm)
- FP-305 12" (54 to 108mm)
- Use for removing screw-on oil filters quickly and easily.
- Serrated jaws are locked into position and provide maximum grip on oil filters.

P-306-10**10" OIL FILTER MASTER PLIER**

- Multi-purpose plier 2-1/8" to 4-5/8" range
- CR-V steel, Drop forged jaws, Heat-treated, Nickel plated.

QA-1145**QUICKLY ADJUSTABLE OIL FILTER WRENCH**

Item no.	Capacity (Dia.)
----------	-----------------

- QA-1145 64 - 110 mm
- QA-1146 110 - 150 mm
- Stainless Steel Band, Nylon Handle.
- Can be used in difficult access areas.
- Spring hinged jaw grips the filter and gives ratchet effect.

FW-4941

OIL FILTER REMOVAL BAND

- Capacity... Dia. 65 to 110mm
- For safe removal of oil filters.
- Adjustable band ensure better grip.

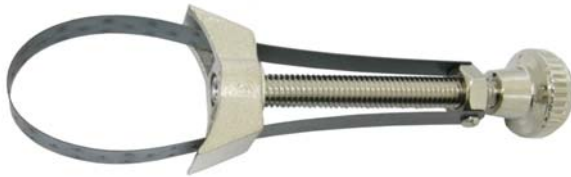

990409-01

PROFESSIONAL SWIVEL OIL FILTER WRENCH

Item no. Capacity (Dia.)

- | | |
|--------------|--------------------------------|
| • 990409-01A | 2-3/8" to 2-7/8" (60 - 73 mm) |
| • 990409-01B | 2-7/8" to 3-3/8" (73 - 85 mm) |
| • 990409-01C | 3-3/8" to 3-3/4" (85 - 95 mm) |
| • 990409-01D | 3-3/4" to 4-3/8" (95 - 111mm) |



FW-530

SWIVEL HANDLE OIL FILTER WRENCH

Item no. Capacity (Dia.)

- | | |
|----------|--------------------------------|
| • FW-530 | 2-3/8" to 2-7/8" (60 - 73 mm) |
| • FW-540 | 2-7/8" to 3-3/8" (73 - 85 mm) |
| • FW-550 | 3-3/8" to 3-3/4" (85 - 95 mm) |



FW-560

HEAVY-DUTY TRUCK OIL FILTER WRENCH

Item no. Capacity (Dia.)

- | | |
|-----------------------------------|---------------------------------|
| • FW-560 | 4-1/8" to 4-3/4" (105 - 120mm) |
| • FW-561 | 4-1/2" to 5-1/4" (115 - 135mm) |
| • FW-562 | 5-1/8" to 5-3/4" (130 - 145mm) |
| • Use with 1/2" square drive tool | |



FW-571

HEAVY DUTY OIL FILTER WRENCH

Item no. Capacity (Dia.)

- | | |
|---|---------------------------------|
| • FW-571 | 4-1/8" to 5" (105 -125 mm) |
| • FW-572 | 4-3/8" to 5-1/4" (110 -130 mm) |
| • FW-573 | 4-3/4" to 5-1/2" (120 -140 mm) |
| • Application for truck. Use with 1/2" square drive tool. | |
| Blade... Carbon steel, HRC 38° ~ 42°, Height... 76 mm. | |



QA-1122

REVERSIBLE FILTER WRENCH



- Capacity... Dia. 66 - 94 mm
- Use with 3/8" square drive tool.
- Special design to remove & tighten most of the oil filters.
- Quick & easy to change the direction.
- Steel jaw grip filter without slipping.

QA-2130

UNIVERSAL OIL FILTER WRENCH

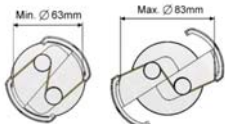

NEW

- Capacity... Dia. 63 - 83 mm(2 1/2" to 3 1/4")
- Use with 3/8" square drive tool.
- Special teeth design for enhanced grips on oil canisters.
- High quality spring for durable usage.

QA-2351

TWO WAY OIL FILTER WRENCH



NEW

Item no. Capacity(Dia.)

QA-2351	60 to 80 mm
QA-2352	80 to 115 mm
QA-2353	115 to 140 mm

- Use with 1/2" Dr. or 21mm wrench.
- Special designed to install and remove the oil filter easily and quickly.
- With pull spring to make it hold the filter easily.

FW-319

TWO WAY OIL FILTER WRENCH



- Capacity... Dia. 2-1/2" to 4" (63 - 102 mm)
- Use with 1/2" or 3/8" square drive tool.

FW-320

THREE-LEG OIL FILTER WRENCH



- Capacity... Dia. 2-1/2" to 4-3/4" (63 to 120mm)
- Use with 1/2" or 3/8" square drive tool.

FW-340

3-CLAW SPIRAL OIL FILTER WRENCH



- Capacity... Dia. 65 to 120 mm
- Use with 1/2" or 3/8" square driver tool.
- Operated by 21 mm Hex adaptor... 1/2" Sq. × 3/8"Sq.

QA-1126

HEAVY DUTY SPIRAL OIL FILTER WRENCH.



- Capacity... Dia. 80 -140mm (3-1/8" to 5-1/2")
- Use With 1/2" Sq. Dr. Tool.

QA-1123

SELF-GRIPING OIL FILTER WRENCH



- Capacity... Dia. 95 - 165mm
- Use with 1/2" square drive tool.

KW-160

STRAP WRENCH



- Professional quality
- Capacity... Max. Dia. 160 mm
- Drop-forged handle

QA-1127

STRAP OIL FILTER WRENCH



- Capacity... Dia. 2" to 4-1/4" (50 - 108mm)
- 16" length reinforced, nonstretch rubberised strap.
- Quick adjustable to fit any spin-on oil filters.
- Steel handle with comfortable grip allows nonslip features for work safety.

FW-158

STRAP WRENCH



- Strap length... 34"
- Capacity(Max.)... 6 1/4"
- Handle length... 12"
- Handle material... Aluminum

FW-078

OIL FILTER STRAP WRENCH



- With 1/2" square driver.
- For oil filters or other round shaped bodies up to 180 mm (7")
- Heavy duty bonded strap.
- Use for trucks, agricultural & building machines.

QA-1132

STRAP OIL FILTER WRENCH



- Capacity... Max. Dia. 120 mm
- Use with 1/2" square drive tool, or 13/16"(21 mm) open end spanner.

QA-1130

STRAP OIL FILTER WRENCH



- Capacity... Max. Dia. 150 mm
- Use with 1/2" square drive tool.

QA-1131

STRAP OIL FILTER WRENCH



- Capacity... Max. Dia. 300 mm
- Use with 1/2" or 3/8" square drive tool, or 13/16"(21 mm) open end spanner.

QA-1138

CHAIN OIL FILTER WRENCH



- Capacity... Max. Dia. 120 mm
- Use with 1/2" square drive tool, or 13/16" (21 mm) open end spanner.

QA-1134

CHAIN OIL FILTER WRENCH



- Capacity... Dia. 5/8" to 5" (16 - 127 mm)
- Chain length... 16-1/4"
- Use with 1/2" square drive tool.

QA-1140A

THIN DOUBLE CHAIN OIL FILTER WRENCH



Item no.	Capacity (Dia.)
QA-1140A	60 - 115 mm
QA-1140B	60 - 170 mm

- QA-1140A 60 - 115 mm
- QA-1140B 60 - 170 mm
- Use with 1/2" square drive tool.

FW-4942

CHAIN OIL FILTER WRENCH



- Capacity... Max. Dia. 100 mm
- Chain style filter wrench utilize a bicycle type
- Chain for superb gripping action

FW-4943

CHAIN OIL FILTER WRENCH



- Capacity... Dia. 1/2" to 6" (12.7 to 152 mm)
- Chain style filter wrenches utilize a bicycle type chain for superb gripping action.

FW-4950

CHAIN OIL FILTER WRENCH



- Capacity... Dia. 40 to 140 mm
- Drop-forged handle.

FW-4960

HEAVY DUTY OIL FILTER CHAIN WRENCH



- Capacity... Dia. 60 to 105 mm
- Chain length... 350 mm
- Swivel handle for narrow space

FW-4970

CHAIN WRENCH



- Chain length... 20"
- Capacity (Max.)... 5 1/4"
- Handle length... 12"
- Handle material... SCM415, HRC50°±3

QA-1436

CHAIN WRENCH



- Capacity... 3" to 6 3/4"
- Chain length... 24.5"
- Handle length... 20"
- Material... SCM415, HRC50°±3

QA-2325

5 PCS OIL FILTER OFFSET WRENCH SET



NEW

- Size... 24, 27, 32, 36, 38mm, with 3/8" square driver.
- Low profile design with offset drive.
- Special design for tight confined areas.
- For oil filters where access is limited.

QA-2326

4 PCS OIL FILTER OFFSET WRENCH SET

NEW



- Size... 24, 27, 32, 36, 38mm, with 3/8" square driver.
- Low profile design with offset drive.
- Special design for tight confined areas.
- For oil filters where access is limited.

QA-1344

OIL FILTER CUTTER



- Cutting capacity... Diameter 60 to 140mm.
- Blade material... SKH9.
- Mainbody material... Aluminum alloy steel.
- Designed to cut oil filters for inspection and aid in recycle of waste oil.
- The tool use bolts fix to the bench to hold filters securely.
- Two roller bearings provide filters smooth scrolling action.

QA-1345

OIL FILTER CUTTING SYSTEM



- Cutting capacity... Diameter 65 to 110mm.
- Oil drain tray collects oil residue.
- Roller bearing provide smooth scrolling action.
- Separate steel housing & paper filter for best environment protection.

QA-1312

15 PCS MAGNETIC OIL DRAIN PLUG SOCKET & KEY SET



- Strong magnet can prevent the sump plugs accidentally falling into drain pans.
- Suitable for use on engines, gearboxes and back axles.
- Blow case package per set.
- Contents...
 - 6_ 3/8"Dr. socket, SCM440 steel, Fully polished micro satin finish, With magnet, Size... 13, 14, 17, 18, 19, 21mm.
 - 8_ 3/8"Dr. Bit socket, SCM440 steel, Fully polished micro satin finish, With magnet, Size... Hex 8, 10, 12, 13, 14, 17 mm. Square 8, 10 mm.
 - 1_ 3/8"Dr. Star T45 bit socket, S2 steel, Fully polished micro satin finish, With magnet.

QA-1666

MAGNETIC OIL DRAIN PLIERS



- Total length... 285 mm(L)
- Magnet...
 - Dia. 17.9 mm × Thickness 3mm, Max. working temperature 120°C
- Magnet holder...
 - Angle 90°, material: steel, chrome plated, 22mm (W) × 13.5mm (H)
- Steel wire... 1/8" × 185mm
- Handle... plastic
- For removing drain plus on hot and dirty engine oil plugs and transmission plugs contact.
- Strong magnet sticks to plugs firmly.
- Also useful when picking up screws or nuts if fallen in engine compartment.

QA-2131

38PCS PROFESSIONAL OIL SERVICE KIT



- Kit includes useful tools when working on oil exchange services.
- Contents...
 - 1_ Magnetic oil drain plug
 - 1_ Pitch gauge
 - 4_ Tap P1.5, Size... M13, M15, M17, M20
 - 16_ Nut P1.5, Size... M13, M15, M17, M20
 - 16_ Washer P1.5, Size... M13, M15, M17, M20

NEW

QA-2132

47PCS PROFESSIONAL OIL SERVICE KIT



- Kit includes useful tools when working on oil exchange services.
- Contents...
 - 1_ Magnetic oil drain plug
 - 1_ Pitch gauge
 - 5_ Tap P1.5, Size... M11, M13, M15, M17, M20
 - 20_ Nut P1.5, Size... M11, M13, M15, M17, M20
 - 20_ Washer P1.5, Size... M11, M13, M15, M17, M20

NEW

QA-1664

RESIDUAL FLUID COLLECTOR

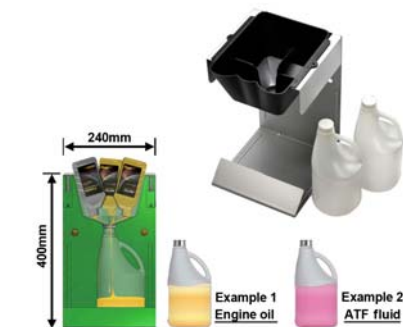

- Contents...
 - 2_ Steel Anchor (Hex 12mm × Anchor Length 56 mm)
 - 1_ 2 liter Bottle (126mm (L) × 257 mm (H), Nature color, Material... PE)
 - 1_ Funnel (400mm (L) × 190mm (W), Material... PP, 80 mesh filter (30 mm × 8mm (H), Material... Stainless)
 - 1_ Steel Case, Chrome plated, Thickness... 2mm, Funnel material... PP
- Set for collecting residual fluids in used bottles.
- Suitable for engine oil, ATF and gear oil.
- Includes two anchor bolts for screwing the collector on wall.
- Provided with two empty 2-liter bottle for storage.
- Collected oil can serve as lubricants for other car parts or household uses.

QA-1667

UNIVERSAL OIL FUNNEL SET



- Contents...
 - 1_ Universal funnel, Material... PP + PC
 - 1_ Clamp, Material... Nylon + Stainless
- Set for refilling engine oil without unsafe spills.
- Clamp can be fitted to oil filler necks universally.
- Clamp application range... 28 - 74mm. (1.1" to 2.9")
- Lower transparent chamber shows oil flows down to engine.
- No need to hold the funnel with your hand when refilling the oil.

QA-1663

FLEXIBLE FUNNEL

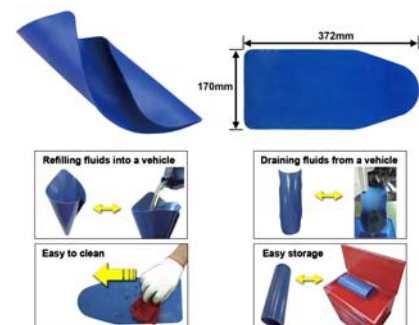

- Size... 372mm (L) × 170 mm (W)
- Inside material... Aluminum
- Outside plastic material... NBR
- Brings much convenience for mechanics.
- Can be rolled to be a funnel or simply folded as a drainer.
- Useful to refill or drain fluids such as engine oil, transmission fluid or coolant.
- Funnel has high temperature tolerance, ranging from -35 to 105°C.
- Easy storage and light to carry.

OG-200A

OIL SUCTION GUN 200 C.C.



- Capacity... 200 c.c.
- Finish... EBD (black)
- With 1pc flexible hose, 9.5"(240mm)
- Provides a fast, clean method of removing and adding transmission oil, gear oil, and vehicle fluids.

OG-500A

OIL SUCTION GUN 500 C.C.



- Capacity... 500 CC
- Finish... Electric plated
- With 1pc flexible hose, 11"(280mm)
- Provides a fast, clean method of removing and adding transmission oil, gear oil, and vehicle fluids.

QA-2431

DUAL OIL SUCTION GUN 500 C.C.



NEW

- Capacity... 500 CC
- With 2pcs flexible hose, 47"(120cm)
- With light weight aluminum tube construction.
- Provides a fast, clean method of removing and adding transmission oil, gear oil, and vehicle fluids.

QA-2430

OIL SUCTION GUN 1000 C.C.



NEW

- Capacity... 1000 CC
- With 1pc metallic bent spout, 9"(240mm)
- With 1pc flexible hose, 11"(280mm)
- Provides a fast, clean method of removing and adding transmission oil, gear oil, and vehicle fluids.

HOP-100

HAND ROTARY OIL PUMP



- Discharge quantity... 72 Turns / 20 Liters
- Material... Cast iron
- Contents...
 - 1_ Oil pump
 - 1_ Iron tube, Length... 1M
 - 1_ Hose, Length... 1.3M

QA-1434

MULTI POSITION PRY BAR



- Material... CR-V steel, Black finish
- Length... 10", 12", 15"
- Ideal for prying seals, bearings, manifolds, oil pans, axles, drive shafts, fuel injectors.
- Indexing head can adjust 14 fixed angles.
- Push design for quick release pry head and easy lock to fixed angles.

QA-1018

9 PCS HEAVY DUTY BODY PRY BAR SET



- Contents...
 - 5_ Double end spoon bar, S45C, HRC 38°-42°, Size... 290, 470, 600, 740, 880 mm
 - 2_ Offset spoon, S45C, HRC 38°-42°, Size... 320, 490 mm
 - 1_ T-sharp spoon, CR-V, HRC 38°-42°, Size... 140 mm
 - 1_ L-sharp spoon, CR-V, HRC 38°-42°, Size... 130 mm

QA-1019

HEAVY DUTY PRY BAR (30°)



- Blade material... SCM 440, HRC 42°-46°
- Blade width... 5/8" (15.8 mm)
- Total length... 36" (914.4 mm)
- PP + TPR Grip

QA-1020

HEAVY DUTY PRY BAR (FLAT)



- Blade material... SCM 440, HRC 42°-46°
- Blade width... 5/8" (15.8 mm)
- Total length... 36" (914.4 mm)
- PP + TPR Grip

QA-1021

HEAVY DUTY PRY BAR (90°)



- Blade material... SCM 440, HRC 42°-46°
- Blade width... 5/8" (15.8 mm)
- Total length... 24" (609.6 mm)
- PP + TPR Grip

QA-1022

HEAVY DUTY PRY BAR (45°)



- Blade material... SCM 440, HRC 42°-46°
- Blade width... 5/8" (15.8 mm)
- Total length... 24" (609.6 mm)
- PP + TPR Grip

QA-1024

HEAVY DUTY PRY BAR



- Blade material... SCM 440, HRC 42°-46°
- Blade width... 3/4" (19 mm)
- Total length... 60" (1524 mm)
- PP + TPR Grip
- Weight... 4.5 kg

QA-1023

4 PCS HEAVY DUTY PRY BAR SET



- Blade material... SCM 440, HRC 42°-46°, PP + TPR Grip
- Contents...
 - Flat blade, Width 5/8" (15.8mm), Total length 36" (914.4mm)
 - 30° blade, Width 5/8" (15.8mm), Total length 36" (914.4mm)
 - 45° blade, Width 5/8" (15.8mm), Total length 24" (609.6mm)
 - 90° blade, Width 5/8" (15.8mm), Total length 24" (609.6mm)

GP2-4E

GEAR PULLER - 2 JAW



Item no.	Size
• GP2-4E	4" (100mm)
• GP2-6E	6" (150mm)
• GP2-8E	8" (200mm)

GP3-4E

GEAR PULLER - 3 JAW



Item no.	Size
• GP3-4E	4" (100mm)
• GP3-6E	6" (150mm)
• GP3-10E	10" (250mm)
• GP3-12E	12" (300mm)
• Material...	S45C

GP3-3T

GEAR PULLER WITH 3 JAW



Item no.	Size
• GP3-3T	3" (75mm)
• GP3-4T	4" (100mm)
• GP3-6T	6" (150mm)
• GP3-8T	8" (200mm)
• GP3-12T	12" (300mm)

QA-1446

22" TWO JAWS GEAR PULLER



- Specification...
- Max. reach... 510 mm, Max. spread... 720 mm
- Forcing screw... SCM415 HRC 42°±3°
- Central nut... SCM415 HRC 42°±3°
- Twin Head... SCM415 HRC 42°±3°
- 2 pcs Jaw... 22"(L), SCM415 HRC 42°±3°
- Steel Plate 4 pcs
- Screw & Nut 4 pcs
- Sent Pop... Ø35mm × 45(L) mm, HRC 38°± 3°

QA-1447

25 TON TWO JAWS HYDRAULIC GEAR PULLER SET



- Specification...
- Max. reach... 510 mm, Max. spread... 720 mm
- Hydraulic ram... Ø58.6mm, SCM415
- Twin head... SCM415, HRC 42°±3°
- 2 pcs Jaw... 22"(L), SCM415, HRC 42°±3°
- Steel Plate 4 pcs, Screw & nut 4 pcs
- Sent pop... Ø35mm × 45(L) mm, HRC 38°± 3°
- Ram extension rod... Ø35× 100(L) mm, S45C, HRC 38°± 3°
- Ram extension rod... Ø35× 150(L) mm, S45C, HRC 38°± 3°

QA-1448

22" THREE JAWS GEAR PULLER



- Specification...
- Max. reach... 510 mm, Max. spread... 720 mm
- Forcing screw... SCM415, HRC 42°±3°
- Central nut... SCM415, HRC 42°±3°
- Triple head... Ductile
- 3 pcs Jaw... 22"(L), SCM415, HRC 42°±3°
- Steel Plate 6 pcs
- Screw & nut 6 pcs
- Sent pop... Ø35mm× 45(L) mm, S45C, HRC 38°± 3°

QA-1449

25 TON THREE JAWS HYDRAULIC GEAR PULLER



- Specification...
- Max. reach... 510 mm, Max. spread... 720 mm
- Hydraulic ram... Ø58.6mm, SCM415
- Triple head... Ductile
- 3 pcs Jaw... 22"(L), SCM415, HRC 42°±3°
- Steel Plate 6 pcs, Screw & nut 6 pcs
- Sent pop... Ø35mm × 45(L) mm, S45C, HRC 38°± 3°
- Ram extension rod... Ø35× 100(L) mm, S45C, HRC 38°± 3°
- Ram extension rod... Ø35× 150(L) mm, S45C, HRC 38°± 3°

QA-2163

QUICK-CHANGE BALL JOINT REMOVER



Quick change

NEW

- Innovative quick change and simple action for suitable fork.
- Enable operator to select correct jaw size without taking entire extractor to the vehicle.
- Adjustable opening angle.
- Jaw opening size... 20, 22, 24, 27, 30 mm
- Thrust Screw Length... 100 mm
- Pivot Rod Length... 125 mm

BS-022

BALL JOINT SEPARATOR(22mm)



NEW

- Jaw open... 22mm
- Offset lever permits max. jaw openings in 30mm (1-3/16") & 56mm (2-3/16")
- Special design 2stage operation suits most cars and light trucks ball joints in steering & suspension.
- Tempered drop forged steel body and offset lever provide an excellent performance and long usage.

QA-2354

HYDRAULIC BALL JOINT SEPARATOR



NEW

- Applying up to 8 tons of pressure on the ball joint.
- Jaw opening capacity... 56mm, Jaw width... 22mm
- Fork body material... SCM440 steel.
- Spindles maximum torque pressure... 40Nm



QA-2342

HEAVY DUTY TIE ROD AND BALL JOINT REMOVER



- Load capacity... 10 ton
- A universal heavy-duty puller that removes a wide range of tie rods and ball joints from a variety of cars, trucks, SUVs and heavy-duty vehicles.
- For a wider variety of applications and larger vehicles, jaws spread and reach are increased to 3 to 4 inches.
- The tool will also remove pitman arms and can be used in many pulling situations that require a 2 jaw puller on other vehicles types and machinery.
- Uses a large 3/4" center forcing screw with interchangeable tips included; cone, flat, and cup, for multiple applications.

QA-2344

HEAVY-DUTY BEARING CUP INSTALLER



- Quickly and easily installs bearing cups on bolt-retained universal joints.
- Fits series 1610 to 1880 and nearly all other heavy-duty truck and machine type u-joints with bolt-retained bearing cups.
- Automatically aligns bearing cups during installation.
- Eliminates the possibility of damage to the needle bearing.

QA-2345

AUTOMOTIVE YOKE PULLER

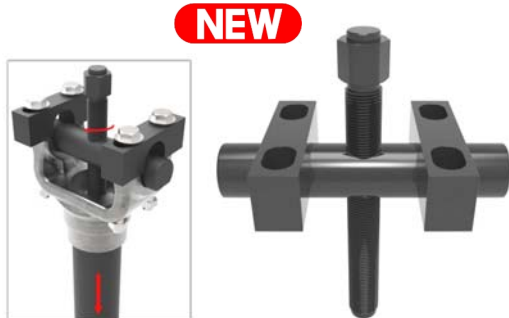

- Simplifies and expedites the removal of automotive yokes on drive shafts, transmissions and rear-end differentials without damage to the yokes.

QA-2346

INTERMEDIATE U-JOINT PULLER



- Can easily removes seized U-joint cups on intermediate trucks, buses and light industrial / farm equipment safely disassemble drivelines without hammering or heating components.
- Bearing cup outside diameter... 1.25" to 1.7 "
- Can be used with 1/2" Drive impact wrench.
- Doesn't damage the driveshaft, yokes, joints or bearing cups.

TRS-694

FRONT END SERVICE SET



- Contents...
 - 1_ Pitman arm puller, Opening 1-5/16"(33mm), Pull 2-1/2"(64mm)
 - 1_ Pitman arm puller, Opening 1-1/16"(27mm), Pull 1-3/4"(45mm)
 - 1_ Universal tie rod end tool, Fork 18mm(11/16")
 - 1_ Ball joint separator, Jaw open 22mm, Offset lever permits maximum jaw openings in 30mm (1-3/16") & 56mm (2-3/16")
 - 1_ Outer tie rod remover, Spread 2-1/2"(64mm), Reach 2-1/4"(57mm)

SHP-695

SLIDE HAMMER PULLER SET



- Slide Hammer with multiple attachments including...
 - Internal 3-Jaw puller
 - External 3-Jaw puller
 - Internal 2-Jaw puller
 - External 2-Jaw puller
 - Front hub puller
 - Rear axle puller
 - Grip wrench adapter
 - Dent puller
 - Puller hook

NEW

SHP-2495

SLIDE HAMMER PULLER SET



- Use to pull flange-type rear axles, stubborn oil seals & bearings, and other press fit parts.
- Slide Hammer with multiple attachments including...
 - Internal / External 3-Jaw puller, 3 different size
 - Internal / External 2-Jaw puller, 3 different size
 - Front hub puller
 - Rear axle puller
 - Grip wrench adapter
 - Dent puller
 - Puller hook

NEW

BP-01

BEARING REMOVER SET



- Major for bearing "Pulling & Inserting" usage.
- Hammer... 940g (2.15lb)
- Sliding hammer shaft length... 390mm
- Bearing size available... 8 to 32mm(5/16" to 1 1/4")
- Punch material... Carbon steel, HRC 43°±2°, Size... 8, 10, 12, 15, 17, 20, 25, 30 mm (5/16" to 1-1/4")

QA-1730

10PCS BLIND HOLE BEARING PULLER AND SLIDE HAMMER SET



- Set for pulling blind hole bearings off in an energy saving way.
- Includes a slide hammer and a puller.
- Provided with 8 adapters for major blind hole inner thread sizes, Material... SCM440 steel, HRC 46° - 48°
- Contents...
 - 1_ Slide hammer
 - 1_ Puller
 - 3_ Pin, Size... M6, M8, M10
 - 5_ Adapter, Size... 8 - 11, 12 - 17, 18 - 23, 24 - 29, 30 - 34mm

QA-1731

15PCS BLIND HOLE BEARING PULLER AND SLIDE HAMMER SET

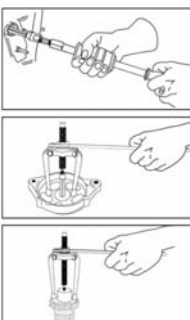

- Set for pulling blind hole bearings off in an energy saving way.
- Includes a slide hammer and a puller.
- Provided with 8 adapters for major blind hole inner thread sizes, Material...SCM440 steel, HRC 46° - 48°
- Contents...
 - 1_ Slide hammer
 - 1_ Puller
 - 3_ Pin, Size... M6, M8, M10
 - 10_ Adapter, Size... 8 - 11, 12 - 17, 18 - 23, 24 - 29, 30 - 34, 34 - 38, 39 - 43, 44 - 48, 49 - 53, 54 - 58 mm

QA-1450

LONG JAW BEARING PULLER



- Specification...
- Capacity... Spread 10 - 50mm
- Forcing screw... SCM435, HRC 42°±3°
- Stopper cone... S45C
- Connector... SCM415, HRC 42°±3°
- 2 pcs Jaw... 300(L)mm, SCM415, HRC42°±3°

QA-1451

INTERNAL BEARING FORCING SCREW PULLER SET



- Specification...
- Forcing screw... 5/8"-1.0P × 180(L)mm, SCM415, HRC 42°±3°
- Central bolt... 7/8" -14T × 60(L)mm, SCM415, HRC 42°±3°
- Twin head... SCM415, HRC42°±3°
- 2 pcs Leg... SCM415, HRC 42°±3°
- Rotated socket... SCM415, HRC 42°±3°
- Bearing Installer 1 pc
- Extractor... Spread Ø17-25mm, SCM415, HRC 42°±3°
- Extractor... Spread Ø25-32mm, SCM415, HRC 42°±3°

QA-1452

INTERNAL BEARING SLIDING PULLER SET



- Specification...
- Slide bar... 485(L)mm, S45C
- Hammer... 2.1 kg, S45C
- Extractor... Spread Ø17-25mm, SCM415, HRC 42°±3°
- Extractor... Spread Ø25-32mm, SCM415, HRC 42°±3°

QA-1453

INTERNAL & EXTERNAL SLIDING PULLER SET



- Specification...
- T-Bar... 5/8" -18T/inch × 425(L)mm, S45C
- Hammer... 1.2kg, S45C
- Internal puller spread... 15-30mm
- Internal puller spread... 30-80mm
- External puller spread... 15-80mm
- Stopper cone for internal puller 2 pcs, S45C
- Stopper cone for external puller, S45C
- Forcing screw 2 pcs, S45C
- Triple head 3 pcs
- Screw & nut 9 pcs

QA-1454

TWO WAYS BEARING PULLER SET



- Specification...
- Capacity... Internal 40 - 90mm, External 140 mm
- T-bar : 5/8" -18T/inch × 425(L) mm, S45C
- Hammer... 1.25 kgs, S45C
- Central bolt... 9/16"-20T, S45C, HRC 28°-32°
- Stopper cone... Aluminum
- Triple head... SCM415, HRC 42°±3°
- 3 pcs Jaw... SCM415, HRC 42°±3°

QA-1455

2" SPREAD JAW LOCK PULLER



- Specification...
- Capacity... Ø19 - 45mm
- Forcing screw... 7/16"-20T/inch × 123(L)mm, SCM415, HRC 42°±3°
- Socket... SCM415, HRC 42°±3°
- 3 pcs 3" Jaw... SCM415, HRC 42°±3°

QA-1456

4" SPREAD HYDRAULIC JAW LOCK PULLER



- Specification...
- Capacity... Ø60 - 100mm
- Hydraulic ram... Ø37.7mm, SCM420
- Socket... SCM415, HRC 42°±3°
- 3 pcs 6" Jaw... SCM415, HRC 42°±3°

QA-1457

5" SPREAD HYDRAULIC JAW LOCK PULLER



- Specification...
- Capacity... Ø70 - 120mm
- Hydraulic ram... Ø37.7mm, SCM420
- Socket... SCM415, HRC 42°±3°
- 3 pcs 8" Jaw... SCM415, HRC 42°±3°

QA-1458

MINI INTERNAL BEARING PULLER SET



- Specification...
- Beam... S45C
- 2 pcs Adjustable rod... S45C
- Central bolt... SCM440, HRC 40°-45°
- 2 pcs Edge screw
- 2 pcs Spacer screw
- Washer nut... S45C, HRC 30° - 35°
- Inner claw... 8 & 10 mm, SCM440, HRC 42°±3°
- Inner claw... 12 & 15 mm, SCM440, HRC 42°±3°

QA-1459

SIX WAYS MULTI PURPOSE HYDRAULIC GEAR PULLER



- Specification...
- Hydraulic ram... Ø37.7mm, SCM420
- Combination cross head... S45C, HRC 38°±3°
- Combination leg... SCM415, HRC 42°±3°
- Steel plate 6 pcs
- Screw, Nut, Washer 6 pcs
- Sent pop... Ø1" × 30mm(L), 50BV30, HRC40°±2°
- Ram extension rod... Ø1" × 2"(L), S45C, HRC38°±3°

QA-1465

30 MM BEARING SEPARATOR



- Specification...
- Bearing separator... Spread 10 - 30mm, SCM415, HRC 42°±3°
- Bolt... 1/4"-20T × 83mm(L), SCM415, HRC 42°±3°
- Hole size... 1/4" × 20T

QA-1466

50 MM BEARING SEPARATOR



- Specification...
- Bearing separator... Spread 30 - 50mm, SCM415, HRC 42°±3°
- Bolt... 3/8"-24T × 125mm(L), SCM415, HRC 42°±3°
- Hole size... 3/8" × 16T

QA-1467

75 MM BEARING SEPARATOR



- Specification...
- Bearing separator... Spread 50 - 75mm, SCM415, HRC 42°±3°
- Bolt... 1/2"-20T × 135mm(L), SCM415, HRC 42°±3°
- Hole size... 3/8" × 16T

QA-1468

100 MM BEARING SEPARATOR



- Specification...
- Bearing separator... Spread 75 - 105mm, SCM415, HRC 42°±3°
- Bolt... 5/8"-18T × 165mm(L), SCM415, HRC 42°±3°
- Hole size... 1/2" × 16T

QA-1469

150 MM BEARING SEPARATOR



- Specification...
- Bearing separator... Spread 105 - 150mm, SCM415, HRC 42°±3°
- Bolt... 3/4"-16T × 260mm(L), SCM415, HRC 42°±3°
- Hole size... 5/8" × 11T

QA-1470

200 MM BEARING SEPARATOR



- Specification...
- Bearing separator... Spread 150 - 200mm, SCM415, HRC 42°±3°
- Bolt... 1"-12T × 350mm(L), SCM415, HRC 42°±3°
- Hole size... 3/4" × 10T

QA-1460

MINI BEARING SEPARATOR ASSEMBLY



- Specification...
- Forcing screw... 1/4"-20T × 102mm(L), SCM415, HRC 42°±3°
- Beam
- 2 pcs main rod... Hex bar 8 × 85mm(L) × 1/4"-20T, S45C
- 2 pcs Extension rod... Hex bar 8 × 40mm(L) × 1/4"-20T, S45C
- Bearing separator... Spread 10 - 30mm, SCM415, HRC 42°±3°
- 2 pcs Jaw... 82mm(L), SCM415, HRC 42°±3°

BS-720

TWO SETS BEARING SEPARATOR KIT



- Bearing separator Capacity...
1-1/4" to 2-1/4" (30 × 50 mm) &
2-1/4" to 3-1/2" (50 × 75 mm) inside.
- Pullout the bearing with the H-type beam and bolts.

NEW

QA-1461

PRESSURE SCREW SEPARATOR PULLER SET



- Specification...
- Forcing screw... Ø18.65-10T × 292mm(L), S45C
- Central nut... S45C
- Beam... S45C
- 2 pcs main rod... Hex bar 19mm × 10"(L) × 1/2"-16T
- 2 pcs extension rod... Hex bar 19mm × 10"(L) × 1/2"-16T
- Bearing separator... Spread 75 - 105mm, SCM415, HRC 42°±3°

QA-1462

HYDRAULIC SEPARATOR PULLER SET



- Specification...
- Hydraulic ram... Ø37.7mm, SCM420
- Beam... S45C
- 2 pcs main rod... Hex bar 19mm × 10"(L) × 1/2"-T16
- 2 pcs extension rod... Hex bar 19mm × 10"(L) × 1/2"-T16
- Sent pop... Ø1" × 30mm(L), 50BV30, HRC 40°±2°
- Bearing separator... Spread 75 - 105mm, SCM415, HRC 42°±3°

QA-1463

HYDRAULIC GEAR PULLER SET



- Specification...
- Hydraulic ram... Ø37.7mm, SCM420
- Twin head, Triple head.
- Ram nut... SCM 415, HRC 42°±3°, Beam... S45C
- 4", 6", 8" Leg... SCM415, HRC 42°±3°, 9 pcs
- Sent pop... Ø1" × 30mm(L), 50BV30, HRC 40°±2°
- Ram extension rod... Ø1" × L2"/L4", S45C, HRC 38°±3°
- 2 pcs main rod... Hex bar 19mm × 10"(L) × 1/2"-16T
- 2 pcs extension rod... Hex bar 19mm × 10"(L) × 1/2"-16T
- Bearing separator... Spread 75 - 105mm, SCM415, HRC 42°±3°
- For agriculture machine, garage, industry use.

QA-1681

TIMING PULLEY PULLER

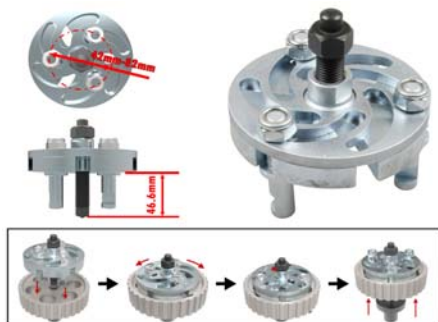

- This tool is designed for removing drive pulleys with face grooves.
- The tool removes a pulley absolutely free of any risk of damage.
- The tool is adaptable to different pulley diameters, as the legs are adjustable.
- For removing pulleys with 3, 6, 9 slots.
- Surface finish: chrome plated, screw blackened.

RPT-1401 **NEW** 14PCS RADIATOR PRESSURE TESTER KIT



- Testing radiators and radiator caps.
- Confirm the radiator & cooling systems leaking.
- Applies to most types of vehicles.
- Contents... 1_ Thermometer. 1_ Pressure testing pump with gauge (0 - 35 PSI). 12_ Radiator cap adapters

QA-2076 ULTRASONIC LEAK DETECTOR



- Ultrasonic leak detector utilizes ultrasonic sensor to check the air-tightness of pipeline.
- The instrument can identify the gas leakage of various pressure or vacuum system.
- The main application is the tightness test of any kinds, for example, doors, windows, plumbing, container, car windows, refrigerators ... etc.
- The operation is easy and accurate.
- Operating temperature... 0 to 40°C
- Operating humidity... < 80% RH
- Frequency responding...
Detector 40 ± 2kHz, Transmitter 40kHz
- Power... 9V battery × 2 (not included)

SS-15 COMBINATION ELECTRONIC STETHOSCOPE KIT



- Engine stethoscope... Use to locate & identify engine noise. Super sensitive microphone pick-up. Flexible non-conductive shaft. Cushioned headphones.
- Component stethoscope... Detect & isolate noisy components. Enables road test diagnosis. 4 channel sensor selector unit. 4 pick up sensors, 4.8m(L) cords

SS-18 ENGINE MECHANICS STETHOSCOPE



- The sensitivity more than traditional stethoscope.
- With ear-muff application, it's free from disturbing by outside noise.
- Flexible 9" shaft for hard to reach parts.

SS-16 MECHANIC'S STETHOSCOPE



- Sensitive instrument. Instrument is shockproof.
- Provides a fast and easy way to locate noises in engines, bearings, other moving parts.
- High quality surgical PVC & rubber parts for increased sound definition.
- Supplied with rubber trumpet for checking vacuum & pressure flow.

SS-58 STETHOSCOPE



- Sensitive instrument.
- Professional mechanic quality.
- Provides a fast and easy way to locate noises in engines or bearings and other moving parts.
- Plastic and rubber parts make the instrument shockproof.

TSE-7462 VOLTAGE TESTER WITH LCD & LED DISPLAY



- Voltage tester from 12 to 690V AC/DC by LCD display
- Voltage reading at 12, 24, 50, 120, 230, 400, and 690
- Rx LED for continuity test indication
- Polarity indication. Single pole phase test
- Phase rotation test with R/L LEDs displayed
- High voltage indication
- Power supply: 2 x AAA, 1.5V (not included)
- CE, GS, and ETL Approval

TSE-7460 VOLTAGE TESTER WITH LED DISPLAY



- AC and DC voltage test by 7stages LED displays
- Voltage reading at 12, 24, 50, 120, 230, 400, and 690
- Rx LED for continuity test indication
- Polarity indication. Single pole phase test
- Phase rotation test with R/L LEDs displayed
- High voltage indication
- Power supply: 2 x AAA, 1.5V (not included)
- CE, GS, and ETL approval

QA-2072 **NEW** MULTI FUNCTION AUTOMOBILE TESTER



- DC Voltage measurement... 0 - 70V
- Current measurement... 0 - 5A DC
- Resistance measurement... 0 - 200KΩ
- Frequency measurement... 0 - 300KHz (Square Wave)
- Temperature measurement...
Testing probe < 100°C / 212°F
Thermocouple (optional) < 200°C / 392°F
- Illumination, Testing power providing.
- Cable length... 2M
- Supply voltage... 8 - 30V DC
- Accessories...
Power Clips, Cigarette Lighter Plug, Auxiliary Ground Connector, Connector, Long Testing Probe, Wire Piercing Probe

QA-2073 **NEW** DIGITAL CIRCUIT TESTER KIT



- CE Approval. Check on 6, 12 and 48V systems.
- Voltage measurement range... 4 - 60V
- Small testing current... < 10mA
- Coil cord stretches to 12 feet.
- Digital display to read the accurate voltage value.
- LCD indication for power (Red) and ground (Green).
- Probes utilize standard 4mm banana jacks to ensure compatibility with most circuit testing equipment and meters.
- Accessories...
_ Piercing probe with banana socket
_ Insulated cable piercer probe with banana socket
_ Test probe with 4mm banana socket
_ Alligator clip (1pc, red color)

QA-2075 **NEW** RETRACTABLE CABLE & AUTOMOTIVE VOLTAGE TESTER



- Check on 6, 24 and 48V DC systems.
 - Maximum current... 10 AMPS(unwound), 6 AMPS(wound)
 - Banana plug wire long total... 6M(19.68ft)
 - Digital display to read accurate voltage value.
 - LED indication for Power (Red) and Ground (Green).
 - Set can be used with any multiple meter or device
 - Equipped with banana jack connectors and 2 pcs alligator.(black, red)
- Features...
- Used for testing electrical circuits in cars , trailer, boats.
 - Retractable cable reel assembly that has the cable reel which attaches to a midpoint of a cable and you can rotate it, winds both ends of the cable up on the cable reel.
 - Releasable detent arrangement is used to retain a desired amount of cable extending from the assembly.

QA-2074 **NEW** RETRACTABLE CABLE



Descriptions...

- Maximum current... 10 AMPS(unwound), 6 AMPS(wound)
- Banana plug wire long total... 6M(19.68ft)
- A retractable cable reel assembly that has the cable reel which attaches to a midpoint of a cable and you can rotate it, winds both ends of the cable up on the cable reel.
- A releasable detent arrangement is used to retain a desired amount of cable extending from the assembly.

Features...

- Used for testing electrical circuits in cars, trailers, boats and more.
- Set can be used with any multi meter or device equipped with banana jack connectors.

990531-01D

CIRCUIT TESTER FOR GENERAL & HYBRID CARS



- Compatible with current 12V system plus newer 42V system.
- Automatic voltage identification with blue for 12V and red for 42V system.
- Insulated shaft and heavy-duty alligator clips help prevent accidental shorts.
- New crystal-clear handle provides 360° visibility, even in bright light.

990531-01F

CAR LIGHT TESTER WITH ALLIGATOR CLIP



- Checks 6 to 24V AC
- Solid brass body with a test light
- Prod tip is covered brass protective screw cap
- 850mm cable with a alligator clip on the end
- With CE, RoHS approval

BH-101

BATTERY HYDROMETER



- Color code float for easy reading.
- Tests your own battery in seconds.

IT-001

INFRARED THERMOMETER

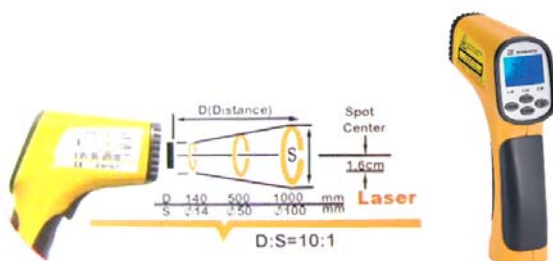

- Changeable between °C and °F. With LCD backlight
- Laser sign, Distance to spot ratio... 10:1
- Temperature range... -20 to 500°C
- Operating temperature... 0 to 50 °C
- Storage temperature... -20 to 50 °C
- Precision : $\pm 2.5\%$ °C or ± 3 °C
- Power... 9V (not included)

QA-1286

DOOR HINGE ADJUSTER



- Adjusts door hinge position on most vehicles.
- Works on either bolted or welded hinges.
- A two-headed pin adaptors allows adjustment on doors with both small and large latches.
- Overall length... 24"

QA-1287

DOOR HINGE ADJUSTER



- For easy and clean re-alignment of doors on passenger cars and commercial vehicles (height adjustment) as well as tailgates on hatchback vehicles (adjustment of door gap-width)
- Aligning rod made of special steel.
- Aligning rod with 3 pins, stored in the rod's handle.
- Pin size... Ø19 mm, Ø12 mm, Ø9.3 mm

QA-1288

DOOR JAMMER



- Holds door open while you hammer, pull, grind, sand or paint.
- For door and deck lids.
- Fits any size latch.

QA-2280

DOOR ALIGNING BAR



- Finally, a convenient door aligning tool.
- Uses your breaker bar for leverage.
- Saves space, fits easily into your tool drawer.
- Save time, you won't have to hunt for the shop tool.

QA-2282

DOOR PIN REMOVING TOOL



- 370mm long.
- For assembly of heavy finish door pins (16mm).
- This tool guarantees a quick and secure assembly of car doors.
- With 1 pin, Size... Ø5.0×125(L)mm

QA-2283

DOOR PIN REMOVING TOOL

NEW



- 370mm long.
- For assembly of heavy finish door pins (16mm).
- This tool guarantees a quick and secure assembly of car doors.
- With 4 Pins, Size...
Length 110mm, Ø3.0, 5.0, 5.5 mm
Length 125mm, Ø5.0 mm

QA-2274

DOOR SPRING PLIERS

NEW



- For installing and removing the stop spring of the window crank.
- Surface chrome-plated, jaws burnished.

QA-2275

WINDSHIELD MOLDING & DOOR HANDLE CLIP PLIER

NEW



- For removing most windshield molding clips and door handle clips.
- Releases clips to remove chrome molding on most windshield and rear glass.
- Offset handle permits easy access to molding clips.
- Clips under door handle without damage to panel material.

HRS-131

DOOR WEATHER STRIP MOLDING REMOVER



- Made by special steel to remove the molding easily.
- Suitable for replacing the rubber tap before spray paint work.
- Also suit to use on the door weather strip without gripping.

QA-2281

WINDOW BELT MOLDING REMOVER

NEW



- Quickly removes all window belt moldings.
- Slide the powder-coated tool downward between the window exterior and the door.
- The channel side of the tool should face the door.
- When the tool channel is below the belt molding, push or pull the tool upward.
- The tool quickly removes the belt molding without damage to the window or the molding.

QA-1088

SMALL TRIM AND BODY HAMMER

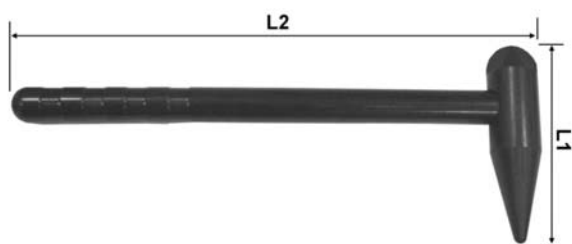

- Material... P.O.M.
- Size...
R... 15.5 mm, L1... 120 mm, L2... 316 mm

QA-1089

LARGE TRIM AND BODY HAMMER

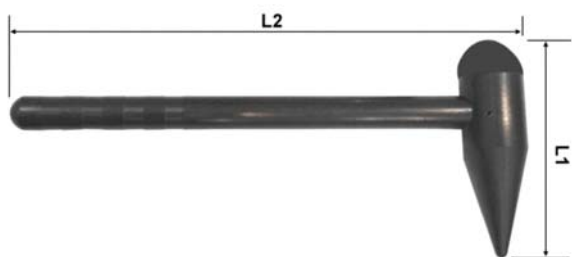

- Material... P.O.M.
- Size...
R... 20.3 mm, L1... 136 mm, L2... 318.5 mm

QA-1090

BODY REPAIR

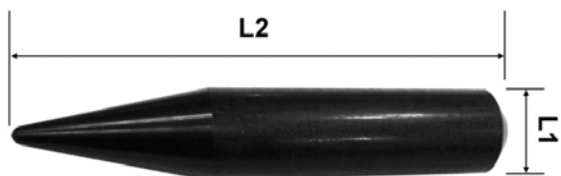

- Material... P.O.M.
- Size...
L1... 25 mm, L2... 140 mm

QA-2279

TRIM REMOVAL WEDGE (VAG GROUP)

- Used to remove various trim parts on the vehicle without damaging the parts.

NEW



QA-1086

3 PCS TRIM REMOVAL WEDGE SET



- Material... P.O.M.
- Size(Width)... 22, 30, 60 mm
- For plastic upholstery fastener and without damage on interior panel.

QA-2278

4 PCS UTILITY WEDGE SET



NEW

- Used to remove various trim parts on the vehicle without damaging the parts.
- Contents...
 - 1_ Trim removal wedge (VGA group)
 - 3_ Utility wedge, Size... 22, 30, 60mm

QA-1087

5 PCS PLASTIC WEDGES SET



- Contents...

Combined wedge trims, Plastic wedge angled with cutout and pin, Plastic wedge with straight and angled tip, Plastic wedge with felt, Plastic wedge.
- Feature...

The wedges are particularly suitable for body work such as removing and installing trim strips, door trims, door clips etc.

QA-2277

5 PCS PLASTIC WEDGES SET



NEW

- The five plastic wedges are particularly suitable for body work such as removing and installing trim strips, door trims, door clips etc.
- Contents...
 - 1_ Plastic wedge, Size...200×30×25mm
 - 1_ Combined wedge trims, Size... 210mm
 - 1_ Plastic wedge with felt, Size...250×19×25mm
 - 1_ Plastic wedge with straight and angled tip, Size...250×20×10mm
 - 1_ Utility Wedge. Size...60mm

HRS-101

TRIM PIN REMOVER



- V shape.
- Stainless steel blade.
- Bi - material grip.

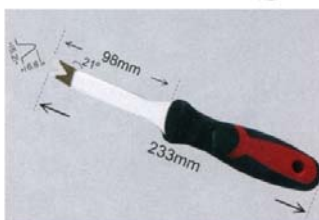

HRS-102

TRIM PIN REMOVER



- U shape.
- Stainless steel blade.
- Bi - material grip.

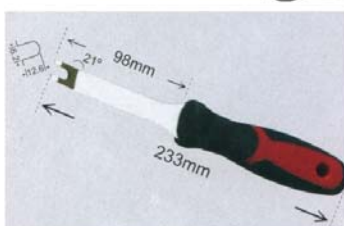

HRS-103

TRIM PIN REMOVER

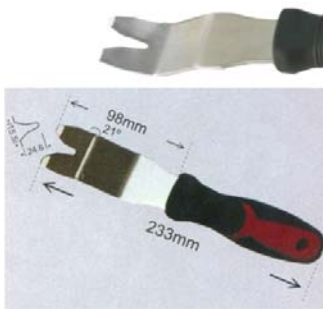

- V shape.
- Stainless steel blade.
- Bi - material grip.
- Small panel clip tool.

HRS-104

TRIM PIN REMOVER

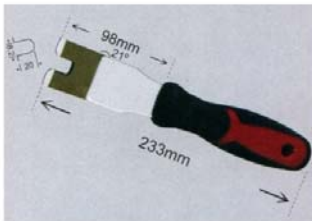

- U shape.
- Stainless steel blade.
- Bi - material grip.
- Heavy-duty, door clip tool.

HRS-105

TRIM PIN REMOVER

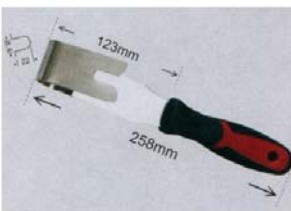

- Stainless steel blade
- Bi - material grip.
- Designed for tight access for door panel clips found on many GM and FORD cars.

QA-1290

4 PCS DOOR TRIM TOOL SET



- Contents...
Door panel remover-Square notch blade.
Door panel remover-V notch blade.
Door panel remover-Curved V notch blade.
Door panel window life remover.

HRS-3050

5 PCS TRIM PIN REMOVER SET



- Stainless steel blade.
- Bi - Material grip.
- Contents...
1_ " U " panel clip tool
1_ " V " panel clip tool
1_ Reverse door panel tool
1_ " U " heavy-duty door clip tool
1_ " V " small panel clip tool

QA-1289

6PC DOOR PANEL AND TRIM REMOVAL TOOL SET



- Blade material... Carbon steel, HRC 40° to 45°
- Handle material... PP+TPR
- Contents...
 - 1_ Narrow U-Shaped tip, Size... 9 3/8"(L) × 3/16"(W)
 - 1_ Tapered U-Shaped tip, Size... 9 3/8"(L) × 3/8"(W)
 - 1_ U-Shaped tip, Size... 9 3/8"(L) × 7/16"(W)
 - 1_ Narrow U-Shaped tip, Size... 19 3/4"(L) × 3/16"(W)
 - 1_ Tapered U-Shaped tip, Size... 19 3/4"(L) × 3/8"(W)
 - 1_ U-Shaped tip, Size... 19 3/4"(L) × 7/16"(W)

QA-1084

8 PCS PRY AND SCRAPER SET



- A full selection of pry tools are including in the form of seven different shapes.
- A great general-purpose kit with strong, all plastic tools that is geared towards interior installation, trim and mechanical repairs as well as vehicle detailing duties.
- A balance of flat and angled pry tools allows most clips, panels, or covers to be gently lifted while minimizing the likelihood of damage to the base materials.
- The perfectly shaped scraper for pushing and pulling gasket and other materials around difficult shapes like bolts and flanges.

QA-1085

5 PCS WIRE INSTALLER'S KIT



- Contents...
 - Small gauge wire tool, Wire soldering/case opener tool, Wire stuffing tool, Wire pulling tool, Micro case pry tool.
- Features...
 - Useful in all kinds of automotive, aerospace, marine and industrial environments these wire control tools allow the user to push, pull, and feed wires safer in hard to reach areas and panels.
- NOT WARRANTED FOR HIGH VOLTAGE USE

HRP-3100.

11 PCS REMOVER KIT



- Material... nylon
- Specially designed for the delicate task of removing small or fine fascia trim and bezels of dashboard fascia, door panels, trim strips and bezels, window installation, etc.
- Remover contents...
 - Panel, Angled clip panel, Flat clip panel, Sharp panel, Straight panel, Clip panel, Pull type, Handy type, Narrow type, Wide type, Upholstery clip.

HRP-3050

5 PCS HANDY REMOVER SET



- Material... nylon
- Contents...
 - 1_ Pull type remover
 - 1_ Handy remover
 - 1_ Narrow type remover
 - 1_ Wide type remover
 - 1_ Upholstery clip remover

HRP-3060

6 PCS MINI PANEL REMOVAL SET



- Material... nylon
- Contents...
- 1_ Angled clip panel remover
- 1_ Flat clip panel remover
- 1_ Panel remover
- 1_ Sharp panel remover
- 1_ Straight panel remover
- 1_ Clip panel remover

QA-2337

TRIM CLIP PLIERS



- This drop forged tapered "V" opening tool removes upholstery clips from car doors.
- Fits many different sizes of clips.
- Can also be used for a multitude of other jobs...
 - _ To remove trim pads & insulation.
 - _ To keep from breaking clips.
 - _ To remove the "tough" clips.

QA-2338

TRIM CLIP PLIERS (35 DEGREE OFFSET)



- To remove trim pads & insulation.
- To keep from breaking clips.
- To remove the "tough" clips.

QA-2339

TRIM CLIP PLIERS (80 DEGREE OFFSET)



- To remove trim pads & insulation.
- To keep from breaking clips.
- To remove the "tough" clips.

QA-1296

WINDSHIELD WIPER ARM REMOVER



- Tool removes wiper arms for most of the vehicles.
- Protective pad on bottom jaw will not scratch painted surfaces.
- Place jaws between wiper arm and shaft and squeeze handles to remove.

WRT-205 WINDSHIELD REMOVAL TOOL



- Cable action makes cutting out windshields fast and easy.
- A strong tempered steel blade, sharpened to a fine cutting edge, with a large durable aluminum handle, combined with a steel cable pull handle assures the easiest and fastest way of cutting the caulking compound around the windshield.

WRT-388 WINDSHIELD REMOVAL TOOL



- Tool includes 2pcs extra blades for replacement and the large handle provides storage function.
- Cable action makes cutting out windshields fast and easy.
- The easiest and most proven method of removing windshield.

QA-1103 WIRE STARTER

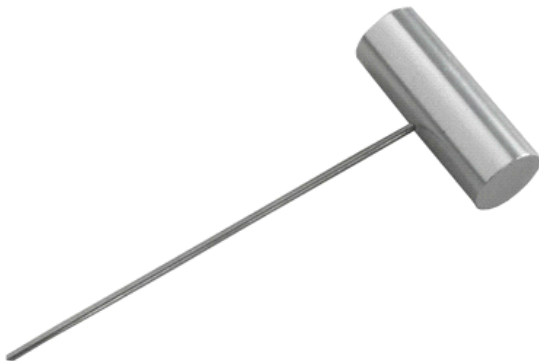

- To use wire starter just push the hollow stainless steel tube through the urethane, insert the wire through the, pull wire starter out and your wire is in.
- Be sure to lay the flat side of the aluminum handle against the glass and then use your thumb or fingers to push the tube through the urethane.

QA-1104 WINDSHIELD WEATHER STRIP CUTTING KNIFE



- Size... 24"
- Made of aluminum with a steel-retaining block for the blade.
- Allows the user to reach the corners of the windshield easily.
- A short screw can secure the blade tightly without stripping the screw.
- An unique design that allows you to store an extra blade in the handle. (It is not included)

QA-1105 WIRE GUIDE



- The wire guide's long, narrow shaft protects the dash and interior moldings from being damaged run the wire through the hole at the end of the tool.

QA-1109 WIRE GRIPPING HANDLES



- With quick wire release
- Feed the wire through the hole in the wedge shaft.
- Loop it through the hole at the top of the shaft and then back into the handle.
- By pressing the wedge back into the handle the wire is held in place.
- The wire gripping handles special design keeps the wire away from your fingers at any angle.

QA-1110 TIGHT-WIRE GRIPS WINDSHIELD REMOVER



- Tight-wire grips let you get handle on a tough job pulling windshield wire.
- Aluminum handles and stainless windshield wire.
- Release the screw at the midpoint and insert the wire end tighten the screw.
- The wire is now securely bound at each end, able to resist strong tugging.

QA-1111 4 PCS WINDSHIELD REMOVAL KIT



- Contents...
 - 1_ Wire feeder tool, Length... 205mm
 - 2_ Wire Gripping Handles
 - 1_ 72 feet stainless steel square Wire

QA-1112 WINDOWSHIELD REMOVING TOOL KIT



- Contents...
 - 2_ Wire aluminum grip handle.
 - 1_ Wire insert tool.
 - 1_ Stainless square wire 50M.

QA-1121 TRIANGLE WIRE



- Size... 0.7mm × 50 meters
- Materia... Stainless #304
- Ideal tool for removal the vinyl adhesive compound around windshield.

QA-1106 WINDSHIELD MOLDING REMOVER



- It is used to remove trim moldings from around cemented windshields and rear windows.
- Tool works in either direction, so there is no need to turn it end for end or change tool.
- Removes moldings in a fraction of the time required with any other tools.

WRT-260 WINDSHIELD REMOVAL KIT



- Contents...
 - 1_ Stainless steel wire
 - 2_ Wire gripping handles
 - 1_ Windshield removal tool
 - 1_ Wire feeder tool
 - 1_ Trim pad remover
 - 1_ Windshield molding release tool

QA-1114

14 pcs GLASS & WINDSHIELD REMOVAL TOOL KIT



- Contents...
- 2_ Weather Strip Cutting Knife, Size... 12", 24"
- 3_ Pinchweld Scraper replaceable blade, Width... 3/4", 5/8", 1/2"
- 1_ Wide Pinchweld Scraper
- 1_ 72 feet Triangle Wire
- 2_ Wire Gripping Handles
- 1_ Windshield Removal Tool
- 1_ Hexagonal Head Wrench
- 1_ Wire Feeder Tool
- 1_ Trim Pad Remover
- 1_ Windshield Molding Release Tool

QA-1115

WINDSHIELD INSTALLATION KIT

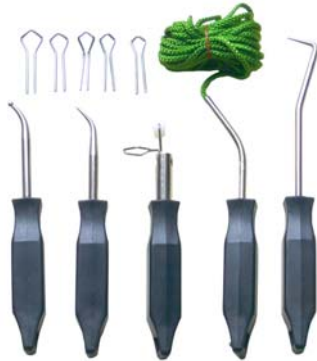

- Contents...
- _ Rope Insert Tool
- _ Assort Tip For Insert tool
- _ Curved Hook Tool
- _ Straight Hook Tool
- _ Cleaning Tool

QA-1116

WEATHER STRIPPING TOOL



- This tool provides a fast and efficient way to lift rubber weather stripping up around auto windows.

QA-1117

WINDSHIELD LOCKING STRIP TOOL



- Two double-ended tips to fit most of car.
- Unique design allows tip to swivel 90° in either direction to work where others won't.
- Replacement tips all including.